



BALL VALVES



GIACOMINI
WATER E-MOTION

Technical documentation

0893EN

TECHNICAL FEATURES

USE

Giacomini ball valves are designed to provide high mechanical resistance minimizing the required space and guarantee operation with very high working pressures. The Finishings used are suitable for hot and cold water systems, domestic water, gases, hydrocarbons, compressed air and dry saturated vapor. The inner anti-tampering stem assembly makes it suitable for use on indoor and outdoor gas distribution lines. The wide range of products provides the right solution for any need.

STANDARD PORT AND FULL PORT

Standard port ball valves feature a port free section not lesser than 75 % of the pipe on which they should be assembled. Full port ball valves instead provide a port free section corresponding to the pipe.

Pipe DN	8	10	15	20	25	32	40	50	65	75	100
Standard port DN	8	10	14	18	22	28	35	45	58	68	90
Full port DN	8	10	15	20	25	32	40	50	65	75	100

BALL VALVES THREADS

PRESSURE-TIGHT THREADS

Reference standard	Threads features	Nomenclature		Recommended coupling between threads
		Male thread	Female thread	
EN 10226-1 (FORMER ISO 7)	Pressure-tight threads coupling, characterized by conical Male and parallel Female	R (size) i.e. R 3/4"	Rp (size) i.e. Rp 3/4"	Male R with Female Rp or Rc
EN 10226-2 (FORMER ISO 7)	Pressure-tight threads coupling, characterized by conical Male and Female	R (size) i.e. R 3/4"	Rc* (size) i.e. Rc 3/4"	

* "BSP": indication of common use

NOT PRESSURE-TIGHT THREADS

Reference standard	Threads features	Nomenclature		Recommended coupling between threads
		Male thread	Female thread	
ISO 228	Not pressure-tight threads coupling, characterized by parallel Male and Female	G (size)M i.e. G 3/4"M	G (size)F i.e. G 3/4"F	Male G with Female G
ASME B1.20.1	Not pressure-tight threads coupling, characterized by conical Male and Female	(size)NPT-M i.e. 3/4"NPT-M	(size)NPT-F i.e. 3/4"NPT-F	Male NPT with Female NPT

BALL VALVES MAIN COMPONENTS

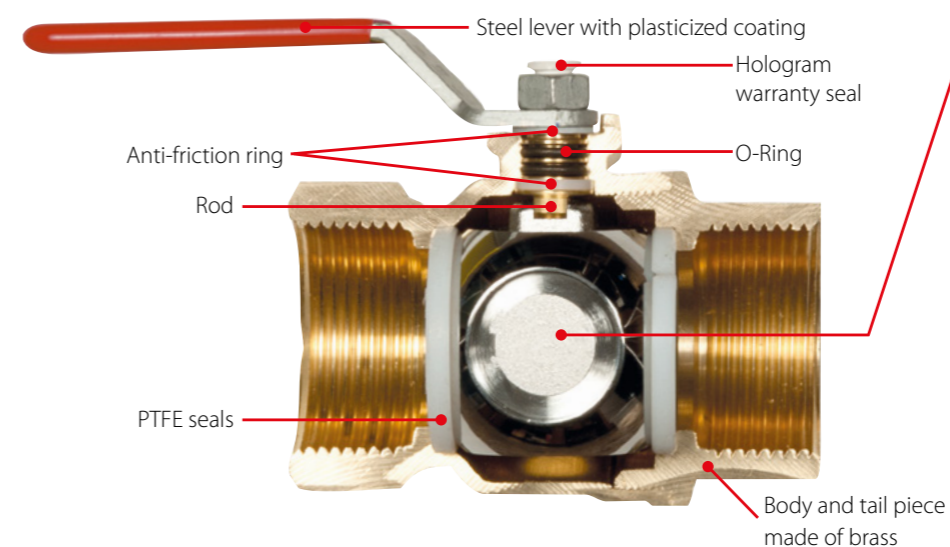

DADO ball

DADO balls are an exclusive design by Giacomini revolutionizing the world of ball valves. Their "cubic" shape enable to remove impurities from the seal seat, preventing damages to gaskets during opening and closing. The flow impurities settle on the ball flat face and are then removed from the fluid current. The limited contact between the ball and the seal seats reduces friction between the components and the valve maneuvering torque is thus lesser than 15/20 % compared to the one required by a traditional ball. The combination of these factors extends the useful life of PTFE gaskets.

1 TECHNICAL FEATURES

2 CERTIFICATIONS - QUALITY

3 EN / ISO STANDARD ISO 228, EN 10226 (FORMER ISO 7) THREADS

4 ► Valves for water for heating/cooling systems

- Valves with threaded connections
- Valves with compression connections
- Valves with sweat connections
- Valves MINI series

32 ► Valves for dangerous gas

- Valves with threaded connections

40 ► Valves specific for domestic water use

- Valves with threaded connections
- Valves with press connections

53 ASTM / ASME STANDARD AND COMPRESSION CONNECTIONS NPT, ASME B1.20.1 THREADS

54 ► Valves for water for heating/cooling systems, dangerous and not dangerous gas, liquid hydrocarbons

- Valves with threaded connections
- Valves with compression connections

59 BALL COCKS

60 ► Cocks for water for heating/cooling systems

64 ► Under-sink and washing machine cocks

65 ► Hose Bibs

67 ACCESSORIES

QUALITY

The first company's Quality Management System ISO 9002 was certified in 1986 and was extended to ISO 9001 (the actual UNI EN ISO 9001:2008) in 1996. Subsequently, the Environmental Management System UNI EN ISO 14001:2004 of the company's manufacturing sites and goods export procedure were quality certified. Finally, the Occupational Health and Safety System is being certified to BS OHSAS 18001:2007. The next internal goal is to achieve the most recent energy and ethics certification.



Brass raw material in bars

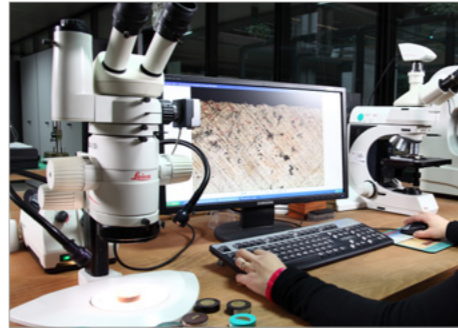

Laboratory testing



Automatic assembly with 100% in-line tests'

CERTIFICATIONS

Certification	Description	Country	Certification	Description	Country
	CE Marking in compliance with PED and/or CPR (Construction Product Regulation)	European Community		Turkish standards institution	Turkey
	Attestation de conformité sanitaire	France		Certification in compliance with Ukrainian standards	Ukraine
	CERTgaz	France		Certification in compliance with Belorussian standards	Belarus
	DVGW Deutscher Verein des Gas-und Wasserfaches	Germany		EAC compliance certificate (Custom Union Certificate)	Russia Belarus Kazakistan
	WRAS Water Regulations Advisory Scheme	UK		CSA International Canadian Standard Association	Canada
	SVGW Schweizerischer Verein des Gas-und Wasserfaches	Switzerland		UL Underwriters Laboratories	USA
	OVGW Österreichische Vereinigung für das Gas-und Wasserfach	Austria		FM Approvals	USA
	EMI Építésügyi Mimoségellenőrző Innovációs	Hungary		NSF International	USA

Information concerning certifications, compliance and homologations included in this catalogue are for reference only, subject to regular updating and may refer only to specific product dimensions.

Giacomini S.p.A. may not be held liable, implicitly or explicitly, for obsolete, incomplete or irrelevant information.

In case of missing or unclear information, please contact Giacomini technical support.

Giacomini S.p.A. reserves the right to change the products and related technical information at any time without notice.



EN / ISO STANDARD

ISO 228, EN 10226 (FORMER ISO 7) THREADS

Valves for water for heating/cooling systems

- Valves with threaded connections
- Valves with compression connections
- Valves with sweat connections
- Valves MINI series

RED HANDLE

Valves for dangerous gas

- Valves with threaded connections

YELLOW HANDLE

Valves specific for domestic water use

- Valves with threaded connections
- Valves with press connections

GREEN HANDLE

VALVES FOR WATER FOR HEATING/COOLING SYSTEMS

> R950



DADO ball valve, with female-female threaded connections, heavy series.
Full port.
Min. working temperature: -20 °C with 50 % glycol solutions
Max. working temperature with dry saturated steam: 185 °C with 1,05 MPa (10,5 bar)
Max. working pressure at 20 °C with water and not dangerous gas: 4,2 MPa (42 bar) for 1/4", 3/8", 1/2", 3/4"
3,5 MPa (35 bar) for 1", 1-1/4", 1-1/2", 2"

Temperature range with liquid hydrocarbons*: -20÷60 °C
Max. working pressure at 20 °C with liquid hydrocarbons*: 1,2 MPa (12 bar)

*Please consult Giacomini technical support, to check the compatibility of the product with the specific hydrocarbon.

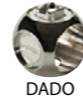

DADO

Product code	Connections	Finishing	Handle type	Handle color	Notes
R950X021	G 1/4"F x G 1/4"F	Nickel plated brass	Lever	Red	DADO ball
R950X022	G 3/8"F x G 3/8"F	Nickel plated brass	Large lever	Red	DADO ball
R950X023	G 1/2"F x G 1/2"F	Nickel plated brass	Large lever	Red	DADO ball
R950X024	G 3/4"F x G 3/4"F	Nickel plated brass	Large lever	Red	DADO ball
R950X025	G 1"F x G 1"F	Nickel plated brass	Large lever	Red	DADO ball
R950X026	G 1-1/4"F x G 1-1/4"F	Nickel plated brass	Large lever	Red	DADO ball
R950X027	G 1-1/2"F x G 1-1/2"F	Nickel plated brass	Large lever	Red	DADO ball
R950X028	G 2"F x G 2"F	Nickel plated brass	Large lever	Red	DADO ball

Product code	DN	A [mm]	I [mm]	B [mm]	J [mm]	C [mm]	H [mm]	Kv
R950X021	8	43	21	36	10	43	wr.17	6,9
R950X022	10	49	25	47	13	77	wr.21	7,0
R950X023	15	60	30	53	16	77	wr.26	13,3
R950X024	20	68	34	69	21	95	wr.32	25,8
R950X025	25	81	41	77	25	95	wr.41	50,9
R950X026	32	95	48	87	30	95	wr.50	103
R950X027	40	104	52	107	36	137	wr.55	147
R950X028	50	126	63	122	44	137	wr.70	222

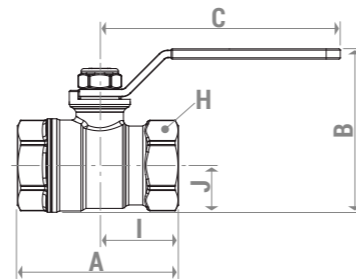

> R951



DADO ball valve, with female-female threaded connections, heavy series.
Full port.
Min. working temperature: -20 °C with 50 % glycol solutions
Max. working temperature with dry saturated steam: 185 °C with 1,05 MPa (10,5 bar)
Max. working pressure at 20 °C with water and not dangerous gas: 4,2 MPa (42 bar) for 1/4", 3/8", 1/2", 3/4"
3,5 MPa (35 bar) for 1", 1-1/4"

Temperature range with liquid hydrocarbons*: -20÷60 °C
Max. working pressure at 20 °C with liquid hydrocarbons*: 1,2 MPa (12 bar)

*Please consult Giacomini technical support, to check the compatibility of the product with the specific hydrocarbon.

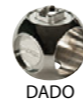

DADO

Product code	Connections	Finishing	Handle type	Handle color	Notes
R951X021	G 1/4"F x G 1/4"F	Nickel plated brass	T-handle	Red	DADO ball
R951X022	G 3/8"F x G 3/8"F	Nickel plated brass	T-handle	Red	DADO ball
R951X023	G 1/2"F x G 1/2"F	Nickel plated brass	T-handle	Red	DADO ball
R951X024	G 3/4"F x G 3/4"F	Nickel plated brass	T-handle	Red	DADO ball
R951X025	G 1"F x G 1"F	Nickel plated brass	T-handle	Red	DADO ball
R951X026	G 1-1/4"F x G 1-1/4"F	Nickel plated brass	T-handle	Red	DADO ball

Product code	DN	A [mm]	I [mm]	B [mm]	J [mm]	C [mm]	H [mm]	Kv
R951X021	8	43	21	36	10	42	wr.17	6,9
R951X022	10	49	25	47	13	63	wr.21	7,0
R951X023	15	60	30	53	16	63	wr.26	13,3
R951X024	20	68	34	69	21	77	wr.32	25,8
R951X025	25	81	41	77	25	77	wr.41	50,9
R951X026	32	95	48	87	30	77	wr.50	103

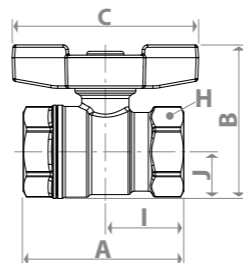

> R910



DADO ball valve, with female-female threaded connections.
Full port.
Min. working temperature: -20 °C with 50 % glycol solutions
Max. working temperature with dry saturated steam: 185 °C with 1,05 MPa (10,5 bar)
Max. working pressure at 20 °C with water and not dangerous gas: 4,2 MPa (42 bar) for 3/8", 1/2", 3/4"
3,5 MPa (35 bar) for 1", 1-1/4", 1-1/2", 2"
2,8 MPa (28 bar) for 2-1/2", 3", 4"

Temperature range with liquid hydrocarbons*: -20÷60 °C
Max. working pressure at 20 °C with liquid hydrocarbons*: 1,2 MPa (12 bar)

*Please consult Giacomini technical support, to check the compatibility of the product with the specific hydrocarbon.

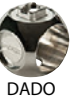

DADO

Product code	Connections	Finishing	Handle type	Handle color	Notes
R910X022	G 3/8"F x G 3/8"F	Nickel plated brass	Large lever	Red	DADO ball
R910X023	G 1/2"F x G 1/2"F	Nickel plated brass	Large lever	Red	DADO ball
R910X024	G 3/4"F x G 3/4"F	Nickel plated brass	Large lever	Red	DADO ball
R910X025	G 1"F x G 1"F	Nickel plated brass	Large lever	Red	DADO ball
R910X026	G 1-1/4"F x G 1-1/4"F	Nickel plated brass	Large lever	Red	DADO ball
R910X027	G 1-1/2"F x G 1-1/2"F	Nickel plated brass	Large lever	Red	DADO ball
R910X028	G 2"F x G 2"F	Nickel plated brass	Large lever	Red	DADO ball
R910X029	G 2-1/2"F x G 2-1/2"F	Nickel plated brass	Lever	Red	DADO ball
R910X030	G 3"F x G 3"F	Nickel plated brass	Lever	Red	DADO ball
R910X031	G 4"F x G 4"F	Nickel plated brass	Lever	Red	DADO ball

Product code	DN	A [mm]	I [mm]	B [mm]	J [mm]	C [mm]	H [mm]	Kv
R910X022	10	50	25	47	13	77	wr.21	7,0
R910X023	15	57	28	53	16	77	wr.25	13,3
R910X024	20	62	31	70	21	95	wr.32	25,8
R910X025	25	76	38	78	25	95	wr.39	50,9
R910X026	32	86	43	88	30	95	wr.47	103
R910X027	40	97	48	109	37	137	wr.54	147
R910X028	50	111	55	125	46	137	wr.67	222
R910X029	65	153	76	170	58	187	wr.82	336
R910X030	80	173	87	189	68	187	wr.96	377
R910X031	100	217	108	242	88	257	wr.126	645

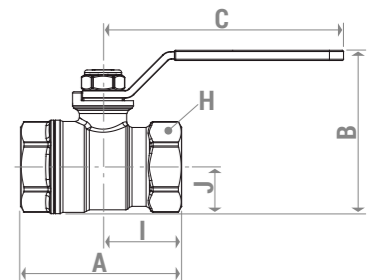

> R910S



DADO ball valve, with female-female threaded connections, with drain cock with hose connection Ø 9 mm.
Full port.
Temperature range: -20÷120 °C (-20 °C with 50 % glycol solutions)
Max. working pressure at 20 °C with water: 4,2 MPa (42 bar) for 1/2", 3/4"
3,5 MPa (35 bar) for 1", 1-1/4", 1-1/2", 2"



Product code	Connections	Drain cock size	Finishing	Handle type	Handle color	Notes
R910SX003	G 1/2"F x G 1/2"F	1/4"	Nickel plated brass	Large lever	Red	DADO ball, with drain cock
R910SX004	G 3/4"F x G 3/4"F	1/4"	Nickel plated brass	Large lever	Red	DADO ball, with drain cock
R910SX005	G 1"F x G 1"F	1/4"	Nickel plated brass	Large lever	Red	DADO ball, with drain cock
R910SX006	G 1-1/4"F x G 1-1/4"F	3/8"	Nickel plated brass	Large lever	Red	DADO ball, with drain cock
R910SX007	G 1-1/2"F x G 1-1/2"F	3/8"	Nickel plated brass	Large lever	Red	DADO ball, with drain cock
R910SX008	G 2"F x G 2"F	3/8"	Nickel plated brass	Large lever	Red	DADO ball, with drain cock

Product code	DN	A [mm]	I [mm]	B [mm]	J [mm]	C [mm]	H [mm]	Kv
R910SX003	15	62	34	52	16	77	wr.25	13,3
R910SX004	20	68	37	69	21	95	wr.32	25,8
R910SX005	25	82	44	77	25	95	wr.39	50,9
R910SX006	32	100	57	87	30	95	wr.47	103
R910SX007	40	110	62	108	37	137	wr.54	147
R910SX008	50	125	69	124	46	137	wr.67	222

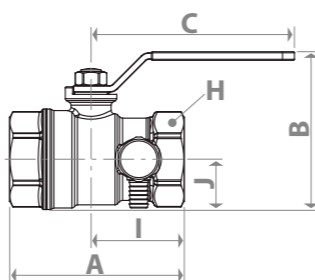

> R911



DADO ball valve, with female-female threaded connections.
Full port.
Min. working temperature: -20 °C with 50 % glycol solutions
Max. working temperature with dry saturated steam: 185 °C with 1,05 MPa (10,5 bar)
Max. working pressure at 20 °C with water and not dangerous gas: 4,2 MPa (42 bar) for 3/8", 1/2", 3/4"
3,5 MPa (35 bar) for 1", 1-1/4"
Temperature range with liquid hydrocarbons*: -20÷60 °C
Max. working pressure at 20 °C with liquid hydrocarbons*: 1,2 MPa (12 bar)



Product code	Connections	Finishing	Handle type	Handle color	Notes
R911X022	G 3/8"F x G 3/8"F	Nickel plated brass	T-handle	Red	DADO ball
R911X023	G 1/2"F x G 1/2"F	Nickel plated brass	T-handle	Red	DADO ball
R911X024	G 3/4"F x G 3/4"F	Nickel plated brass	T-handle	Red	DADO ball
R911X025	G 1"F x G 1"F	Nickel plated brass	T-handle	Red	DADO ball
R911X026	G 1-1/4"F x G 1-1/4"F	Nickel plated brass	T-handle	Red	DADO ball

Product code	DN	A [mm]	I [mm]	B [mm]	J [mm]	C [mm]	H [mm]	Kv
R911X022	10	49	25	48	13	63	wr.21	7,0
R911X023	15	56	28	56	16	63	wr.25	13,3
R911X024	20	62	31	64	21	73	wr.32	25,8
R911X025	25	76	38	72	25	73	wr.39	50,9
R911X026	32	86	43	82	30	73	wr.47	103

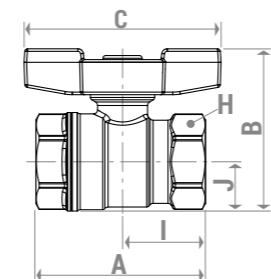

> R913

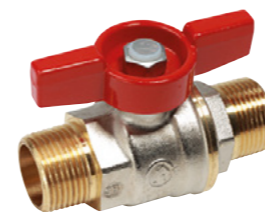

DADO ball valve, with male-male threaded connections.
Full port.
Min. working temperature: -20 °C with 50 % glycol solutions
Max. working temperature with dry saturated steam: 185 °C with 1,05 MPa (10,5 bar)
Max. working pressure at 20 °C with water and not dangerous gas: 4,2 MPa (42 bar) for 3/8", 1/2", 3/4"
3,5 MPa (35 bar) for 1", 1-1/4"
Temperature range with liquid hydrocarbons*: -20÷60 °C
Max. working pressure at 20 °C with liquid hydrocarbons*: 1,2 MPa (12 bar)



Product code	Connections	Finishing	Handle type	Handle color	Notes
R913X022	R 3/8" x R 3/8"	Nickel plated brass	T-handle	Red	DADO ball
R913X023	R 1/2" x R 1/2"	Nickel plated brass	T-handle	Red	DADO ball
R913X024	R 3/4" x R 3/4"	Nickel plated brass	T-handle	Red	DADO ball
R913X025	R 1" x R 1"	Nickel plated brass	T-handle	Red	DADO ball
R913X026	R 1-1/4" x R 1-1/4"	Nickel plated brass	T-handle	Red	DADO ball

Product code	DN	A [mm]	I [mm]	B [mm]	J [mm]	C [mm]	H [mm]	Kv
R913X022	10	63	28	49	13	63	wr.21	7,0
R913X023	15	74	34	55	17	63	wr.25	13,3
R913X024	20	82	38	64	21	73	wr.32	25,8
R913X025	25	93	44	73	25	73	wr.39	50,9
R913X026	32	108	50	82	30	73	wr.47	103

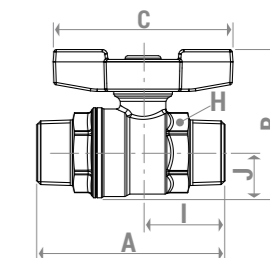

> R913L



DADO ball valve, with male-male threaded connections.
Full port.
Min. working temperature: -20 °C with 50 % glycol solutions
Max. working temperature with dry saturated steam: 185 °C with 1,05 MPa (10,5 bar)
Max. working pressure at 20 °C with water and not dangerous gas: 4,2 MPa (42 bar) for 3/8", 1/2", 3/4"
3,5 MPa (35 bar) for 1", 1-1/4"
Temperature range with liquid hydrocarbons*: -20÷60 °C
Max. working pressure at 20 °C with liquid hydrocarbons*: 1,2 MPa (12 bar)



Product code	Connections	Finishing	Handle type	Handle color	Notes
R913LX022	R 3/8" x R 3/8"	Nickel plated brass	Large lever	Red	DADO ball
R913LX023	R 1/2" x R 1/2"	Nickel plated brass	Large lever	Red	DADO ball
R913LX024	R 3/4" x R 3/4"	Nickel plated brass	Large lever	Red	DADO ball
R913LX025	R 1" x R 1"	Nickel plated brass	Large lever	Red	DADO ball
R913LX026	R 1-1/4" x R 1-1/4"	Nickel plated brass	Large lever	Red	DADO ball

Product code	DN	A [mm]	I [mm]	B [mm]	J [mm]	C [mm]	H [mm]	Kv
R913LX022	10	63	28	46	13	77	wr.21	7,0
R913LX023	15	73	34	52	16	77	wr.25	13,3
R913LX024	20	82	38	69	21	95	wr.32	25,8
R913LX025	25	92	44	77	25	95	wr.39	50,9
R913LX026	32	108	50	87	30	95	wr.47	103

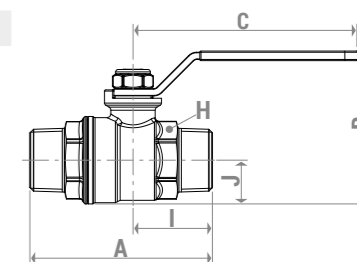

> R914

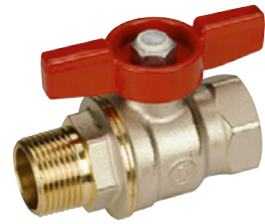

DADO ball valve, with female-male threaded connections.
 Full port.
 Min. working temperature: -20 °C with 50 % glycol solutions
 Max. working temperature with dry saturated steam: 185 °C with 1,05 MPa (10,5 bar)
 Max. working pressure at 20 °C with water and not dangerous gas: 4,2 MPa (42 bar) for 1/4", 3/8", 1/2", 3/4"
 3,5 MPa (35 bar) for 1", 1-1/4"
 Temperature range with liquid hydrocarbons*: -20÷60 °C
 Max. working pressure at 20 °C with liquid hydrocarbons*: 1,2 MPa (12 bar)

* Please consult Giacomini technical support, to check the compatibility of the product with the specific hydrocarbon.

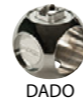

DADO

Product code	Connections	Finishing	Handle type	Handle color	Notes
R914X021	G 1/4" F x R 1/4"	Nickel plated brass	T-handle	Red	DADO ball
R914X022	G 3/8" F x R 3/8"	Nickel plated brass	T-handle	Red	DADO ball
R914X023	G 1/2" F x R 1/2"	Nickel plated brass	T-handle	Red	DADO ball
R914X024	G 3/4" F x R 3/4"	Nickel plated brass	T-handle </td <td>Red</td> <td>DADO ball</td>	Red	DADO ball
R914X025	G 1" F x R 1"	Nickel plated brass	T-handle	Red	DADO ball
R914X026	G 1-1/4" F x R 1-1/4"	Nickel plated brass	T-handle	Red	DADO ball

Product code	DN	A [mm]	I [mm]	B [mm]	J [mm]	C [mm]	H [mm]	Kv
R914X021	8	51	21	35	10	40	wr.17	6,9
R914X022	10	59	25	48	13	63	wr.21	7,0
R914X023	15	68	28	55	16	63	wr.25	13,3
R914X024	20	76	31	64	21	73	wr.32	25,8
R914X025	25	87	38	72	25	73	wr.39	50,9
R914X026	32	102	43	82	30	73	wr.47	103

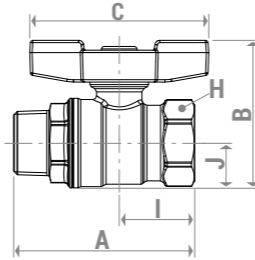

> R914L



DADO ball valve, with female-male threaded connections.
 Full port.
 Min. working temperature: -20 °C with 50 % glycol solutions
 Max. working temperature with dry saturated steam: 185 °C with 1,05 MPa (10,5 bar)
 Max. working pressure at 20 °C with water and not dangerous gas: 4,2 MPa (42 bar) for 1/4", 3/8", 1/2", 3/4"
 3,5 MPa (35 bar) for 1", 1-1/4", 1-1/2", 2"
 Temperature range with liquid hydrocarbons*: -20÷60 °C
 Max. working pressure at 20 °C with liquid hydrocarbons*: 1,2 MPa (12 bar)

* Please consult Giacomini technical support, to check the compatibility of the product with the specific hydrocarbon.

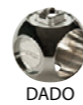

DADO

Product code	Connections	Finishing	Handle type	Handle color	Notes
R914LX021	G 1/4" F x R 1/4"	Nickel plated brass	Lever	Red	DADO ball
R914LX022	G 3/8" F x R 3/8"	Nickel plated brass	Large lever	Red	DADO ball
R914LX023	G 1/2" F x R 1/2"	Nickel plated brass	Large lever	Red	DADO ball
R914LX024	G 3/4" F x R 3/4"	Nickel plated brass	Large lever	Red	DADO ball
R914LX025	G 1" F x R 1"	Nickel plated brass	Large lever	Red	DADO ball
R914LX026	G 1-1/4" F x R 1-1/4"	Nickel plated brass	Large lever	Red	DADO ball
R914LX027	G 1-1/2" F x G 1-1/2" M	Nickel plated brass	Large lever	Red	DADO ball
R914LX028	G 2" F x G 2" M	Nickel plated brass	Large lever	Red	DADO ball

Product code	DN	A [mm]	I [mm]	B [mm]	J [mm]	C [mm]	H [mm]	Kv
R914LX021	8	51	21	36	10	42	wr.17	6,9
R914LX022	10	59	25	46	13	77	wr.21	7,0
R914LX023	15	68	28	52	16	77	wr.25	13,3
R914LX024	20	76	31	69	21	95	wr.32	25,8
R914LX025	25	88	39	77	25	95	wr.39	50,9
R914LX026	32	102	43	87	30	95	wr.47	103
R914LX027	40	105	48	108	37	137	wr.54	147
R914LX028	50	124	55	124	46	137	wr.67	222

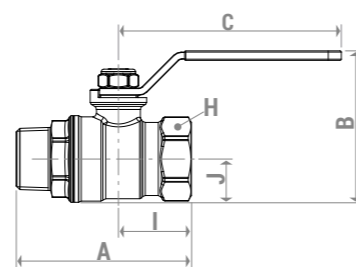

> R919

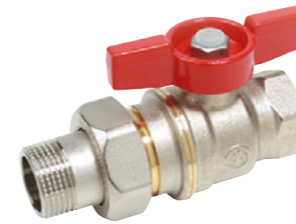

DADO ball valve, with female-tail piece male threaded connections.
 Full port.
 Min. working temperature: -20 °C with 50 % glycol solutions
 Max. working temperature with dry saturated steam: 185 °C with 1,05 MPa (10,5 bar)
 Max. working pressure at 20 °C with water and not dangerous gas: 4,2 MPa (42 bar) for 1/2" F, 3/4" F
 3,5 MPa (35 bar) for 1" F, 1-1/4" F
 Temperature range with liquid hydrocarbons*: -20÷60 °C
 Max. working pressure at 20 °C with liquid hydrocarbons*: 1,2 MPa (12 bar)

* Please consult Giacomini technical support, to check the compatibility of the product with the specific hydrocarbon.

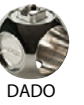

DADO

Product code	Connections	Finishing	Handle type	Handle color	Notes
R919X003	G 1/2" F x G 1/2" M	Nickel plated brass	T-handle	Red	DADO ball
R919X004	G 1/2" F x G 3/4" M	Nickel plated brass	T-handle	Red	DADO ball
R919X005	G 3/4" F x G 3/4" M	Nickel plated brass	T-handle	Red	DADO ball
R919X006	G 3/4" F x G 1" M	Nickel plated brass	T-handle	Red	DADO ball
R919X007	G 1" F x G 1" M	Nickel plated brass	T-handle	Red	DADO ball
R919X008	G 1" F x G 1-1/4" M	Nickel plated brass	T-handle	Red	DADO ball
R919X009	G 1-1/4" F x G 1-1/4" M	Nickel plated brass	T-handle	Red	DADO ball

Product code	DN	A [mm]	I [mm]	B [mm]	J [mm]	C [mm]	H [mm]	H' [mm]	Kv
R919X003	15	88	28	55	17	63	wr.25	wr.30	13,3
R919X004	15	90	28	59	21	63	wr.25	wr.38	13,3
R919X005	20	97	32	65	22	73	wr.32	wr.38	25,8
R919X006	20	101	31	67	23	73	wr.32	wr.46	25,8
R919X007	25	109	38	72	25	73	wr.39	wr.46	50,9
R919X008	25	115	38	77	30	73	wr.39	wr.53	50,9
R919X009	32	123	43	82	30	73	wr.48	wr.53	103

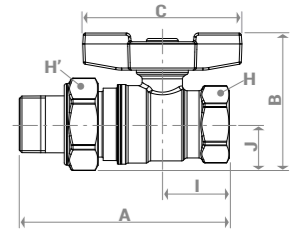

> R919S



DADO ball valve, with female-tail piece male threaded connections, with drain cock with hose connection Ø 9 mm.
 Full port.
 Temperature range: -20÷120 °C (-20 °C with 50 % glycol solutions)
 Max. working pressure at 20 °C with water: 4,2 MPa (42 bar) for 1/2", 3/4"
 3,5 MPa (35 bar) for 1", 1-1/4"

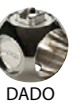

DADO

Product code	Connections	Drain cock size	Finishing	Handle type	Handle color	Notes
R919SX003	G 1/2" F x G 1/2" M	1/4"	Nickel plated brass	T-handle	Red	DADO ball, with drain cock
R919SX005	G 3/4" F x G 3/4" M	1/4"	Nickel plated brass	T-handle	Red	DADO ball, with drain cock
R919SX007	G 1" F x G 1" M	1/4"	Nickel plated brass	T-handle	Red	DADO ball, with drain cock
R919SX009	G 1-1/4" F x G 1-1/4" M	3/8"	Nickel plated brass	T-handle	Red	DADO ball, with drain cock

Product code	DN	A [mm]	I [mm]	B [mm]	J [mm]	C [mm]	H [mm]	H' [mm]	Kv
R919SX003	15	93	34	55	17	63	wr.25	wr.30	13,3
R919SX005	20	103	37	65	21	73	wr.32	wr.38	25,8
R919SX007	25	115	44	72	26	73	wr.39	wr.46	50,9
R919SX009	32	137	57	82	30	73	wr.48	wr.53	103

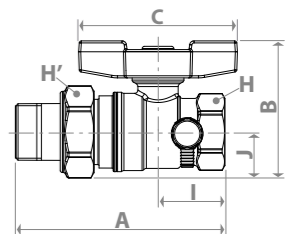

> R850



Ball valve, with female-female threaded connections.
Full port for 1/4", 3/8", 1/2", 3/4" - 1", 1-1/4", 1-1/2", 2"; standard port for 2-1/2", 3", 4".
Min. working temperature: -20 °C with 50 % glycol solutions
Max. working temperature with dry saturated steam: 185 °C with 1,05 MPa (10,5 bar)
Max. working pressure at 20 °C with water and not dangerous gas: 3,5 MPa (35 bar) for 1/4", 3/8", 1/2", 3/4"
2,8 MPa (28 bar) for 1", 1-1/4", 1-1/2", 2", 2-1/2", 3", 4"

Temperature range with liquid hydrocarbons*: -20+60 °C
Max. working pressure at 20 °C with liquid hydrocarbons*: 1,2 MPa (12 bar)

* Please consult Giacomini technical support, to check the compatibility of the product with the specific hydrocarbon.

Product code	Connections	Finishing	Handle type	Handle color
R850X021	G 1/4"F x G 1/4"F	Chrome plated brass	Lever	Red
R850X022	G 3/8"F x G 3/8"F	Chrome plated brass	Lever	Red
R850X023	G 1/2"F x G 1/2"F	Chrome plated brass	Lever	Red
R850X024	G 3/4"F x G 3/4"F	Chrome plated brass	Lever	Red
R850X025	G 1"F x G 1"F	Chrome plated brass	Lever	Red
R850X026	G 1-1/4"F x G 1-1/4"F	Chrome plated brass	Lever	Red
R850X027	G 1-1/2"F x G 1-1/2"F	Chrome plated brass	Lever	Red
R850X028	G 2"F x G 2"F	Chrome plated brass	Lever	Red
R850X029	G 2-1/2"F x G 2-1/2"F	Chrome plated brass	Lever	Red
R850X030	G 3"F x G 3"F	Chrome plated brass	Lever	Red
R850X031	G 4"F x G 4"F	Chrome plated brass	Lever	Red

Product code	DN	A [mm]	I [mm]	B [mm]	J [mm]	C [mm]	H [mm]	Kv
R850X021	8	43	21	36	10	43	wr.17	6,6
R850X022	10	46	23	45	13	77	wr.20	6,7
R850X023	15	53	27	51	16	77	wr.25	12,7
R850X024	20	60	30	67	20	95	wr.31	24,6
R850X025	25	74	37	76	25	95	wr.38	48,5
R850X026	32	84	42	85	29	95	wr.47	98,0
R850X027	40	95	47	104	35	137	wr.54	140
R850X028	50	109	54	120	43	137	wr.66	211
R850X029	58	146	73	154	52	173	wr.82	240
R850X030	68	160	80	169	60	173	wr.98	269
R850X031	90	207	104	207	77	187	wr.122	461

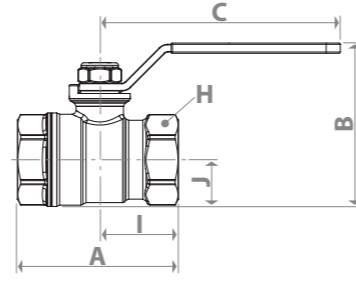

> R851T



Ball valve, with female-female threaded connections, with probe holder M10x1 mm female threaded, for probe Ø 6 mm.
Full port.
Temperature range: -20+120 °C (-20 °C with 50 % glycol solutions)
Max. working pressure at 20 °C with water: 3,5 MPa (35 bar) for 1/2", 3/4"
2,8 MPa (28 bar) for 1"

Product code	Connections	Finishing	Handle type	Handle color	Notes
R851TY103	G 1/2"F x G 1/2"F	Brass	T-handle	Red	With probe holder
R851TY104	G 3/4"F x G 3/4"F	Brass	T-handle	Red	With probe holder
R851TY105	G 1"F x G 1"F	Brass	T-handle	Red	With probe holder

Product code	DN	A [mm]	I [mm]	B [mm]	J [mm]	C [mm]	H [mm]	Kv
R851TY103	15	53	27	73	35	63	wr.25	12,7
R851TY104	20	60	30	80	37	73	wr.31	24,6
R851TY105	25	74	37	86	39	73	wr.38	48,5

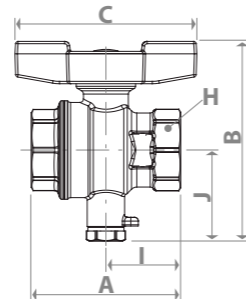

> DR850



DADO ball valve, with female-female threaded connections and anti-dezincification brass.
Full port.
Min. working temperature: -20 °C with 50 % glycol solutions
Max. working temperature with dry saturated steam: 185 °C with 1,05 MPa (10,5 bar)
Max. working pressure at 20 °C with water and not dangerous gas: 3,5 MPa (35 bar) for 1/2", 3/4"
2,8 MPa (28 bar) for 1", 1-1/4", 1-1/2", 2"

Temperature range with liquid hydrocarbons*: -20+60 °C
Max. working pressure at 20 °C with liquid hydrocarbons*: 1,2 MPa (12 bar)

* Please consult Giacomini technical support, to check the compatibility of the product with the specific hydrocarbon.

Product code	Connections	Finishing	Handle type	Handle color	Notes
DR850Y023	G 1/2"F x G 1/2"F	Brass	Lever	Red	DZR brass, DADO ball
DR850Y024	G 3/4"F x G 3/4"F	Brass	Lever	Red	DZR brass, DADO ball
DR850Y025	G 1"F x G 1"F	Brass	Lever	Red	DZR brass, DADO ball
DR850Y026	G 1-1/4"F x G 1-1/4"F	Brass	Lever	Red	DZR brass, DADO ball
DR850Y027	G 1-1/2"F x G 1-1/2"F	Brass	Lever	Red	DZR brass, DADO ball
DR850Y028	G 2"F x G 2"F	Brass	Lever	Red	DZR brass, DADO ball

Product code	DN	A [mm]	I [mm]	B [mm]	J [mm]	C [mm]	H [mm]	Kv
DR850Y023	15	53	27	51	16	77	wr.25	13,3
DR850Y024	20	60	30	67	20	95	wr.31	25,8
DR850Y025	25	74	37	76	25	95	wr.38	50,9
DR850Y026	32	84	42	85	29	95	wr.47	103
DR850Y027	40	95	47	104	35	137	wr.54	147
DR850Y028	50	109	54	120	43	137	wr.66	222

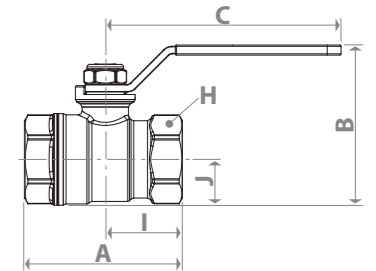

> R851



Ball valve, with female-female threaded connections.
Full port.
Min. working temperature: -20 °C with 50 % glycol solutions
Max. working temperature with dry saturated steam: 185 °C with 1,05 MPa (10,5 bar)
Max. working pressure at 20 °C with water and not dangerous gas: 3,5 MPa (35 bar) for 1/4", 3/8", 1/2", 3/4"
2,8 MPa (28 bar) for 1", 1-1/4"

Temperature range with liquid hydrocarbons*: -20+60 °C
Max. working pressure at 20 °C with liquid hydrocarbons*: 1,2 MPa (12 bar)

* Please consult Giacomini technical support, to check the compatibility of the product with the specific hydrocarbon.

Product code	Connections	Finishing	Handle type	Handle color
R851X021	G 1/4"F x G 1/4"F	Chrome plated brass	T-handle	Red
R851X022	G 3/8"F x G 3/8"F	Chrome plated brass	T-handle	Red
R851X023	G 1/2"F x G 1/2"F	Chrome plated brass	T-handle	Red
R851X024	G 3/4"F x G 3/4"F	Chrome plated brass	T-handle	Red
R851X025	G 1"F x G 1"F	Chrome plated brass	T-handle	Red
R851X026	G 1-1/4"F x G 1-1/4"F	Chrome plated brass	T-handle	Red

Product code	DN	A [mm]	I [mm]	B [mm]	J [mm]	C [mm]	H [mm]	Kv
R851X021	8	43	21	35	10	40	wr.17	6,6
R851X022	10	46	23	48	13	63	wr.20	6,7
R851X023	15	53	27	54	16	63	wr.25	12,7
R851X024	20	60	30	63	20	73	wr.31	24,6
R851X025	25	74	37	72	25	73	wr.38	48,5
R851X026	32	84	42	82	29	73	wr.47	98,0

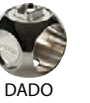
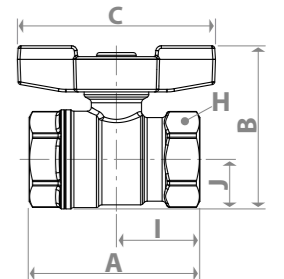

DADO

> R851TH



Ball valve, with female-female threaded connections, for pipes with high insulation thickness.
Full port.
Temperature range: -20÷110 °C (-20 °C with 50 % glycol solutions), possibility of 120 °C for short periods of time
Max. working pressure at 20 °C with water and not dangerous gas: 3,5 MPa (35 bar) for 3/8", 1/2", 3/4"
2,8 MPa (28 bar) for 1", 1-1/4", 1-1/2", 2"
Temperature range with liquid hydrocarbons*: -20÷60 °C
Max. working pressure at 20 °C with liquid hydrocarbons*: 1,2 MPa (12 bar)

* Please consult Giacomini technical support, to check the compatibility of the product with the specific hydrocarbon.

Product code	Connections	Finishing	Handle type	Handle color	Notes
R851TX002	G 3/8"F x G 3/8"F	Chrome plated brass	Extended T-handle	Red, Blue plates	For pipes with high insulation thickness
R851TX003	G 1/2"F x G 1/2"F	Chrome plated brass	Extended T-handle	Red, Blue plates	For pipes with high insulation thickness
R851TX004	G 3/4"F x G 3/4"F	Chrome plated brass	Extended T-handle	Red, Blue plates	For pipes with high insulation thickness
R851TX005	G 1"F x G 1"F	Chrome plated brass	Extended T-handle	Red, Blue plates	For pipes with high insulation thickness
R851TX006	G 1-1/4"F x G 1-1/4"F	Chrome plated brass	Extended T-handle	Red, Blue plates	For pipes with high insulation thickness
R851TX007	G 1-1/2"F x G 1-1/2"F	Chrome plated brass	Extended T-handle	Red, Blue plates	For pipes with high insulation thickness
R851TX008	G 2"F x G 2"F	Chrome plated brass	Extended T-handle	Red, Blue plates	For pipes with high insulation thickness

Product code	DN	A [mm]	I [mm]	B [mm]	J [mm]	C [mm]	H [mm]	Kv
R851TX002	10	46	23	73	13	78	wr.20	6,7
R851TX003	15	53	27	80	16	78	wr.25	12,7
R851TX004	20	60	30	89	20	78	wr.31	24,6
R851TX005	25	74	37	98	24	78	wr.38	48,5
R851TX006	32	84	42	108	30	78	wr.47	98,0
R851TX007	40	95	47	141	35	96	wr.54	140
R851TX008	50	109	54	156	43	96	wr.66	211

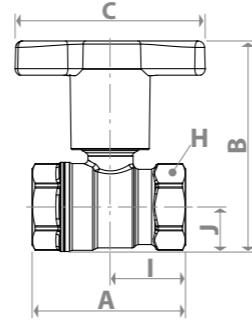

> R854



Ball valve, with female-male threaded connections.
Full port.
Min. working temperature: -20 °C with 50 % glycol solutions
Max. working temperature with dry saturated steam: 185 °C with 1,05 MPa (10,5 bar)
Max. working pressure at 20 °C with water and not dangerous gas: 3,5 MPa (35 bar) for 1/2", 3/4"
2,8 MPa (28 bar) for 1", 1-1/4"
Temperature range with liquid hydrocarbons*: -20÷60 °C
Max. working pressure at 20 °C with liquid hydrocarbons*: 1,2 MPa (12 bar)

* Please consult Giacomini technical support, to check the compatibility of the product with the specific hydrocarbon.

Product code	Connections	Finishing	Handle type	Handle color
R854X023	G 1/2"F x G 1/2"M	Chrome plated brass	T-handle	Red
R854X024	G 3/4"F x G 3/4"M	Chrome plated brass	T-handle	Red
R854X025	G 1"F x G 1"M	Chrome plated brass	T-handle	Red
R854X026	G 1-1/4"F x G 1-1/4"M	Chrome plated brass	T-handle	Red

Product code	DN	A [mm]	I [mm]	B [mm]	J [mm]	C [mm]	H [mm]	Kv
R854X023	15	64	27	54	16	63	wr.25	12,7
R854X024	20	72	30	64	20	73	wr.31	24,6
R854X025	25	83	37	72	24	73	wr.38	48,5
R854X026	32	97	42	82	29	73	wr.47	98,0

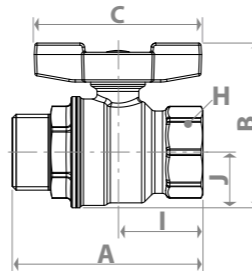

> R854L



Ball valve, with female-male threaded connections.
Full port.
Min. working temperature: -20 °C with 50 % glycol solutions
Max. working temperature with dry saturated steam: 185 °C with 1,05 MPa (10,5 bar)
Max. working pressure at 20 °C with water and not dangerous gas: 3,5 MPa (35 bar) for 1/2", 3/4"
2,8 MPa (28 bar) for 1", 1-1/4", 1-1/2", 2"
Temperature range with liquid hydrocarbons*: -20÷60 °C
Max. working pressure at 20 °C with liquid hydrocarbons*: 1,2 MPa (12 bar)

* Please consult Giacomini technical support, to check the compatibility of the product with the specific hydrocarbon.

Product code	Connections	Finishing	Handle type	Handle color
R854LX023	G 1/2"F x G 1/2"M	Chrome plated brass	Lever	Red
R854LX024	G 3/4"F x G 3/4"M	Chrome plated brass	Lever	Red
R854LX025	G 1"F x G 1"M	Chrome plated brass	Lever	Red
R854LX026	G 1-1/4"F x G 1-1/4"M	Chrome plated brass	Lever	Red
R854LX027	G 1-1/2"F x G 1-1/2"M	Chrome plated brass	Lever	Red
R854LX028	G 2"F x G 2"M	Chrome plated brass	Lever	Red

Product code	DN	A [mm]	I [mm]	B [mm]	J [mm]	C [mm]	H [mm]	Kv
R854LX023	15	66	27	52	16	77	wr.25	12,7
R854LX024	20	74	30	67	20	94	wr.31	24,6
R854LX025	25	86	37	76	24	94	wr.38	48,5
R854LX026	32	100	42	85	29	94	wr.47	98
R854LX027	40	110	47	105	35	136	wr.54	140
R854LX028	50	129	54	120	43	136	wr.67	211

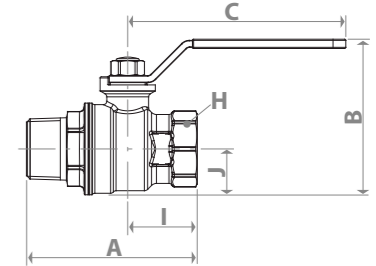

> R859



Ball valve, with female-tail piece male threaded connections.
Full port.
Min. working temperature: -20 °C with 50 % glycol solutions
Max. working temperature with dry saturated steam: 185 °C with 1,05 MPa (10,5 bar)
Max. working pressure at 20 °C with water and not dangerous gas: 3,5 MPa (35 bar) for 1/2", 3/4"
2,8 MPa (28 bar) for 1", 1-1/4"
Temperature range with liquid hydrocarbons*: -20÷60 °C
Max. working pressure at 20 °C with liquid hydrocarbons*: 1,2 MPa (12 bar)

* Please consult Giacomini technical support, to check the compatibility of the product with the specific hydrocarbon.

Product code	Connections	Finishing	Handle type	Handle color
R859X323	G 1/2"F x R 1/2"	Chrome plated brass	T-handle	Red
R859X325	G 3/4"F x G 3/4"M	Chrome plated brass	T-handle	Red
R859X327	G 1"F x G 1"M	Chrome plated brass	T-handle	Red
R859X329	G 1-1/4"F x G 1-1/4"M	Chrome plated brass	T-handle	Red
R859X343	G 1/2"F x R 1/2"	Chrome plated brass	T-handle	Blue
R859X345	G 3/4"F x G 3/4"M	Chrome plated brass	T-handle	Blue
R859X347	G 1"F x G 1"M	Chrome plated brass	T-handle	Blue
R859X349	G 1-1/4"F x G 1-1/4"M	Chrome plated brass	T-handle	Blue

Product code	DN	A [mm]	I [mm]	B [mm]	J [mm]	C [mm]	H [mm]	H' [mm]	Kv
R859X323	15	74	27	54	16	63	wr.25	wr.30	12,7
R859X325	20	83	30	64	20	73	wr.31	wr.38	24,6
R859X327	25	95	31	72	24	73	wr.38	wr.46	48,5
R859X329	32	112	42	82	30	73	wr.47	wr.53	98,0
R859X343	15	74	27	54	16	63	wr.25	wr.30	12,7
R859X345	20	83	30	64	20	73	wr.31	wr.38	24,6
R859X347	25	95	31	72	24	73	wr.38	wr.46	48,5
R859X349	32	112	42	82	30	73	wr.47	wr.53	98,0

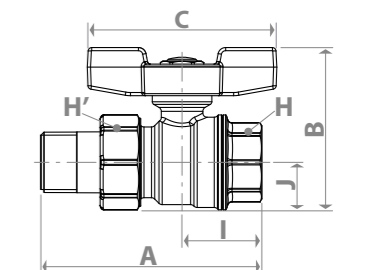

> R859T



Ball valve, with female-tail piece male threaded connections, with probe holder M10x1 mm female threaded, for probe \varnothing 6 mm.
Full port.
Temperature range: -20 ± 120 °C (-20 °C with 50 % glycol solutions)
Max. working pressure at 20 °C with water: 3,5 MPa (35 bar) for 3/4"
2,8 MPa (28 bar) for 1"

Product code	Connections	Finishing	Handle type	Handle color	Notes
R859TY005	G 3/4"F x G 3/4"M	Brass	T-handle	Red	With probe holder
R859TY006	G 3/4"F x G 1"M	Brass	T-handle	Red	With probe holder
R859TY007	G 1"F x G 1"M	Brass	T-handle	Red	With probe holder

Product code	DN	A [mm]	I [mm]	B [mm]	J [mm]	C [mm]	H [mm]	H' [mm]	Kv
R859TY005	20	95	30	80	36	73	wr.31	wr.38	24,6
R859TY006	20	100	30	80	36	73	wr.31	wr.46	24,6
R859TY007	25	108	37	84	38	73	wr.38	wr.46	48,5

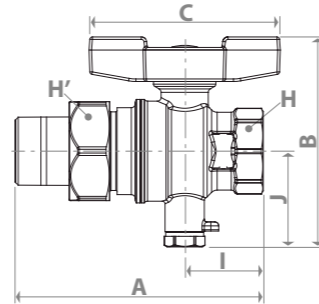

> R752



Ball valve, with female-female threaded connections with nut and gasket, with adjustable tail piece (valve length adjustment: 8 mm), specific for meters connection.
Full port.
Temperature range: -20 ± 120 °C (-20 °C with 50 % glycol solutions)
Max. working pressure at 20 °C with water: 4,2 MPa (42 bar)

Product code	Connections	Finishing	Handle type	Handle color	Notes
R752X003	G 1/2"F x G 3/4"F Nut	Chrome plated brass	T-handle	Red	Nut with 3 holes of 2,5 mm, to seal the meter

Product code	DN	A [mm]	A' [mm]	I [mm]	B [mm]	J [mm]	C [mm]	H [mm]	H' [mm]	Kv
R752X003	15	74	82	30	56	18	63	wr.26	wr.30	12,7

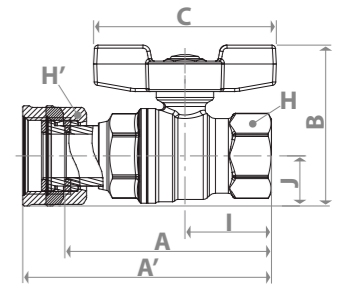

> R701F



Ball valve with built-in filter, female-female threaded connections.
Full port.
Temperature range: 5 ± 90 °C (5 ± 110 °C with P74M magnetic kit installed)
Max. working pressure at 20 °C with water: 3,2 MPa (32 bar)

Product code	Connections	Finishing	Handle type	Handle color	Notes
R701FY023	G 1/2"F x G 1/2"F	Brass	T-handle	Red	With built-in filter
R701FY024	G 3/4"F x G 3/4"F	Brass	T-handle	Red	With built-in filter
R701FY025	G 1"F x G 1"F	Brass	T-handle	Red	With built-in filter
R701FY112	Rc 3/8" x Rc 3/8"	DZR brass	T-handle	Red	With built-in filter
R701FY113	Rc 1/2" x Rc 1/2"	DZR brass	T-handle	Red	With built-in filter
R701FY114	Rc 3/4" x Rc 3/4"	DZR brass	T-handle	Red	With built-in filter
R701FY115	Rc 1" x Rc 1"	DZR brass	T-handle	Red	With built-in filter

Product code	DN	A [mm]	I [mm]	B [mm]	J [mm]	C [mm]	H [mm]	W [mm]	P [μm]	N	Kv
R701FY023	15	59	30	69	31	63	wr.25	wr.27	1	70	2,5
R701FY024	20	66	33	80	36	73	wr.31	wr.30	1	70	4,6
R701FY025	25	79	40	94	46	73	wr.38	wr.40	1	70	10
R701FY112	10	59	30	69	31	63	wr.25	wr.27	1	70	2
R701FY113	15	59	30	69	31	63	wr.25	wr.27	1	70	2,5
R701FY114	20	66	33	80	36	73	wr.31	wr.30	1	70	4,6
R701FY115	25	79	40	94	46	73	wr.38	wr.40	1	70	10

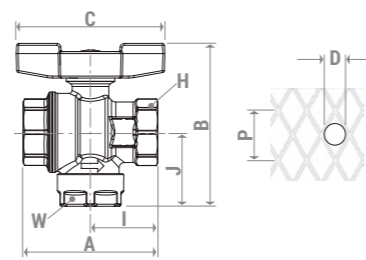

D = Diameter of inscribed hole
P = Hole pitch
N = Number of holes per cm²

> R789



Angle ball valve, with female-tail piece male threaded connections.
Full port.
Temperature range: -20 ± 120 °C (-20 °C with 50 % glycol solutions)
Max. working pressure at 20 °C with water and not dangerous gas: 1,6 MPa (16 bar)
Temperature range with liquid hydrocarbons*: -20 ± 60 °C
Max. working pressure at 20 °C with liquid hydrocarbons*: 1,2 MPa (12 bar)

* Please consult Giacomini technical support, to check the compatibility of the product with the specific hydrocarbon.

Product code	Connections	Finishing	Handle type	Handle color
R789X003	G 1/2"F x G 1/2"M	Chrome plated brass	T-handle	Red
R789X005	G 3/4"F x G 3/4"M	Chrome plated brass	T-handle	Red
R789X007	G 1"F x G 1"M	Chrome plated brass	T-handle	Red
R789X045	G 3/4"F x G 3/4"M	Chrome plated brass	T-handle	Blue
R789X047	G 1"F x G 1"M	Chrome plated brass	T-handle	Blue

Product code	DN	A [mm]	I [mm]	B [mm]	J [mm]	C [mm]	H [mm]	H' [mm]	Kv
R789X003	15	79	18	71	33	63	wr.26	wr.30	4,8
R789X005	20	89	21	82	39	73	wr.32	wr.38	8,0
R789X007	25	100	25	94	46	73	wr.41	wr.46	21,3
R789X045	20	89	21	82	39	73	wr.32	wr.38	8,0
R789X047	25	100	25	94	46	73	wr.41	wr.46	21,3

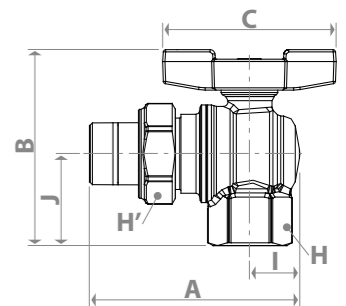

> R780P-1



Angle ball valve, with male-female threaded connections with nut and gasket, specific for under boiler use and for meters connection.
Full port.
Temperature range: -20÷120 °C (-20 °C with 50 % glycol solutions)
Max. working pressure at 20 °C with water: 1,6 MPa (16 bar)

Product code	Connections	Finishing	Handle type	Handle color	Notes
R780PX013	G 1/2"M x G 1/2"F Nut	Nickel plated brass	T-handle, one lug	Red	Under boiler use, for meter connection
R780PX014	G 3/4"M x G 3/4"F Nut	Nickel plated brass	T-handle, one lug	Red	Under boiler use, for meter connection

Product code	DN	A [mm]	I [mm]	B [mm]	J [mm]	C [mm]	H [mm]	H' [mm]	Kv
R780PX013	15	65	17	78	40	44	wr.26	wr.24	4,8
R780PX014	20	75	21	86	43	52	wr.32	wr.30	8,0

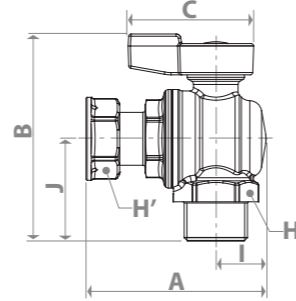

> R781P-1



Angle ball valve, with female-female threaded connections with nut and gasket, specific for under boiler use and for meters connection.
Full port.
Temperature range: -20÷120 °C (-20 °C with 50 % glycol solutions)
Max. working pressure at 20 °C with water: 1,6 MPa (16 bar)

Product code	Connections	Finishing	Handle type	Handle color	Notes
R781PX013	G 1/2"F x G 1/2"F Nut	Nickel plated brass	T-handle, one lug	Red	Under boiler use, for meter connection
R781PX014	G 3/4"F x G 3/4"F Nut	Nickel plated brass	T-handle, one lug	Red	Under boiler use, for meter connection

Product code	DN	A [mm]	I [mm]	B [mm]	J [mm]	C [mm]	H [mm]	H' [mm]	Kv
R781PX013	15	65	17	71	33	44	wr.26	wr.24	4,8
R781PX014	20	75	21	83	39	52	wr.32	wr.30	8,0

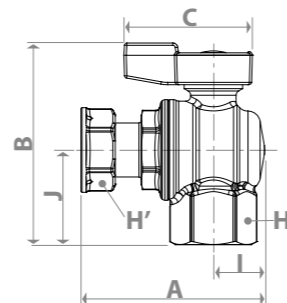

> R250DS



Ball valve, with female-female threaded connections, with drain cock with hose connection Ø 9 mm.
Standard port.
Temperature range: -20÷120 °C (-20 °C with 50 % glycol solutions)
Max. working pressure at 20 °C with water: 4,2 MPa (42 bar) for 1/2", 3/4"
3,5 MPa (35 bar) for 1", 1-1/4", 1-1/2", 2"

Product code	Connections	Drain cock size	Finishing	Handle type	Handle color	Notes
R250SX003	G 1/2"F x G 1/2"F	1/4"	Chrome plated brass	Lever	Red	With drain cock
R250SX004	G 3/4"F x G 3/4"F	1/4"	Chrome plated brass	Lever	Red	With drain cock
R250SX005	G 1"F x G 1"F	1/4"	Chrome plated brass	Lever	Red	With drain cock
R250SX006	G 1-1/4"F x G 1-1/4"F	3/8"	Chrome plated brass	Lever	Red	With drain cock
R250SX007	G 1-1/2"F x G 1-1/2"F	3/8"	Chrome plated brass	Lever	Red	With drain cock
R250SX008	G 2"F x G 2"F	3/8"	Chrome plated brass	Lever	Red	With drain cock

Product code	DN	A [mm]	I [mm]	B [mm]	J [mm]	C [mm]	H [mm]	Kv
R250SX003	14	59	32	49	15	77	wr.25	10,2
R250SX004	18	69	36	64	18	94	wr.32	18,5
R250SX005	22	81	43	73	23	94	wr.39	36,3
R250SX006	28	98	56	82	28	94	wr.48	73,5
R250SX007	35	107	60	100	33	136	wr.55	105
R250SX008	45	121	67	115	41	136	wr.67	158

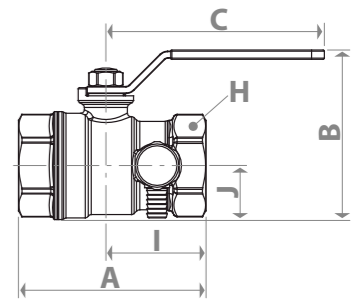

> R251S



Ball valve, with female-female connections, with drain cock with hose connection Ø 9 mm.
Standard port.
Temperature range: -20÷120 °C (-20 °C with 50 % glycol solutions)
Max. working pressure at 20 °C with water: 4,2 MPa (42 bar) for 1/2", 3/4"
3,5 MPa (35 bar) for 1"

Product code	Connections	Drain cock size	Finishing	Handle type	Handle color	Notes
R251SX003	G 1/2"F x G 1/2"F	1/4"	Chrome plated brass	T-handle	Red	With drain cock
R251SX004	G 3/4"F x G 3/4"F	1/4"	Chrome plated brass	T-handle	Red	With drain cock
R251SX005	G 1"F x G 1"F	1/4"	Chrome plated brass	T-handle	Red	With drain cock

Product code	DN	A [mm]	I [mm]	B [mm]	J [mm]	C [mm]	H [mm]	Kv
R251SX003	14	59	32	50	15	63	wr.25	10,2
R251SX004	18	69	36	60	18	73	wr.32	18,5
R251SX005	22	81	43	69	23	73	wr.39	36,3

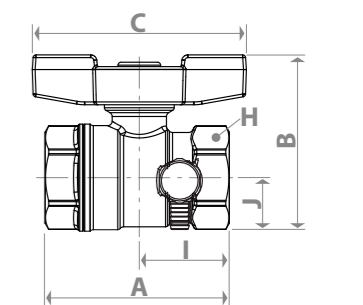

> R250D



Ball valve, with female-female threaded connections.
Standard port.

Min. working temperature: -20 °C with 50 % glycol solutions

Max. working temperature with dry saturated steam: 185 °C with 1,05 MPa (10,5 bar)

Max. working pressure at 20 °C with water and not dangerous gas: 4,2 MPa (42 bar) for 1/4", 3/8", 1/2", 3/4"

3,5 MPa (35 bar) for 1", 1-1/4", 1-1/2", 2"

2,8 MPa (28 bar) for 2-1/2", 3", 4"

Temperature range with liquid hydrocarbons*: -20÷60 °C

Max. working pressure at 20 °C with liquid hydrocarbons*: 1,2 MPa (12 bar)

*Please consult Giacomini technical support, to check the compatibility of the product with the specific hydrocarbon.

Product code	Connections	Finishing	Handle type	Handle color
R250X001	G 1/4"F x G 1/4"F	Chrome plated brass	Lever	Red
R250X002	G 3/8"F x G 3/8"F	Chrome plated brass	Lever	Red
R250X003	G 1/2"F x G 1/2"F	Chrome plated brass	Lever	Red
R250X004	G 3/4"F x G 3/4"F	Chrome plated brass	Lever	Red
R250X005	G 1"F x G 1"F	Chrome plated brass	Lever	Red
R250X006	G 1-1/4"F x G 1-1/4"F	Chrome plated brass	Lever	Red
R250X007	G 1-1/2"F x G 1-1/2"F	Chrome plated brass	Lever	Red
R250X008	G 2"F x G 2"F	Chrome plated brass	Lever	Red
R250X009	G 2-1/2"F x G 2-1/2"F	Chrome plated brass	Lever	Red
R250X010	G 3"F x G 3"F	Chrome plated brass	Lever	Red
R250X011	G 4"F x G 4"F	Chrome plated brass	Lever	Red
R250ZX001	Rc 1/4" x Rc 1/4"	Chrome plated brass	Lever	Red
R250ZX002	Rc 3/8" x Rc 3/8"	Chrome plated brass	Lever	Red
R250ZX003	Rc 1/2" x Rc 1/2"	Chrome plated brass	Lever	Red
R250ZX004	Rc 3/4" x Rc 3/4"	Chrome plated brass	Lever	Red
R250ZX005	Rc 1" x Rc 1"	Chrome plated brass	Lever	Red
R250ZX006	Rc 1-1/4" x Rc 1-1/4"	Chrome plated brass	Lever	Red
R250ZX007	Rc 1-1/2" x Rc 1-1/2"	Chrome plated brass	Lever	Red
R250ZX008	Rc 2" x Rc 2"	Chrome plated brass	Lever	Red
R250ZX009	Rc 2-1/2" x Rc 2-1/2"	Chrome plated brass	Lever	Red
R250ZX010	Rc 3" x Rc 3"	Chrome plated brass	Lever	Red
R250ZX011	Rc 4" x Rc 4"	Chrome plated brass	Lever	Red
R250ZY001	Rc 1/4" x Rc 1/4"	Brass	Lever	Red
R250ZY002	Rc 3/8" x Rc 3/8"	Brass	Lever	Red
R250ZY003	Rc 1/2" x Rc 1/2"	Brass	Lever	Red
R250ZY004	Rc 3/4" x Rc 3/4"	Brass	Lever	Red
R250ZY005	Rc 1" x Rc 1"	Brass	Lever	Red
R250ZY006	Rc 1-1/4" x Rc 1-1/4"	Brass	Lever	Red
R250ZY007	Rc 1-1/2" x Rc 1-1/2"	Brass	Lever	Red
R250ZY008	Rc 2" x Rc 2"	Brass	Lever	Red
R250ZY009	Rc 2-1/2" x Rc 2-1/2"	Brass	Lever	Red
R250ZY010	Rc 3" x Rc 3"	Brass	Lever	Red
R250ZY011	Rc 4" x Rc 4"	Brass	Lever	Red

Product code	DN	A [mm]	I [mm]	B [mm]	J [mm]	C [mm]	H [mm]	Kv
R250X001	8	43	21	36	10	43	wr.17	6,6
R250X002	10	45	22	46	14	77	wr.21	6,7
R250X003	14	54	27	49	15	77	wr.25	10,2
R250X004	18	63	31	64	18	94	wr.32	18,5
R250X005	22	75	38	73	23	94	wr.39	36,3
R250X006	28	84	42	82	28	94	wr.48	73,5
R250X007	35	93	46	100	33	136	wr.55	105
R250X008	45	107	54	115	41	136	wr.67	158
R250X009	58	146	73	154	52	173	wr.82	240
R250X010	68	160	80	169	60	173	wr.98	269
R250X011	90	207	104	207	77	187	wr.122	461
R250ZX001	8	43	21	36	10	43	wr.17	6,6
R250ZX002	10	45	22	46	14	77	wr.21	6,7
R250ZX003	14	54	27	49	15	77	wr.25	10,2
R250ZX004	18	63	31	64	18	94	wr.32	18,5
R250ZX005	22	75	38	73	23	94	wr.39	36,3
R250ZX006	28	84	42	82	28	94	wr.48	73,5
R250ZX007	35	93	46	100	33	136	wr.55	105
R250ZX008	45	107	54	115	41	136	wr.67	158
R250ZX009	58	146	73	154	52	173	wr.82	240
R250ZX010	68	160	80	169	60	173	wr.98	269
R250ZX011	90	207	104	207	77	187	wr.122	461
R250ZY001	8	43	21	36	10	43	wr.17	6,6
R250ZY002	10	45	22	46	14	77	wr.21	6,7
R250ZY003	14	54	27	49	15	77	wr.25	10,2
R250ZY004	18	63	31	64	18	94	wr.32	18,5
R250ZY005	22	75	38	73	23	94	wr.39	36,3
R250ZY006	28	84	42	82	28	94	wr.48	73,5
R250ZY007	35	93	46	100	33	136	wr.55	105
R250ZY008	45	107	54	115	41	136	wr.67	158
R250ZY009	58	146	73	154	52	173	wr.82	240
R250ZY010	68	160	80	169	60	173	wr.98	269
R250ZY011	90	207	104	207	77	187	wr.122	461

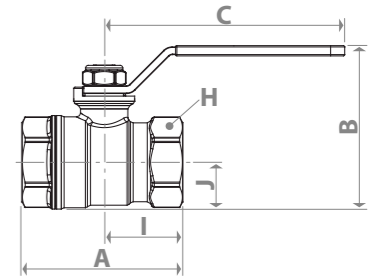

> R251D



Ball valve, with female-female threaded connections.

Standard port.

Min. working temperature: -20 °C with 50 % glycol solutions

Max. working temperature with dry saturated steam: 185 °C with 1,05 MPa (10,5 bar)

Max. working pressure at 20 °C with water and not dangerous gas: 4,2 MPa (42 bar) for 1/4", 3/8", 1/2", 3/4"
3,5 MPa (35 bar) for 1", 1-1/4"

Temperature range with liquid hydrocarbons*: -20+60 °C

Max. working pressure at 20 °C with liquid hydrocarbons*: 1,2 MPa (12 bar)

* Please consult Giacomini technical support, to check the compatibility of the product with the specific hydrocarbon.

Product code	Connections	Finishing	Handle type	Handle color
R251X001	G 1/4"F x G 1/4"F	Chrome plated brass	T-handle	Red
R251X002	G 3/8"F x G 3/8"F	Chrome plated brass	T-handle	Red
R251X003	G 1/2"F x G 1/2"F	Chrome plated brass	T-handle	Red
R251X004	G 3/4"F x G 3/4"F	Chrome plated brass	T-handle	Red
R251X005	G 1"F x G 1"F	Chrome plated brass	T-handle	Red
R251X006	G 1-1/4"F x G 1-1/4"F	Chrome plated brass	T-handle	Red
R251ZX001	Rc 1/4" x Rc 1/4"	Chrome plated brass	T-handle	Red
R251ZX003	Rc 1/2" x Rc 1/2"	Chrome plated brass	T-handle	Red
R251ZX004	Rc 3/4" x Rc 3/4"	Chrome plated brass	T-handle	Red
R251ZX005	Rc 1" x Rc 1"	Chrome plated brass	T-handle	Red
R251ZX006	Rc 1-1/4" x Rc 1-1/4"	Chrome plated brass	T-handle	Red

Product code	DN	A [mm]	I [mm]	B [mm]	J [mm]	C [mm]	H [mm]	Kv
R251X001	8	43	21	35	10	40	wr.17	6,6
R251X002	10	45	22	46	14	63	wr.21	6,7
R251X003	14	54	27	51	15	63	wr.25	10,2
R251X004	18	63	31	60	18	73	wr.32	18,5
R251X005	22	75	38	73	23	73	wr.39	36,3
R251X006	28	84	42	78	28	73	wr.48	73,5
R251ZX001	8	43	21	35	10	40	wr.17	6,6
R251ZX003	14	54	27	51	15	63	wr.25	10,2
R251ZX004	18	63	31	60	18	73	wr.32	18,5
R251ZX005	22	75	38	73	23	73	wr.39	36,3
R251ZX006	28	84	42	78	28	73	wr.48	73,5

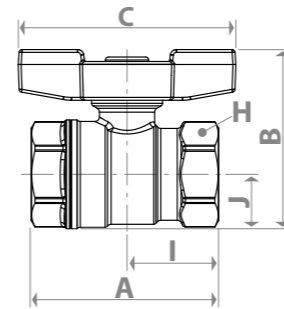

> R251TH



Ball valve, with female-female threaded connections, for pipes with high insulation thickness.

Standard port.

Temperature range: -20+110 °C (-20 °C with 50 % glycol solutions), possibility of 120 °C for short periods of time

Max. working pressure at 20 °C with water and not dangerous gas: 4,2 MPa (42 bar) for 3/8", 1/2", 3/4"
3,5 MPa (35 bar) for 1", 1-1/4", 1-1/2", 2"

Temperature range with liquid hydrocarbons*: -20+60 °C

Max. working pressure at 20 °C with liquid hydrocarbons*: 1,2 MPa (12 bar)

* Please consult Giacomini technical support, to check the compatibility of the product with the specific hydrocarbon.

Product code	Connections	Finishing	Handle type	Handle color	Notes
R251X052	G 3/8"F x G 3/8"F	Chrome plated brass	Extended T-handle	Red plate	For pipes with high insulation thickness
R251X053	G 1/2"F x G 1/2"F	Chrome plated brass	Extended T-handle	Red plate	For pipes with high insulation thickness
R251X054	G 3/4"F x G 3/4"F	Chrome plated brass	Extended T-handle	Red plate	For pipes with high insulation thickness
R251X055	G 1"F x G 1"F	Chrome plated brass	Extended T-handle	Red plate	For pipes with high insulation thickness
R251X056	G 1-1/4"F x G 1-1/4"F	Chrome plated brass	Extended T-handle	Red plate	For pipes with high insulation thickness
R251X057	G 1-1/2"F x G 1-1/2"F	Chrome plated brass	Extended T-handle	Red plate	For pipes with high insulation thickness
R251X058	G 2"F x G 2"F	Chrome plated brass	Extended T-handle	Red plate	For pipes with high insulation thickness

Product code	DN	A [mm]	I [mm]	B [mm]	J [mm]	C [mm]	H [mm]	Kv
R251X052	10	45	22	75	14	78	wr.21	6,7
R251X053	14	54	27	77	15	78	wr.25	10,2
R251X054	18	53	31	86	18	78	wr.32	18,5
R251X055	22	75	38	95	23	78	wr.39	36,3
R251X056	28	84	42	104	28	78	wr.48	73,5
R251X057	35	93	46	136	33	98	wr.55	105
R251X058	45	107	54	152	41	98	wr.67	158

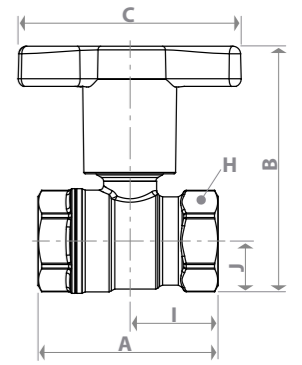

> R251P



Ball valve, with female-female threaded connections with nut and gasket, specific for meters connection.
Standard port.
Temperature range: -20+120 °C (-20 °C with 50 % glycol solutions)
Max. working pressure at 20 °C with water: 4,2 MPa (42 bar) for 1/2" F, 3/4" F
3,5 MPa (35 bar) for 1" F

Product code	Connections	Finishing	Handle type	Handle color	Notes
R251PX002	G 1/2" F x G 1/2" F Nut	Chrome plated brass	T-handle	Red	Nut without holes
R251PX003	G 1/2" F x G 3/4" F Nut	Chrome plated brass	T-handle	Red	
R251PX004	G 3/4" F x G 3/4" F Nut	Chrome plated brass	T-handle	Red	
R251PX005	G 3/4" F x G 1" F Nut	Chrome plated brass	T-handle	Red	
R251PX006	G 1" F x G 1" F Nut	Chrome plated brass	T-handle	Red	
R251PY003	G 1/2" F x G 3/4" F Nut	Brass	T-handle	Red	Nut with 3 holes of 2,5 mm, to seal the meter
R251PY004	G 3/4" F x G 3/4" F Nut	Brass	T-handle	Red	
R251PY005	G 3/4" F x G 1" F Nut	Brass	T-handle	Red	
R251PY006	G 1" F x G 1" F Nut	Brass	T-handle	Red	
R251PY045	G 3/4" F x G 1" F Nut	Brass	T-handle	Blue	
R251PY046	G 1" F x G 1" F Nut	Brass	T-handle	Blue	

Product code	DN	A [mm]	I [mm]	B [mm]	J [mm]	C [mm]	H [mm]	H' [mm]	Kv
R251PX002	14	68	27	51	15	63	wr.25	wr.24	10,2
R251PX003	14	76	27	54	18	63	wr.25	wr.30	10,2
R251PX004	14	76	28	54	18	63	wr.32	wr.30	10,2
R251PX005	18	85	31	63	21	73	wr.32	wr.37	18,5
R251PX006	22	105	38	69	23	73	wr.40	wr.37	36,3
R251PY003	14	76	27	54	18	63	wr.25	wr.30	10,2
R251PY004	14	76	28	54	18	63	wr.32	wr.30	10,2
R251PY005	18	85	31	63	21	73	wr.32	wr.37	18,5
R251PY006	22	103	38	69	23	73	wr.40	wr.37	36,3
R251PY045	18	85	31	63	21	73	wr.32	wr.37	18,5
R251PY046	22	105	38	69	23	73	wr.40	wr.37	36,3

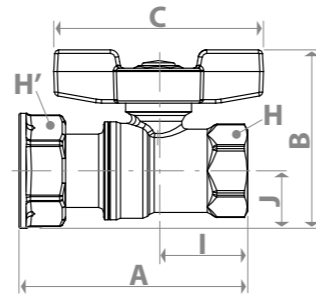

> R251P-1



Ball valve, with female-female threaded connections with nut and gasket, specific for under boiler use and for meters connection.
Standard port.
Temperature range: -20+120 °C (-20 °C with 50 % glycol solutions)
Max. working pressure at 20 °C with water: 1,6 MPa (16 bar)

Product code	Connections	Finishing	Handle type	Handle color	Notes
R251PX012	G 1/2" F x G 1/2" F Nut	Nickel plated brass	T-handle, one lug	Red	Under boiler use, for meter connection
R251PX014	G 3/4" F x G 3/4" F Nut	Nickel plated brass	T-handle, one lug	Red	Under boiler use, for meter connection

Product code	DN	A [mm]	I [mm]	B [mm]	J [mm]	C [mm]	H [mm]	H' [mm]	Kv
R251PX012	14	68	27	51	15	44	wr.25	wr.24	10,2
R251PX014	14	76	28	54	18	52	wr.32	wr.30	10,2

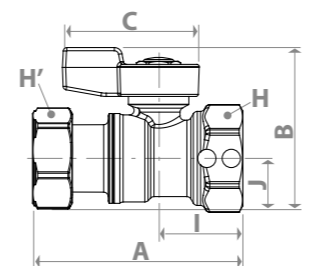

> R254P



Ball valve, with male-female threaded connections with nut and gasket, specific for meters connection.
Standard port.
Temperature range: -20+120 °C (-20 °C with 50 % glycol solutions)
Max. working pressure at 20 °C with water: 4,2 MPa

Product code	Connections	Finishing	Handle type	Handle color	Notes
R254PX004	G 3/4" M x G 3/4" F Nut	Chrome plated brass	T-handle	Red	
R254PY003	G 1/2" M x G 3/4" F Nut	Brass	T-handle	Red	Nut with 3 holes of 2,5 mm, to seal the meter
R254PY004	G 3/4" M x G 3/4" F Nut	Brass	T-handle	Red	

Product code	DN	A [mm]	I [mm]	B [mm]	J [mm]	C [mm]	H [mm]	H' [mm]	Kv
R254PX004	14	75	35	54	18	63	wr.27	wr.30	10,2
R254PY003	14	71	29	54	18	63	wr.22	wr.30	10,2
R254PY004	14	75	35	54	18	63	wr.27	wr.30	10,2

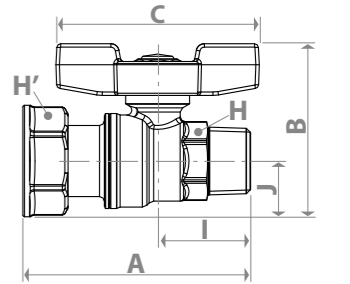

> R254P-1



Ball valve, with male-female threaded connections with nut and gasket, specific for under boiler use and for meters connection.
Standard port.
Temperature range: -20+120 °C (-20 °C with 50 % glycol solutions)
Max. working pressure at 20 °C with water: 1,6 MPa (16 bar)

Product code	Connections	Finishing	Handle type	Handle color	Notes
R254PX012	G 1/2" M x G 1/2" F Nut	Nickel plated brass	T-handle, one lug	Red	Under boiler use, for meter connection
R254PX014	G 3/4" M x G 3/4" F Nut	Nickel plated brass	T-handle, one lug	Red	Under boiler use, for meter connection
R254PX102	G 1/2" M x G 1/2" F Nut	Brass	T-handle, one lug	Red	Under boiler use, for meter connection
R254PX112	G 1/2" M x G 1/2" F Nut	Brass	T-handle, one lug	Blue	Under boiler use, for meter connection

Product code	DN	A [mm]	I [mm]	B [mm]	J [mm]	C [mm]	H [mm]	H' [mm]	Kv
R254PX012	14	70	29	51	15	44	wr.22	wr.24	10,2
R254PX014	14	75	34	52	18	52	wr.27	wr.30	10,2
R254PX102	14	70	29	51	15	44	wr.22	wr.24	10,2
R254PX112	14	70	29	51	15	44	wr.22	wr.24	10,2

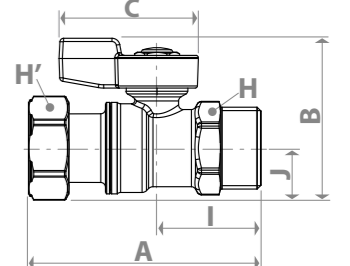

> R253D



Ball valve, with male-male threaded connections.

Standard port.

Min. working temperature: -20 °C with 50 % glycol solutions

Max. working temperature with dry saturated steam: 185 °C with 1,05 MPa (10,5 bar)

Max. working pressure at 20 °C with water and not dangerous gas: 4,2 MPa (42 bar) for 3/8", 1/2", 3/4"
3,5 MPa (35 bar) for 1", 1-1/4"

Temperature range with liquid hydrocarbons*: -20÷60 °C

Max. working pressure at 20 °C with liquid hydrocarbons*: 1,2 MPa (12 bar)

*Please consult Giacomini technical support, to check the compatibility of the product with the specific hydrocarbon.

Product code	Connections	Finishing	Handle type	Handle color
R253X002	R 3/8" x R 3/8"	Chrome plated brass	T-handle	Red
R253X003	R 1/2" x R 1/2"	Chrome plated brass	T-handle	Red
R253X004	R 3/4" x R 3/4"	Chrome plated brass	T-handle	Red
R253X005	R 1" x R 1"	Chrome plated brass	T-handle	Red
R253X006	R 1-1/4" x R 1-1/4"	Chrome plated brass	T-handle	Red

Product code	DN	A [mm]	I [mm]	B [mm]	J [mm]	C [mm]	H [mm]	Kv
R253X002	10	58	26	49	14	63	wr.19	6,7
R253X003	14	66	29	51	15	63	wr.22	10,2
R253X004	18	79	33	60	19	73	wr.29	18,5
R253X005	22	91	40	69	23	73	wr.36	36,3
R253X006	28	108	47	78	28	73	wr.44	73,5

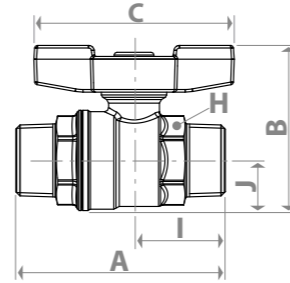

> R254D

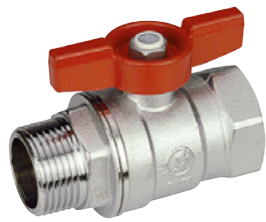

Ball valve, with female-male threaded connections.

Standard port.

Min. working temperature: -20 °C with 50 % glycol solutions

Max. working temperature with dry saturated steam: 185 °C with 1,05 MPa (10,5 bar)

Max. working pressure at 20 °C with water and not dangerous gas: 4,2 MPa (42 bar) for 1/4", 3/8", 1/2", 3/4"
3,5 MPa (35 bar) for 1", 1-1/4"

Temperature range with liquid hydrocarbons*: -20÷60 °C

Max. working pressure at 20 °C with liquid hydrocarbons*: 1,2 MPa (12 bar)

*Please consult Giacomini technical support, to check the compatibility of the product with the specific hydrocarbon.

Product code	Connections	Finishing	Handle type	Handle color
R254X001	G 1/4"F x R 1/4"	Chrome plated brass	T-handle	Red
R254X002	G 3/8"F x R 3/8"	Chrome plated brass	T-handle	Red
R254X003	G 1/2"F x R 1/2"	Chrome plated brass	T-handle	Red
R254X004	G 3/4"F x R 3/4"	Chrome plated brass	T-handle	Red
R254X005	G 1"F x R 1"	Chrome plated brass	T-handle	Red
R254X006	G 1-1/4"F x R 1-1/4"	Chrome plated brass	T-handle	Red
R254ZX002	Rc 3/8" x R 3/8"	Chrome plated brass	T-handle	Red
R254ZX003	Rc 1/2" x R 1/2"	Chrome plated brass	T-handle	Red
R254ZX004	Rc 3/4" x R 3/4"	Chrome plated brass	T-handle	Red
R254ZX005	Rc 1" x R 1"	Chrome plated brass	T-handle	Red
R254ZX006	Rc 1-1/4" x R 1-1/4"	Chrome plated brass	T-handle	Red

Product code	DN	A [mm]	I [mm]	B [mm]	J [mm]	C [mm]	H [mm]	Kv
R254X001	8	51	21	35	10	40	wr.17	6,6
R254X002	10	55	22	46	14	63	wr.21	6,7
R254X003	14	64	27	51	15	63	wr.25	10,2
R254X004	18	76	31	60	18	73	wr.32	18,5
R254X005	22	89	38	69	23	73	wr.39	36,3
R254X006	28	100	42	78	28	73	wr.48	73,5
R254ZX002	10	55	22	46	14	63	wr.21	6,7
R254ZX003	14	64	27	51	15	63	wr.25	10,2
R254ZX004	18	76	31	60	18	73	wr.32	18,5
R254ZX005	22	89	38	69	23	73	wr.39	36,3
R254ZX006	28	100	42	78	28	73	wr.48	73,5

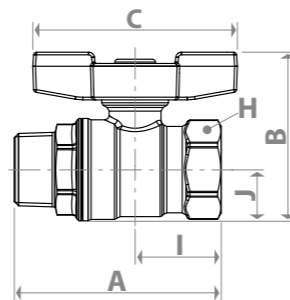

> R253DL



Ball valve, with male-male threaded connections.

Standard port.

Min. working temperature: -20 °C with 50 % glycol solutions

Max. working temperature with dry saturated steam: 185 °C with 1,05 MPa (10,5 bar)

Max. working pressure at 20 °C with water and not dangerous gas: 4,2 MPa (42 bar) for 3/8", 1/2", 3/4"
3,5 MPa (35 bar) for 1", 1-1/4"

Temperature range with liquid hydrocarbons*: -20÷60 °C

Max. working pressure at 20 °C with liquid hydrocarbons*: 1,2 MPa (12 bar)

*Please consult Giacomini technical support, to check the compatibility of the product with the specific hydrocarbon.

Product code	Connections	Finishing	Handle type	Handle color
R253LX002	R 3/8" x R 3/8"	Chrome plated brass	Lever	Red
R253LX003	R 1/2" x R 1/2"	Chrome plated brass	Lever	Red
R253LX004	R 3/4" x R 3/4"	Chrome plated brass	Lever	Red
R253LX005	R 1" x R 1"	Chrome plated brass	Lever	Red
R253LX006	R 1-1/4" x R 1-1/4"	Chrome plated brass	Lever	Red

Product code	DN	A [mm]	I [mm]	B [mm]	J [mm]	C [mm]	H [mm]	Kv
R253LX002	10	58	26	49	14	77	wr.19	6,7
R253LX003	14	66	29	51	15	77	wr.22	10,2
R253LX004	18	79	33	60	19	94	wr.29	18,5
R253LX005	22	91	40	69	23	94	wr.36	36,3
R253LX006	28	108	47	78	28	94	wr.44	73,5

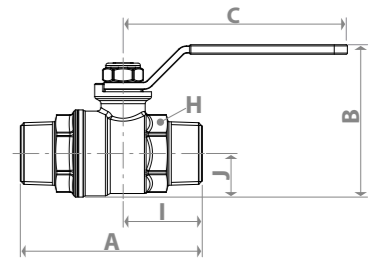

> R254DL



Ball valve, with female-male threaded connections.

Standard port.

Min. working temperature: -20 °C with 50 % glycol solutions

Max. working temperature with dry saturated steam: 185 °C with 1,05 MPa (10,5 bar)

Max. working pressure at 20 °C with water and not dangerous gas: 4,2 MPa (42 bar) for 1/4", 3/8", 1/2", 3/4"
3,5 MPa (35 bar) for 1", 1-1/4", 1-1/2", 2"

Temperature range with liquid hydrocarbons*: -20÷60 °C

Max. working pressure at 20 °C with liquid hydrocarbons*: 1,2 MPa (12 bar)

*Please consult Giacomini technical support, to check the compatibility of the product with the specific hydrocarbon.

Product code	Connections	Finishing	Handle type	Handle color
R254LX001	G 1/4"F x R 1/4"	Chrome plated brass	Lever	Red
R254LX002	G 3/8"F x R 3/8"	Chrome plated brass	Lever	Red
R254LX003	G 1/2"F x R 1/2"	Chrome plated brass	Lever	Red
R254LX004	G 3/4"F x R 3/4"	Chrome plated brass	Lever	Red
R254LX005	G 1"F x R 1"	Chrome plated brass	Lever	Red
R254LX006	G 1-1/4"F x R 1-1/4"	Chrome plated brass	Lever	Red
R254LX007	G 1-1/2"F x G 1-1/2"M	Chrome plated brass	Lever	Red
R254LX008	G 2"F x G 2"M	Chrome plated brass	Lever	Red

Product code	DN	A [mm]	I [mm]	B [mm]	J [mm]	C [mm]	H [mm]	Kv
R254LX001	8	51	21	36	10	43	wr.17	6,6
R254LX002	10	55	22	46	14	77	wr.21	6,7
R254LX003	14	64	27	49	15	77	wr.25	10,2
R254LX004	18	76	31	64	18	94	wr.32	18,5
R254LX005	22	89	38	73	23	94	wr.39	36,3
R254LX006	28	100	42	82	28	94	wr.48	73,5
R254LX007	35	105	46	100	33	136	wr.55	105
R254LX008	45	124	54	115	41	136	wr.67	158

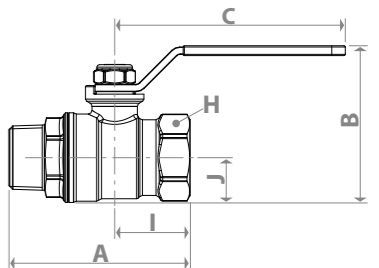

> R259D



Ball valve, with female-tail piece male threaded connections.
Standard port.
Min. working temperature: -20 °C with 50 % glycol solutions
Max. working temperature with dry saturated steam: 185 °C with 1,05 MPa (10,5 bar)
Max. working pressure at 20 °C with water and not dangerous gas: 4,2 MPa (42 bar) for 1/2"F, 3/4"F
3,5 MPa (35 bar) for 1"F, 1-1/4"F
Temperature range with liquid hydrocarbons*: -20+60 °C
Max. working pressure at 20 °C with liquid hydrocarbons*: 1,2 MPa (12 bar)

*Please consult Giacomini technical support, to check the compatibility of the product with the specific hydrocarbon.

Product code	Connections	Finishing	Handle type	Handle color
R259X003	G 1/2"F x G 1/2"M	Chrome plated brass	T-handle	Red
R259X043	G 1/2"F x G 1/2"M	Chrome plated brass	T-handle	Blue
R259X004	G 1/2"F x G 3/4"M	Chrome plated brass	T-handle	Red
R259X005	G 3/4"F x G 3/4"M	Chrome plated brass	T-handle	Red
R259X045	G 3/4"F x G 3/4"M	Chrome plated brass	T-handle	Blue
R259X006	G 3/4"F x G 1"M	Chrome plated brass	T-handle	Red
R259X007	G 1"F x G 1"M	Chrome plated brass	T-handle	Red
R259X008	G 1"F x G 1-1/4"M	Chrome plated brass	T-handle	Red
R259X009	G 1-1/4"F x G 1-1/4"M	Chrome plated brass	T-handle	Red
R259Y003	G 1/2"F x G 1/2"M	Brass	T-handle	Red
R259Y005	G 3/4"F x G 3/4"M	Brass	T-handle	Red
R259Y006	G 3/4"F x G 1"M	Brass	T-handle	Red
R259Y007	G 1"F x G 1"M	Brass	T-handle	Red
R259Y008	G 1"F x G 1-1/4"M	Brass	T-handle	Red
R259Y009	G 1-1/4"F x G 1-1/4"M	Brass	T-handle	Red
R259Y025	G 3/4"F x G 3/4"M	Brass	T-handle	Blue
R259Y026	G 3/4"F x G 1"M	Brass	T-handle	Blue
R259Y027	G 1"F x G 1"M	Brass	T-handle	Blue
R259Y029	G 1-1/4"F x G 1-1/4"M	Brass	T-handle	Blue
R259ZX003	Rc 1/2" x R 1/2"	Chrome plated brass	T-handle	Red
R259ZX005	Rc 3/4" x R 3/4"	Chrome plated brass	T-handle	Red
R259ZX007	Rc 1" x R 1"	Chrome plated brass	T-handle	Red
R259ZX009	Rc 1-1/4" x R 1-1/4"	Chrome plated brass	T-handle	Red

Product code	DN	A [mm]	I [mm]	B [mm]	J [mm]	C [mm]	H [mm]	H' [mm]	Kv
R259X003	14	86	27	53	17	63	wr.25	wr.30	10,2
R259X043	14	86	27	53	17	63	wr.25	wr.30	10,2
R259X004	14	87	27	57	21	63	wr.25	wr.38	10,2
R259X005	18	96	31	63	21	73	wr.32	wr.38	18,5
R259X045	18	96	31	63	21	73	wr.32	wr.38	18,5
R259X006	18	101	31	67	26	73	wr.32	wr.46	18,5
R259X007	22	110	38	72	26	73	wr.39	wr.46	36,3
R259X008	22	114	38	76	30	73	wr.39	wr.53	36,3
R259X009	28	125	42	80	30	73	wr.48	wr.53	73,5
R259Y003	14	86	27	53	17	63	wr.25	wr.30	10,2
R259Y005	18	96	31	63	21	73	wr.32	wr.38	18,5
R259Y006	18	101	31	67	26	73	wr.32	wr.46	18,5
R259Y007	22	110	38	72	26	73	wr.39	wr.46	36,3
R259Y008	22	114	38	76	30	73	wr.39	wr.53	36,3
R259Y009	28	125	42	80	30	73	wr.48	wr.53	73,5
R259Y025	18	96	31	63	21	73	wr.32	wr.38	18,5
R259Y026	18	101	31	67	26	73	wr.32	wr.46	18,5
R259Y027	22	110	38	72	26	73	wr.39	wr.46	36,3
R259Y029	28	125	42	80	30	73	wr.48	wr.53	73,5
R259ZX003	14	90	27	53	17	63	wr.25	wr.30	10,2
R259ZX005	18	100	31	63	21	73	wr.32	wr.38	18,5
R259ZX007	22	114	38	72	26	73	wr.39	wr.46	36,3
R259ZX009	28	129	42	80	30	73	wr.48	wr.53	73,5

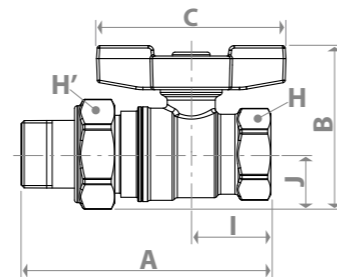

> R259DS



Ball valve, with female-tail piece male threaded connections, with drain cock with hose connection \varnothing 9 mm.
Standard port.
Temperature range: -20+120 °C (-20 °C with 50 % glycol solutions)
Max. working pressure at 20 °C with water: 4,2 MPa (42 bar) for 1/2"F, 3/4"F
3,5 MPa (35 bar) for 1"F, 1-1/4"F

Product code	Connections	Drain cock size	Finishing	Handle type	Handle color	Notes
R259SX003	G 1/2"F x G 1/2"M	1/4"	Chrome plated brass	T-handle	Red	With drain cock
R259SX004	G 1/2"F x G 3/4"M	1/4"	Chrome plated brass	T-handle	Red	With drain cock
R259SX005	G 3/4"F x G 3/4"M	1/4"	Chrome plated brass	T-handle	Red	With drain cock
R259SX006	G 3/4"F x G 1"M	1/4"	Chrome plated brass	T-handle	Red	With drain cock
R259SX007	G 1"F x G 1"M	1/4"	Chrome plated brass	T-handle	Red	With drain cock
R259SX008	G 1"F x G 1-1/4"M	1/4"	Chrome plated brass	T-handle	Red	With drain cock
R259SX009	G 1-1/4"F x G 1-1/4"M	3/8"	Chrome plated brass	T-handle	Red	With drain cock

Product code	DN	A [mm]	I [mm]	B [mm]	J [mm]	C [mm]	H [mm]	H' [mm]	Kv
R259SX003	14	91	32	53	17	63	wr.25	wr.30	10,2
R259SX004	14	93	32	57	21	63	wr.25	wr.38	10,2
R259SX005	18	102	37	63	21	73	wr.32	wr.38	18,5
R259SX006	18	107	37	67	26	73	wr.32	wr.46	18,5
R259SX007	22	116	53	72	26	73	wr.39	wr.46	36,3
R259SX008	22	120	53	76	30	73	wr.39	wr.53	36,3
R259SX009	28	138	56	80	30	73	wr.48	wr.53	73,5

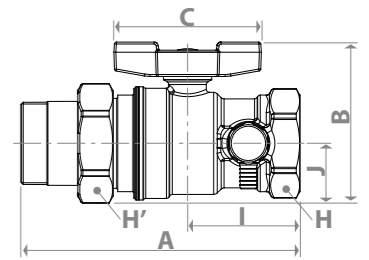

> R287



Ball valve, with female-female nut threaded connections, specific for circulator connection, with additional connections for thermometers or other optional components.
Standard port.
Temperature range: -20÷110 °C (-20 °C with 50 % glycol solutions)
Max. working pressure at 20 °C with water: 3,5 MPa (35 bar)

Product code	Connections	Additional connections	Finishing	Handle type	Handle color	Notes
R287Y005	G 1" F x G 1-1/2" F Nut	Internal thread: G 1/2" F External thread: B.18	Brass	T-handle	Red	For circulator connection, with connections for thermometers and other optional components

Product code	DN	A [mm]	I [mm]	B [mm]	J [mm]	C [mm]	H [mm]	H' [mm]	Kv
R287Y005	20	98	33	73	30	73	wr.38	wr.53	24,6

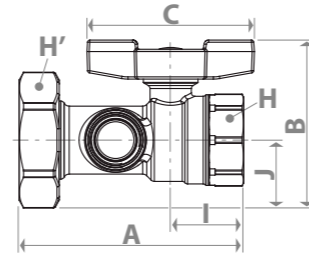

> R285L



Ball valve, with connection for nut and female threaded connection, specific for circulator connection.
Standard port.
Temperature range: -20÷110 °C (-20 °C with 50 % glycol solutions)
Max. working pressure at 20 °C with water: 3,5 MPa (35 bar)

To be completed with P18LY007 (1 1/2") or P18LY009 (2") nut. **I** See paragraph "Spare parts and accessories"
Possibility to install the R288 check valve inside the valve. **I** See paragraph "Spare parts and accessories"

Product code	Connections	Finishing	Handle type	Handle color	Notes
R285LY001	1-1/2" Nut connection x G 1-1/4" F	Brass	Lever	Red	For circulator connection
R285LY003	2" Nut connection x G 1-1/4" F	Brass	Lever	Red	For circulator connection

Product code	DN	A [mm]	I [mm]	B [mm]	J [mm]	C [mm]	H [mm]	Kv
R285LY001	22	79	42	95	23	94	wr.40	36,3
R285LY003	28	88	46	113	28	94	wr.48	73,5

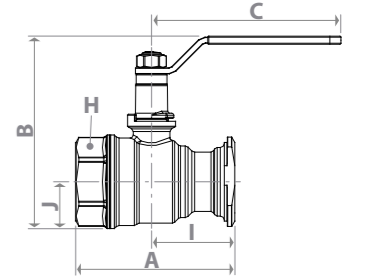

> R285



Ball valve, with connection for nut and female threaded connection, specific for circulator connection.
Standard port.
Temperature range: -20÷110 °C (-20 °C with 50 % glycol solutions)
Max. working pressure at 20 °C with water: 3,5 MPa (35 bar)

To be completed with P18LY007 (1 1/2") or P18LY009 (2") nut. **I** See paragraph "Spare parts and accessories"
Possibility to install the R288 check valve inside the valve. **I** See paragraph "Spare parts and accessories"

Product code	Connections	Finishing	Handle type	Handle color	Notes
R285Y001	1-1/2" Nut connection x G 1" F	Brass	T-handle	Red	For circulator connection
R285Y002	1-1/2" Nut connection x G 1-1/4" F	Brass	T-handle	Red	For circulator connection
R285Y003	2" Nut connection x G 1-1/4" F	Brass	T-handle	Red	For circulator connection

Product code	DN	A [mm]	I [mm]	B [mm]	J [mm]	C [mm]	H [mm]	Kv
R285Y001	22	79	42	92	23	73	wr.40	36,3
R285Y002	28	88	46	110	28	73	wr.48	73,5
R285Y003	28	88	46	110	28	73	wr.48	73,5

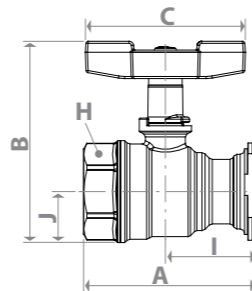

> R285F



Ball valve, with nut female connection and female threaded connection, with integrated check valve, specific for circulator connection, for pipes with high insulation thickness.
Standard port.
Temperature range (with integrated check valve): -20÷100 °C (-20 °C with 50 % glycol solutions)
Max. working pressure at 20 °C with water (with integrated check valve): 1,6 MPa (16 bar)

Product code	Connections	Finishing	Handle type	Handle color	Notes
R285FY001	G 1-1/2" F Nut x G 1" F	Brass	Extended T-handle	Red, blue plates	For circulator connection, for pipes with high insulation thickness, with check valve
R285FY003	G 2" F Nut x G 1-1/4" F	Brass	Extended T-handle	Red, blue plates	For circulator connection, for pipes with high insulation thickness, with check valve

Product code	DN	A [mm]	I [mm]	B [mm]	J [mm]	C [mm]	H [mm]	KV (with check valve)
R285FY001	22	79	41	102	30	78	wr.40	3,5
R285FY003	28	99	56	113	36	78	wr.48	7,1

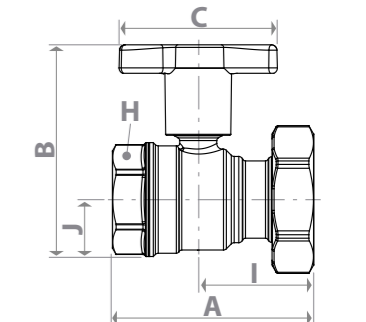

> R258CC



Ball valve, with compression connections for copper pipes.
Standard port.
Min. working temperature: -20 °C with 50 % glycol solutions
Max. working temperature with dry saturated steam: 185 °C with 1,05 MPa (10,5 bar)
Max. working pressure at 20 °C with water and not dangerous gas: 4,2 MPa (42 bar) for \varnothing 15 - \varnothing 22
3,5 MPa (35 bar) for \varnothing 28
Temperature range with liquid hydrocarbons*: -20+60 °C
Max. working pressure at 20 °C with liquid hydrocarbons*: 1,2 MPa (12 bar)

* Please consult Giacomini technical support, to check the compatibility of the product with the specific hydrocarbon.

Product code	Connections	Finishing	Handle type	Handle color
R258CX002	\varnothing 15 x \varnothing 15	Chrome plated brass	Lever	Red
R258CX005	\varnothing 22 x \varnothing 22	Chrome plated brass	Lever	Red
R258CX006	\varnothing 28 x \varnothing 28	Chrome plated brass	Lever	Red

Product code	DN	A [mm]	I [mm]	B [mm]	J [mm]	C [mm]	H [mm]	Kv
R258CX002	14	72	32	49	15	77	wr.24	10,2
R258CX005	18	88	40	64	18	94	wr.32	18,5
R258CX006	22	97	45	73	23	94	wr.39	36,3

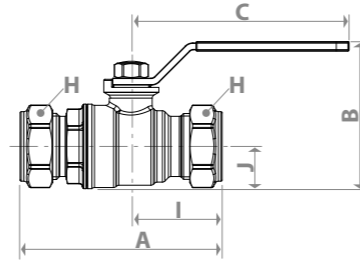

> R258D



Ball valve, with Sweat connections for copper pipes.
Standard port.
Min. working temperature: -20 °C with 50 % glycol solutions
Max. working temperature with dry saturated steam: 185 °C with 1,05 MPa (10,5 bar)
Max. working pressure at 20 °C with water and not dangerous gas: 4,2 MPa (42 bar) for \varnothing 15, \varnothing 18, \varnothing 22
3,5 MPa (35 bar) for \varnothing 28, \varnothing 35
Temperature range with liquid hydrocarbons*: -20+60 °C
Max. working pressure at 20 °C with liquid hydrocarbons*: 1,2 MPa (12 bar)

* Please consult Giacomini technical support, to check the compatibility of the product with the specific hydrocarbon.

Product code	Connections	Finishing	Handle type	Handle color
R258Y002	\varnothing 15 x \varnothing 15	Brass	Lever	Red
R258Y004	\varnothing 18 x \varnothing 18	Brass	Lever	Red
R258Y005	\varnothing 22 x \varnothing 22	Brass	Lever	Red
R258Y006	\varnothing 28 x \varnothing 28	Brass	Lever	Red
R258Y007	\varnothing 35 x \varnothing 35	Brass	Lever	Red
R258Y012	\varnothing 15 x \varnothing 15	Brass	T-handle	Red
R258Y014	\varnothing 18 x \varnothing 18	Brass	T-handle	Red
R258Y015	\varnothing 22 x \varnothing 22	Brass	T-handle	Red
R258Y016	\varnothing 28 x \varnothing 28	Brass	T-handle	Red
R258Y017	\varnothing 35 x \varnothing 35	Brass	T-handle	Red

Product code	DN	A [mm]	I [mm]	B _{lev} [mm]	B [mm]	J [mm]	C _{lev} [mm]	C [mm]	D [mm]	Kv
R258Y002	14	56	28	49	51	15	77	63	13	10,2
R258Y004	15	65	32	51	54	16	77	63	14	12,7
R258Y005	18	79	40	64	60	18	94	73	19	18,5
R258Y006	22	96	48	73	69	23	94	73	23	36,3
R258Y007	28	107	53	82	78	28	94	73	24	73,5
R258Y012	14	56	28	49	51	15	77	63	13	10,2
R258Y014	15	65	32	51	54	16	77	63	14	12,7
R258Y015	18	79	40	64	60	18	94	73	19	18,5
R258Y016	22	96	48	73	69	23	94	73	23	36,3
R258Y017	28	107	53	82	78	28	94	73	24	73,5

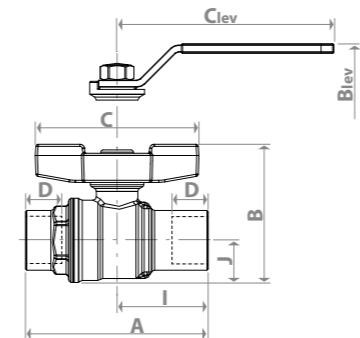

Warning.
The valve is suitable for connecting with metal pipes according to the process of soldering.
This procedure does not damage the internal seals.

> R690



MINI series ball valve, with female-female threaded connections.
Standard port.
Min. working temperature: 0 °C with glycol solutions
Max. working temperature: 90 °C
Max. working pressure at 20 °C with water and not dangerous gas: 1,6 MPa (16 bar)

Product code	Connections	Finishing	Handle type	Handle color	Notes
R690X002	G 3/8" F x G 3/8" F	Chrome plated brass	Plastic short lever	Red, green, blue plates	MINI series
R690X003	G 1/2" F x G 1/2" F	Chrome plated brass	Plastic short lever	Red, green, blue plates	MINI series

Product code	DN	A [mm]	I [mm]	B [mm]	J [mm]	C [mm]	H [mm]	Kv
R690X002	8	38	17	35	10,5	24	wr.20	2,7
R690X003	10	46	22	41	13	24	wr.25	3,9

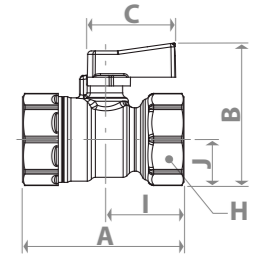

> R694



MINI series ball valve, with female-male threaded connections.
Standard port.
Min. working temperature: 0 °C with glycol solutions
Max. working temperature: 90 °C
Max. working pressure at 20 °C with water and not dangerous gas: 1,6 MPa (16 bar)

Product code	Connections	Finishing	Handle type	Handle color	Notes
R694X002	G 3/8" F x G 3/8" M	Chrome plated brass	Plastic short lever	Red, green, blue plates	MINI series
R694X003	G 1/2" F x G 1/2" M	Chrome plated brass	Plastic short lever	Red, green, blue plates	MINI series

Product code	DN	A [mm]	I [mm]	B [mm]	J [mm]	C [mm]	H [mm]	Kv
R694X002	8	37	17	35	10,5	24	wr.20	2,7
R694X003	10	46	22	41	13	24	wr.25	3,9

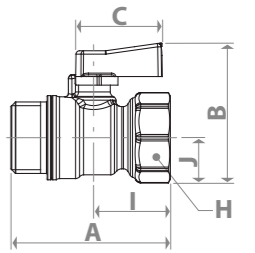

> R252



Ball valve, with female-female threaded connections with nut and gasket or with compression-female threaded connections with nut and gasket, for the connection of circulator or mixing valve.
For opening and closing operations use a screwdriver or a 5 mm Allen wrenwr.
Standard port.
Temperature range: 5÷110 °C
Max. working pressure at 20 °C with water: 0,7 MPa (7 bar)
Max. static pressure with the valve completely open or closed: 4,0 MPa (40 bar)

Product code	Connections	Finishing	Handle	Notes
R252Y001	G 1" F x G 1-1/2" F Nut	Brass	Handle with screwdriver or 5 mm Allen wrench	For circulator connection
R252Y002	G 1-1/4" F x G 2" F Nut	Brass	Handle with screwdriver or 5 mm Allen wrench	For circulator connection
R252Y003	\varnothing 22 x G 1-1/2" F Nut	Brass	Handle with screwdriver or 5 mm Allen wrench	For circulator connection
R252Y004	\varnothing 28 x G 1-1/2" F Nut	Brass	Handle with screwdriver or 5 mm Allen wrench	For circulator connection

Product code	DN	A [mm]	B [mm]	C [mm]	Kv
R252Y001	18	1" F	1 1/2" F	53	24,6
R252Y002	25	1 1/4" F	2" F	66,5	36,3
R252Y003	18	\varnothing 22	1 1/2" F	58	24,6
R252Y004	18	\varnothing 28	1 1/2" F	58	24,6

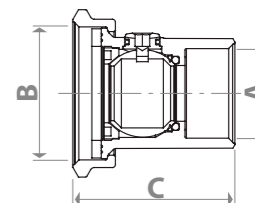

VALVES FOR DANGEROUS GAS

> R950



DADO ball valve, with female-female threaded connections, heavy series.
Full port.
Temperature range: -20+60 °C
Max. operating pressure (MOP) with gas: 0,5 MPa (5 bar)

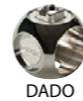

Product code	Connections	Finishing	Handle type	Handle color	Notes
R950X001	Rp 1/4" x Rp 1/4"	Nickel plated brass	Lever	Yellow	DADO ball
R950X002	Rp 3/8" x Rp 3/8"	Nickel plated brass	Large lever	Yellow	DADO ball
R950X003	Rp 1/2" x Rp 1/2"	Nickel plated brass	Large lever	Yellow	DADO ball
R950X004	Rp 3/4" x Rp 3/4"	Nickel plated brass	Large lever	Yellow	DADO ball
R950X005	Rp 1" x Rp 1"	Nickel plated brass	Large lever	Yellow	DADO ball
R950X006	Rp 1-1/4" x Rp 1-1/4"	Nickel plated brass	Large lever	Yellow	DADO ball
R950X007	Rp 1-1/2" x Rp 1-1/2"	Nickel plated brass	Large lever	Yellow	DADO ball
R950X008	Rp 2" x Rp 2"	Nickel plated brass	Large lever	Yellow	DADO ball

Product code	DN	A [mm]	I [mm]	B [mm]	J [mm]	C [mm]	H [mm]
R950X001	8	43	21	36	10	43	wr.17
R950X002	10	49	25	47	13	77	wr.21
R950X003	15	60	30	53	16	77	wr.26
R950X004	20	68	34	69	21	95	wr.32
R950X005	25	81	41	77	25	95	wr.41
R950X006	32	95	48	87	30	106	wr.50
R950X007	40	104	52	107	36	137	wr.55
R950X008	50	126	63	122	44	170	wr.70

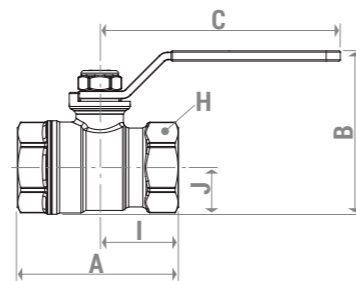

> R730GA



Ball valve, with female-female threaded connections.
Full port.
Temperature range: -20+60 °C
Max. operating pressure (MOP) with gas: 0,5 MPa (5 bar)
EN 331:2015 certified

Product code	Connections	Finishing	Handle type	Handle color
R730GAX001	G 1/4" x G 1/4" F	Nickel plated brass	Lever	Yellow
R730GAX002	G 3/8" x G 3/8" F	Nickel plated brass	Lever	Yellow
R730GAX003	G 1/2" x G 1/2" F	Nickel plated brass	Lever	Yellow
R730GAX004	G 3/4" x G 3/4" F	Nickel plated brass	Lever	Yellow
R730GAX005	G 1" x G 1" F	Nickel plated brass	Lever	Yellow
R730GAX006	G 1-1/4" x G 1-1/4" F	Nickel plated brass	Lever	Yellow
R730GAX007	G 1-1/2" x G 1-1/2" F	Nickel plated brass	Lever	Yellow
R730GAX008	G 2" x G 2" F	Nickel plated brass	Lever	Yellow

Product code	DN	A [mm]	I [mm]	B [mm]	J [mm]	C [mm]	H [mm]
R730GAX001	8	43	21	37	10	43	wr.17
R730GAX002	10	46	23	45	12	77	wr.20
R730GAX003	15	53	27	51	16	77	wr.25
R730GAX004	20	60	30	67	20	94	wr.31
R730GAX005	25	76	38	76	25	94	wr.39
R730GAX006	32	86	43	86	30	94	wr.47
R730GAX007	40	97	48	106	37	136	wr.54
R730GAX008	50	111	55	123	46	136	wr.67

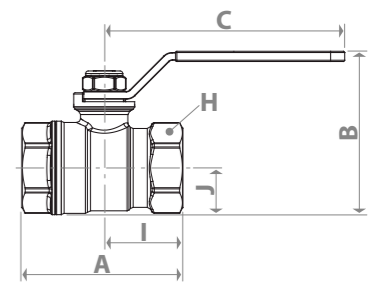

> R910



DADO ball valve, with female-female threaded connections.
Full port.
Temperature range: -20+60 °C
Max. working pressure at 20 °C with liquid hydrocarbons*: 1,2 MPa (12 bar)
Max. operating pressure (MOP) with gas: 0,5 MPa (5 bar)

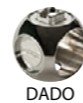

*Please consult Giacomini technical support, to check the compatibility of the product with the specific hydrocarbon.

Limited stock available.

Product code	Connections	Finishing	Handle type	Handle color	Notes
R910X009	G 2-1/2" F x G 2-1/2" F	Nickel plated brass	Lever	Yellow	DADO ball
R910X010	G 3" F x G 3" F	Nickel plated brass	Lever	Yellow	DADO ball
R910X011	G 4" F x G 4" F	Nickel plated brass	Lever	Yellow	DADO ball

Product code	DN	A [mm]	I [mm]	B [mm]	J [mm]	C [mm]	H [mm]
R910X009	65	153	76	170	58	187	wr.82
R910X010	80	173	87	189	68	187	wr.96
R910X011	100	217	108	242	88	257	wr.126

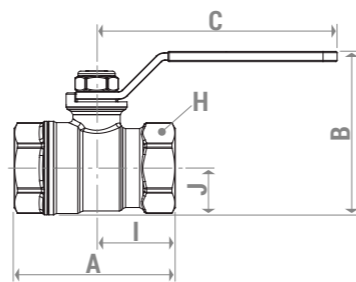

> R731GA



Ball valve, with female-female threaded connections.
Full port.
Temperature range: -20+60 °C
Max. operating pressure (MOP) with gas: 0,5 MPa (5 bar)
EN 331:2015 certified

Product code	Connections	Finishing	Handle type	Handle color
R731GAX002	G 3/8" x G 3/8" F	Nickel plated brass	T-handle	Yellow
R731GAX003	G 1/2" x G 1/2" F	Nickel plated brass	T-handle	Yellow
R731GAX004	G 3/4" x G 3/4" F	Nickel plated brass	T-handle	Yellow
R731GAX005	G 1" x G 1" F	Nickel plated brass	T-handle	Yellow
R731GAX006	G 1-1/4" x G 1-1/4" F	Nickel plated brass	T-handle	Yellow

Product code	DN	A [mm]	I [mm]	B [mm]	J [mm]	C [mm]	H [mm]
R731GAX002	10	46	23	47	12	63	wr.20
R731GAX003	15	53	27	54	16	63	wr.25
R731GAX004	20	60	30	67	20	73	wr.31
R731GAX005	25	76	38	72	25	73	wr.39
R731GAX006	32	86	43	82	30	73	wr.47

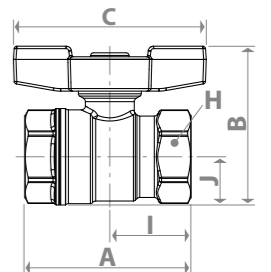

> R734LGA



Ball valve, with female-male threaded connections.
Full port.
Temperature range: -20÷60 °C
Max. operating pressure (MOP) with gas: 0,5 MPa (5 bar)
EN 331:2015 certified

Product code	Connections	Finishing	Handle type	Handle color
R734LGAX001	G 1/4" F x G 1/4" M	Nickel plated brass	Lever	Yellow
R734LGAX002	G 3/8" F x G 3/8" M	Nickel plated brass	Lever	Yellow
R734LGAX003	G 1/2" F x G 1/2" M	Nickel plated brass	Lever	Yellow
R734LGAX004	G 3/4" F x G 3/4" M	Nickel plated brass	Lever	Yellow
R734LGAX005	G 1" F x G 1" M	Nickel plated brass	Lever	Yellow
R734LGAX006	G 1-1/4" F x G 1-1/4" M	Nickel plated brass	Lever	Yellow
R734LGAX007	G 1-1/2" F x G 1-1/2" M	Nickel plated brass	Lever	Yellow
R734LGAX008	G 2" F x G 2" M	Nickel plated brass	Lever	Yellow

Product code	DN	A [mm]	I [mm]	B [mm]	J [mm]	C [mm]	H [mm]
R734LGAX001	8	49	21	37	10	43	wr.17
R734LGAX002	10	57	23	45	12	77	wr.20
R734LGAX003	15	63	27	51	16	77	wr.25
R734LGAX004	20	72	30	67	20	94	wr.31
R734LGAX005	25	84	38	76	25	94	wr.39
R734LGAX006	32	98	43	86	30	94	wr.47
R734LGAX007	40	105	48	106	37	136	wr.54
R734LGAX008	50	124	55	123	46	136	wr.67

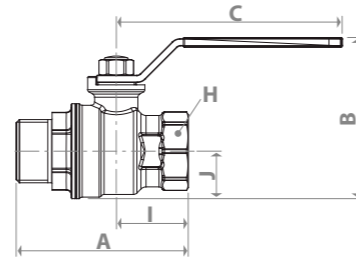

> R730GB



Ball valve, with female-female threaded connections, heavy series.
Full port.
Temperature range: -20÷60 °C
Max. operating pressure (MOP) with gas: 0,5 MPa (5 bar)
Resistance to high temperatures: EN 331:2015 certified; class B 0,1; 650 °C for 30'

Product code	Connections	Finishing	Handle type	Handle color
R730GBX003	Rp 1/2" x Rp 1/2"	Nickel plated brass	Large lever	Yellow
R730GBX004	Rp 3/4" x Rp 3/4"	Nickel plated brass	Large lever	Yellow
R730GBX005	Rp 1" x Rp 1"	Nickel plated brass	Large lever	Yellow
R730GBX006	Rp 1-1/4" x Rp 1-1/4"	Nickel plated brass	Large lever	Yellow
R730GBX007	Rp 1-1/2" x Rp 1-1/2"	Nickel plated brass	Large lever	Yellow
R730GBX008	Rp 2" x Rp 2"	Nickel plated brass	Large lever	Yellow

Product code	DN	A [mm]	I [mm]	B [mm]	J [mm]	C [mm]	H [mm]
R730GBX003	15	60	30	53	16	77	wr.26
R730GBX004	20	68	34	69	21	95	wr.32
R730GBX005	25	81	41	77	25	95	wr.41
R730GBX006	32	95	48	87	30	95	wr.50
R730GBX007	40	104	52	107	36	137	wr.55
R730GBX008	50	126	63	122	44	137	wr.70

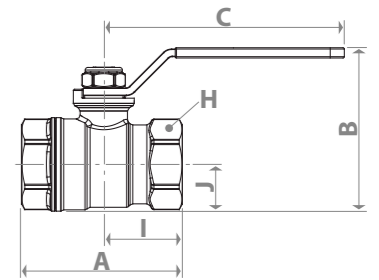

> R734GA



Ball valve, with female-male threaded connections.
Full port.
Temperature range: -20÷60 °C
Max. operating pressure (MOP) with gas: 0,5 MPa (5 bar)
EN 331:2015 certified

Product code	Connections	Finishing	Handle type	Handle color
R734GAX002	G 3/8" F x G 3/8" M	Nickel plated brass	T-handle	Yellow
R734GAX003	G 1/2" F x G 1/2" M	Nickel plated brass	T-handle	Yellow
R734GAX004	G 3/4" F x G 3/4" M	Nickel plated brass	T-handle	Yellow
R734GAX005	G 1" F x G 1" M	Nickel plated brass	T-handle	Yellow
R734GAX006	G 1-1/4" F x G 1-1/4" M	Nickel plated brass	T-handle	Yellow

Product code	DN	A [mm]	I [mm]	B [mm]	J [mm]	C [mm]	H [mm]
R734GAX002	10	57	23	47	12	63	wr.20
R734GAX003	15	63	27	54	16	63	wr.25
R734GAX004	20	72	30	67	20	73	wr.31
R734GAX005	25	84	38	72	25	73	wr.39
R734GAX006	32	98	43	82	30	73	wr.47

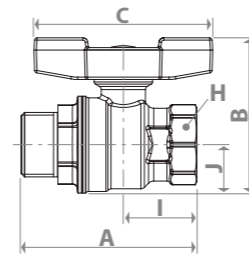

> R780GB



Angle ball valve, with male-female threaded connections.
Full port.
Temperature range: -20÷60 °C
Max. operating pressure (MOP) with gas: 0,5 MPa (5 bar)
Resistance to high temperatures: EN 331:2015 certified; class B 0,1; 650 °C for 30'

Product code	Connections	Finishing	Handle type	Handle color
R780GBX003	G 1/2" M x Rp 1/2"	Nickel plated brass	T-handle	Yellow
R780GBX004	G 3/4" M x Rp 3/4"	Nickel plated brass	T-handle	Yellow
R780GBX005	G 1" M x Rp 1"	Nickel plated brass	T-handle	Yellow

Product code	DN	A [mm]	I [mm]	B [mm]	J [mm]	C [mm]	H [mm]
R780GBX003	15	50	18	79	41	63	wr.26
R780GBX004	20	58	21	87	44	73	wr.32
R780GBX005	25	69	25	98	51	73	wr.41

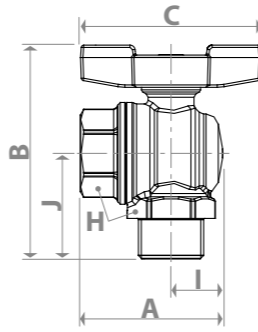

> R782GB



Angle ball valve, with male-male threaded connections.
Full port.
Temperature range: -20÷60 °C
Max. operating pressure (MOP) with gas: 0,5 MPa (5 bar)
Resistance to high temperatures: EN 331:2015 certified; class B 0,1; 650 °C for 30'

Product code	Connections	Finishing	Handle type	Handle color
R782GBX003	G 1/2" M x G 1/2" M	Nickel plated brass	T-handle	Yellow

Product code	DN	A [mm]	I [mm]	B [mm]	J [mm]	C [mm]	H [mm]	H' [mm]
R782GBX003	15	59	18	79	41	63	wr.26	wr.22

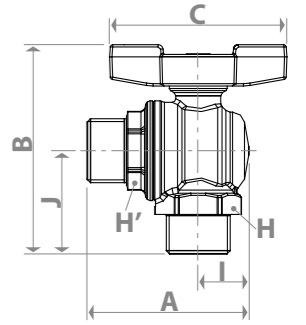

> R781GB



Angle ball valve, with female-male threaded connections.
Full port.
Temperature range: -20÷60 °C
Max. operating pressure (MOP) with gas: 0,5 MPa (5 bar)
Resistance to high temperatures: EN 331:2015 certified; class B 0,1; 650 °C for 30'

Product code	Connections	Finishing	Handle type	Handle color
R781GBX003	Rp 1/2" x G 1/2" M	Nickel plated brass	T-handle	Yellow
R781GBX004	Rp 3/4" x G 3/4" M	Nickel plated brass	T-handle	Yellow
R781GBX005	Rp 1" x G 1" M	Nickel plated brass	T-handle	Yellow

Product code	DN	A [mm]	I [mm]	B [mm]	J [mm]	C [mm]	H [mm]	H' [mm]
R781GBX003	15	59	18	71	33	63	wr.26	wr.22
R781GBX004	20	68	21	82	39	73	wr.32	wr.29
R781GBX005	25	80	25	94	46	73	wr.41	wr.36

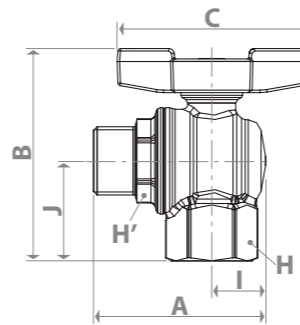

> R783GB



Angle ball valve, with female-female threaded connections.
Full port.
Temperature range: -20÷60 °C
Max. operating pressure (MOP) with gas: 0,5 MPa (5 bar)
Resistance to high temperatures: EN 331:2015 certified; class B 0,1; 650 °C for 30'

Product code	Connections	Finishing	Handle type	Handle color
R783GBX003	Rp 1/2" x Rp 1/2"	Nickel plated brass	T-handle	Yellow
R783GBX004	Rp 3/4" x Rp 3/4"	Nickel plated brass	T-handle	Yellow
R783GBX005	Rp 1" x Rp 1"	Nickel plated brass	T-handle	Yellow

Product code	DN	A [mm]	I [mm]	B [mm]	J [mm]	C [mm]	H [mm]
R783GBX003	15	50	18	71	33	63	wr.26
R783GBX004	20	58	21	82	39	73	wr.32
R783GBX005	25	69	25	94	46	73	wr.41

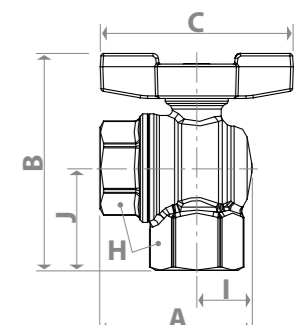

> R250D



Ball valve, with female-female threaded connections.
Standard port.
Temperature range: -20÷60 °C
Max. working pressure at 20 °C with liquid hydrocarbons*: 1,2 MPa (12 bar)
Max. operating pressure (MOP) with gas: 0,5 MPa (5 bar)

*Please consult Giacomini technical support, to check the compatibility of the product with the specific hydrocarbon.

Limited stock available.

Product code	Connections	Finishing	Handle type	Handle color
R250X029	G 2-1/2" F x G 2-1/2" F	Chrome plated brass	Lever	Yellow
R250X030	G 3" F x G 3" F	Chrome plated brass	Lever	Yellow
R250X031	G 4" F x G 4" F	Chrome plated brass	Lever	Yellow
R250ZX061	Rc 1/4" x Rc 1/4"	Chrome plated brass	Lever	Yellow
R250ZX062	Rc 3/8" x Rc 3/8"	Chrome plated brass	Lever	Yellow
R250ZX063	Rc 1/2" x Rc 1/2"	Chrome plated brass	Lever	Yellow
R250ZX064	Rc 3/4" x Rc 3/4"	Chrome plated brass	Lever	Yellow
R250ZX065	Rc 1" x Rc 1"	Chrome plated brass	Lever	Yellow
R250ZX066	Rc 1-1/4" x Rc 1-1/4"	Chrome plated brass	Lever	Yellow
R250ZX067	Rc 1-1/2" x Rc 1-1/2"	Chrome plated brass	Lever	Yellow
R250ZX068	Rc 2" x Rc 2"	Chrome plated brass	Lever	Yellow
R250ZX069	Rc 2-1/2" x Rc 2-1/2"	Chrome plated brass	Lever	Yellow
R250ZX070	Rc 3" x Rc 3"	Chrome plated brass	Lever	Yellow
R250ZX071	Rc 4" x Rc 4"	Chrome plated brass	Lever	Yellow

Product code	DN	A [mm]	I [mm]	B [mm]	J [mm]	C [mm]	H [mm]
R250X029	58	146	73	154	52	173	wr.82
R250X030	68	160	80	169	60	173	wr.98
R250X031	90	207	104	207	77	187	wr.122
R250ZX061	8	43	21	36	10	43	wr.17
R250ZX062	10	46	23	45	13	77	wr.20
R250ZX063	14	54	27	49	15	77	wr.25
R250ZX064	18	63	31	64	18	94	wr.32
R250ZX065	22	75	38	73	23	94	wr.39
R250ZX066	28	84	42	82	28	94	wr.48
R250ZX067	35	93	46	100	33	136	wr.55
R250ZX068	45	107	54	115	41	136	wr.67
R250ZX069	58	146	73	154	52	173	wr.82
R250ZX070	68	160	80	169	60	173	wr.98
R250ZX071	90	207	104	207	77	187	wr.122

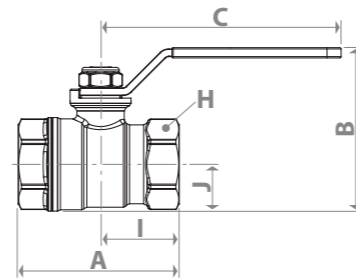

> G213SP



Ball valve, with flat seat male connections, for use with underfloor domestic gas systems.
Complete with plastic box, adjustable plastic brackets, gaskets and plastic worksite protection.
Standard port.
Temperature range: -20÷60 °C
Max. operating pressure (MOP) with gas: 0,5 MPa (5 bar)
Resistance to high temperatures: EN 331:2015 certified; class B 0,1; 650 °C for 30'

To be completed with the codes of the "Completion codes" table

Product code	Connections	Finishing	Handle type	Handle color	Notes
G213SP014	G 3/4" M flat seat x G 3/4" M flat seat	Brass	Plastic knob	Yellow	Underfloor gas system, domestic use Horizontal or vertical installation
G213SP024	G 3/4" M flat seat x G 3/4" M flat seat	Brass	Plastic knob	Yellow	Underfloor gas system, domestic use Installation with connections from below

Product code	DN	A [mm]	B [mm]	C [mm]	D [mm]	E [mm]	F [mm]	G [mm]	H [mm]	I [mm]	L [mm]	M [mm]	N [mm]
G213SP014	15	199	150	102	74	119	Ø24	Ø28	Ø30	76	14	-	-
G213SP024	15	154	140	115	94	74	119	Ø24	Ø28	Ø30	60	14	45

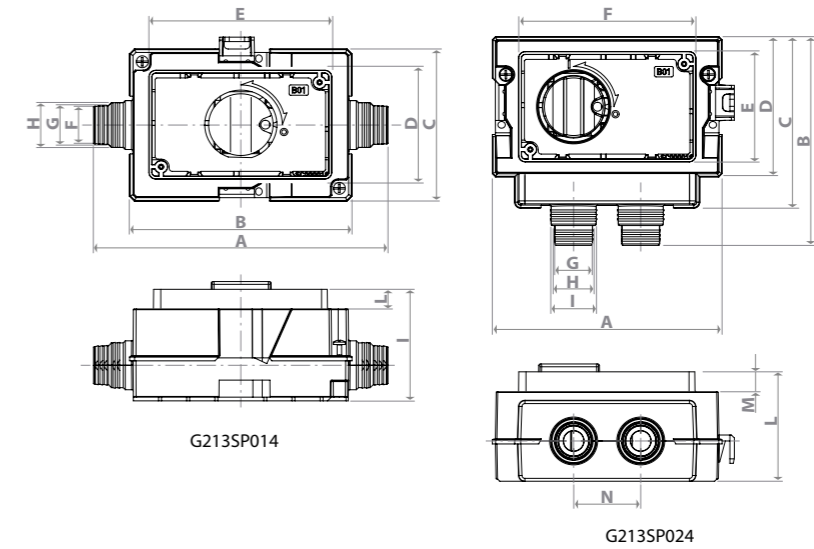

COMPLETION CODES

Valve	Optional
	R180FY120 Straight fitting for copper pipe G 3/4" F x B.16
	R180FY121 Straight fitting for copper pipe G 3/4" F x B.18
	RM179Y263 Straight multitong press fitting for Multigas pipes G 3/4" F x (16x2)
G213SP014 G213SP024	RM179Y266 Straight multitong press fitting for Multigas pipes G 3/4" F x (20x2)
	RM179Y269 Straight multitong press fitting for Multigas pipes G 3/4" F x (26x3)
	G489PL011 White plate (135 x 90 mm)
	G489PL012 Chrome plate (135 x 90 mm)

VALVES SPECIFIC FOR DOMESTIC WATER USE

> R950W



DADO ball valve, with female-female connections, heavy series, specific for domestic water.
Full port.

Temperature range: 5÷120 °C

Max. working pressure at 20 °C with water and not dangerous gas: 4,2 MPa (42 bar) for 3/8", 1/2", 3/4"
3,5 MPa (35 bar) for 1", 1-1/4", 1-1/2", 2"



Product code	Connections	Finishing	Handle type	Handle color	Notes
R950WX002	Rp 3/8" x Rp 3/8"	Nickel plated brass	Large lever	Green	DADO ball
R950WX003	Rp 1/2" x Rp 1/2"	Nickel plated brass	Large lever	Green	DADO ball
R950WX004	Rp 3/4" x Rp 3/4"	Nickel plated brass	Large lever	Green	DADO ball
R950WX005	Rp 1" x Rp 1"	Nickel plated brass	Large lever	Green	DADO ball
R950WX006	Rp 1-1/4" x Rp 1-1/4"	Nickel plated brass	Large lever	Green	DADO ball
R950WX007	Rp 1-1/2" x Rp 1-1/2"	Nickel plated brass	Large lever	Green	DADO ball
R950WX008	Rp 2" x Rp 2"	Nickel plated brass	Large lever	Green	DADO ball
R950WX045	Rp 1" x Rp 1"	Nickel plated brass	Large lever	Blue	DADO ball
R950WX046	Rp 1-1/4" x Rp 1-1/4"	Nickel plated brass	Large lever	Blue	DADO ball
R950WX047	Rp 1-1/2" x Rp 1-1/2"	Nickel plated brass	Large lever	Blue	DADO ball
R950WX048	Rp 2" x Rp 2"	Nickel plated brass	Large lever	Blue	DADO ball

Product code	DN	A [mm]	I [mm]	B [mm]	J [mm]	C [mm]	H [mm]	Kv
R950WX002	10	49	25	47	13	77	wr.21	7,0
R950WX003	15	60	30	53	16	77	wr.26	13,3
R950WX004	20	68	34	69	21	95	wr.32	25,8
R950WX005	25	81	41	77	25	95	wr.41	50,9
R950WX006	32	95	48	87	30	95	wr.50	103
R950WX007	40	104	52	107	36	137	wr.55	147
R950WX008	50	126	63	122	44	137	wr.70	222
R950WX045	25	81	41	77	25	95	wr.41	50,9
R950WX046	32	95	48	87	30	95	wr.50	103
R950WX047	40	104	52	107	36	137	wr.55	147
R950WX048	50	126	63	122	44	137	wr.70	222

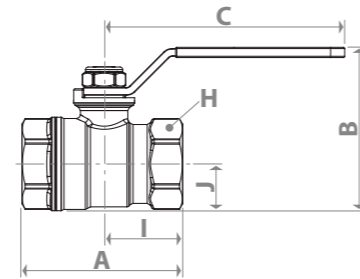

> R951W



DADO ball valve, with female-female connections, heavy series, specific for domestic water.
Full port.

Temperature range: 5÷120 °C

Max. working pressure at 20 °C with water and not dangerous gas: 4,2 MPa (42 bar) for 3/8", 1/2", 3/4"
3,5 MPa (35 bar) for 1", 1-1/4"



Product code	Connections	Finishing	Handle type	Handle color	Notes
R951WX003	Rp 1/2" x Rp 1/2"	Nickel plated brass	T-handle	Green	DADO ball
R951WX004	Rp 3/4" x Rp 3/4"	Nickel plated brass	T-handle	Green	DADO ball
R951WX005	Rp 1" x Rp 1"	Nickel plated brass	T-handle	Green	DADO ball
R951WX006	Rp 1-1/4" x Rp 1-1/4"	Nickel plated brass	T-handle	Green	DADO ball

Product code	DN	A [mm]	I [mm]	B [mm]	J [mm]	C [mm]	H [mm]	Kv
R951WX003	15	60	30	53	16	63	wr.26	13,3
R951WX004	20	68	34	69	21	77	wr.32	25,8
R951WX005	25	81	41	77	25	77	wr.41	50,9
R951WX006	32	95	48	87	30	77	wr.50	103

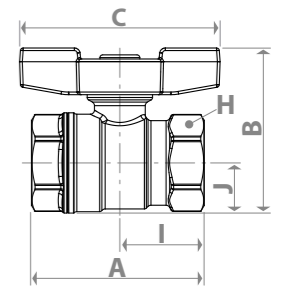

> R250W



Ball valve, with female-female connections, specific for domestic water.
Standard port.
Temperature range: 5÷120 °C
Max. working pressure at 20 °C with water and not dangerous gas: 4,2 MPa (42 bar) for 3/8", 1/2", 3/4"
3,5 MPa (35 bar) for 1", 1-1/4", 1-1/2", 2"

Product code	Connections	Finishing	Handle type	Handle color
R250WX022	Rp 3/8" x Rp 3/8"	Nickel plated brass	Lever	Green
R250WX023	Rp 1/2" x Rp 1/2"	Nickel plated brass	Lever	Green
R250WX024	Rp 3/4" x Rp 3/4"	Nickel plated brass	Lever	Green
R250WX025	Rp 1" x Rp 1"	Nickel plated brass	Lever	Green
R250WX026	Rp 1-1/4" x Rp 1-1/4"	Nickel plated brass	Lever	Green
R250WX027	Rp 1-1/2" x Rp 1-1/2"	Nickel plated brass	Lever	Green
R250WX028	Rp 2" x Rp 2"	Nickel plated brass	Lever	Green

Product code	DN	A [mm]	I [mm]	B [mm]	J [mm]	C [mm]	H [mm]	Kv
R250WX022	10	48	24	46	14	77	wr.21	6,7
R250WX023	14	56	28	49	15	77	wr.25	10,2
R250WX024	18	68	34	64	18	94	wr.32	18,5
R250WX025	22	79	40	73	23	94	wr.39	36,3
R250WX026	28	92	46	82	28	94	wr.48	73,5
R250WX027	35	100	50	100	33	136	wr.55	105
R250WX028	45	121	61	115	41	136	wr.67	158

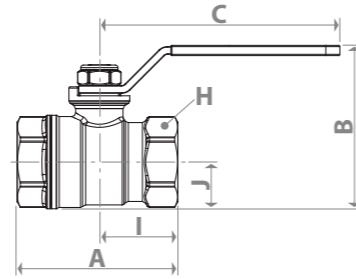

> R251W



Ball valve, with female-female connections, specific for domestic water.
Standard port.
Temperature range: 5÷120 °C
Max. working pressure at 20 °C with water and not dangerous gas: 4,2 MPa (42 bar) for 3/8", 1/2", 3/4"
3,5 MPa (35 bar) for 1", 1-1/4"

Product code	Connections	Finishing	Handle type	Handle color
R251WX022	Rp 3/8" x Rp 3/8"	Nickel plated brass	T-handle	Green
R251WX023	Rp 1/2" x Rp 1/2"	Nickel plated brass	T-handle	Green
R251WX024	Rp 3/4" x Rp 3/4"	Nickel plated brass	T-handle	Green
R251WX025	Rp 1" x Rp 1"	Nickel plated brass	T-handle	Green
R251WX026	Rp 1-1/4" x Rp 1-1/4"	Nickel plated brass	T-handle	Green

Product code	DN	A [mm]	I [mm]	B [mm]	J [mm]	C [mm]	H [mm]	Kv
R251WX022	10	48	24	49	14	63	wr.21	6,7
R251WX023	14	56	28	51	15	63	wr.25	10,2
R251WX024	18	68	34	60	18	73	wr.32	18,5
R251WX025	22	79	40	69	23	73	wr.40	36,3
R251WX026	28	92	46	77	27	73	wr.48	73,5

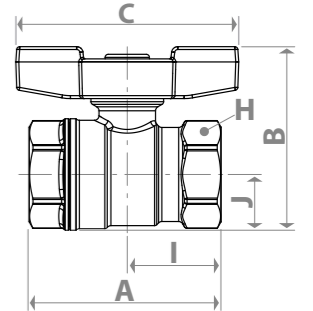

> R250WS



Ball valve, with female-female connections, with drain cock with hose connection Ø 9 mm, specific for domestic water.
Standard port.
Temperature range: 5÷120 °C
Max. working pressure at 20 °C with water: 4,2 MPa (42 bar) for 1/2", 3/4"
3,5 MPa (35 bar) for 1", 1-1/4", 1-1/2", 2"

Product code	Connections	Drain cock size	Finishing	Handle type	Handle color	Notes
R250SX143	Rp 1/2" x Rp 1/2"	1/4"	Nickel plated brass	Lever	Green	With drain cock
R250SX144	Rp 3/4" x Rp 3/4"	1/4"	Nickel plated brass	Lever	Green	With drain cock
R250SX145	Rp 1" x Rp 1"	1/4"	Nickel plated brass	Lever	Green	With drain cock
R250SX146	Rp 1-1/4" x Rp 1-1/4"	3/8"	Nickel plated brass	Lever	Green	With drain cock
R250SX147	Rp 1-1/2" x Rp 1-1/2"	3/8"	Nickel plated brass	Lever	Green	With drain cock
R250SX148	Rp 2" x Rp 2"	3/8"	Nickel plated brass	Lever	Green	With drain cock

Product code	DN	A [mm]	I [mm]	B [mm]	J [mm]	C [mm]	H [mm]	Kv
R250SX143	14	60	32	49	15	77	wr.25	10,2
R250SX144	18	71	36	64	18	94	wr.32	18,5
R250SX145	22	83	43	73	23	94	wr.39	36,3
R250SX146	28	102	56	82	28	94	wr.48	73,5
R250SX147	35	110	60	100	33	136	wr.55	105
R250SX148	45	128	67	115	41	136	wr.67	158

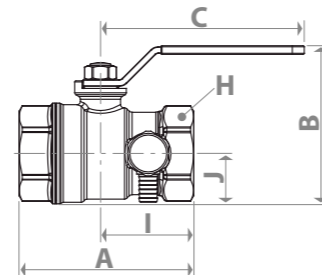

> R251WP



Ball valve, with female-female threaded connections with nut and gasket, for meters connection, specific for domestic water.
Standard port.
Temperature range: 5÷120 °C
Max. working pressure at 20 °C with water: 4,2 MPa (42 bar) for 1/2", 3/4"
3,5 MPa (35 bar) for 1"

Product code	Connections	Finishing	Handle type	Handle color	Notes
R251WX073	Rp 1/2" x G 3/4"F Nut	Nickel plated brass	T-handle	Green	For meter connection
R251WX074	Rp 3/4" x G 3/4"F Nut	Nickel plated brass	T-handle	Green	For meter connection
R251WX075	Rp 3/4" x G 1"F Nut	Nickel plated brass	T-handle	Green	For meter connection
R251WX076	Rp 1" x G 1"F Nut	Nickel plated brass	T-handle	Green	For meter connection

Product code	DN	A [mm]	I [mm]	B [mm]	J [mm]	C [mm]	H [mm]	H' [mm]	Kv
R251WX073	14	64	28	54	18	63	wr.25	wr.30	10,2
R251WX074	14	66	31	54	18	63	wr.32	wr.30	10,2
R251WX075	18	77	33	63	21	73	wr.32	wr.37	18,5
R251WX076	22	87	40	69	23	73	wr.40	wr.37	36,3

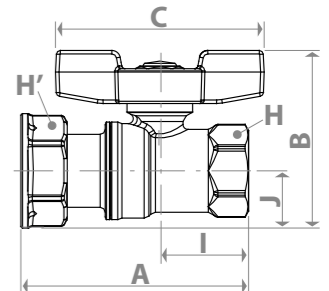

> R251WT



Ball valve, with female-female connections, for pipes with high insulation thickness, specific for domestic water.
Standard port.
Temperature range: 5÷110 °C, possibility of 120 °C for short periods of time
Max. working pressure at 20 °C with water and not dangerous gas: 4,2 MPa (42 bar) for 3/8", 1/2", 3/4"
3,5 MPa (35 bar) for 1", 1-1/4"

Product code	Connections	Finishing	Handle type	Handle color	Notes
R251WX102	Rp 3/8" x Rp 3/8"	Nickel plated brass	Extended T-handle	Green, red, blue plates	For pipes with high insulation thickness
R251WX103	Rp 1/2" x Rp 1/2"	Nickel plated brass	Extended T-handle	Green, red, blue plates	For pipes with high insulation thickness
R251WX104	Rp 3/4" x Rp 3/4"	Nickel plated brass	Extended T-handle	Green, red, blue plates	For pipes with high insulation thickness
R251WX105	Rp 1" x Rp 1"	Nickel plated brass	Extended T-handle	Green, red, blue plates	For pipes with high insulation thickness
R251WX106	Rp 1-1/4" x Rp 1-1/4"	Nickel plated brass	Extended T-handle	Green, red, blue plates	For pipes with high insulation thickness

Product code	DN	A [mm]	I [mm]	B [mm]	J [mm]	C [mm]	H [mm]	Kv
R251WX102	10	48	24	75	14	78	wr.21	6,7
R251WX103	14	57	28	77	15	78	wr.25	10,2
R251WX104	18	68	34	86	18	78	wr.32	18,5
R251WX105	22	79	39,5	95	23	78	wr.40	36,3
R251WX106	28	92	46	104	28	78	wr.49	73,5

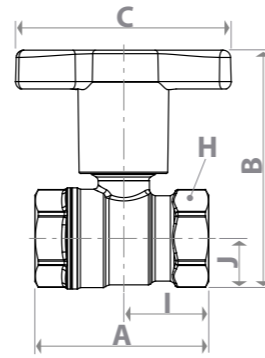

> R253W



Ball valve, with male-male connections, specific for domestic water.
Standard port.
Temperature range: 5÷120 °C
Max. working pressure at 20 °C with water and not dangerous gas: 4,2 MPa (42 bar) for 3/8", 1/2", 3/4"
3,5 MPa (35 bar) for 1", 1-1/4"

Product code	Connections	Finishing	Handle type	Handle color
R253WX002	G 3/8" M x G 3/8" M	Nickel plated brass	T-handle	Green
R253WX003	G 1/2" M x G 1/2" M	Nickel plated brass	T-handle	Green
R253WX004	G 3/4" M x G 3/4" M	Nickel plated brass	T-handle	Green
R253WX005	G 1" M x G 1" M	Nickel plated brass	T-handle	Green
R253WX006	G 1-1/4" M x G 1-1/4" M	Nickel plated brass	T-handle	Green

Product code	DN	A [mm]	I [mm]	B [mm]	J [mm]	C [mm]	H [mm]	Kv
R253WX002	10	58	26	49	14	63	wr.19	6,7
R253WX003	14	66	29	51	15	63	wr.22	10,2
R253WX004	18	79	33	60	19	73	wr.29	18,5
R253WX005	22	91	40	69	23	73	wr.36	36,3
R253WX006	28	108	47	78	28	73	wr.44	73,5

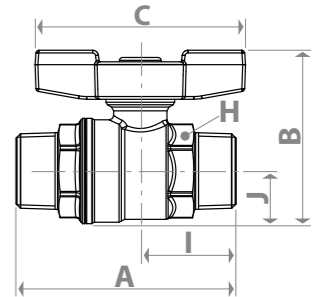

> R251WST



Ball valve, with female-female connections, with drain cock with hose connection Ø 9 mm, for pipes with high insulation thickness, specific for domestic water.
Standard port.
Temperature range: 5÷110 °C, possibility of 120 °C for short periods of time
Max. working pressure at 20 °C with water: 4,2 MPa (42 bar) for 1/2", 3/4"
3,5 MPa (35 bar) for 1", 1-1/4"

Product code	Connections	Drain cock size	Finishing	Handle type	Handle color	Notes
R251SX103	Rp 1/2" x Rp 1/2"	1/4"	Nickel plated brass	Extended T-handle	Green, red, blue plates	With drain cock, for pipes with high insulation thickness
R251SX104	Rp 3/4" x Rp 3/4"	1/4"	Nickel plated brass	Extended T-handle	Green, red, blue plates	With drain cock, for pipes with high insulation thickness
R251SX105	Rp 1" x Rp 1"	1/4"	Nickel plated brass	Extended T-handle	Green, red, blue plates	With drain cock, for pipes with high insulation thickness
R251SX106	Rp 1-1/4" x Rp 1-1/4"	3/8"	Nickel plated brass	Extended T-handle	Green, red, blue plates	With drain cock, for pipes with high insulation thickness

Product code	DN	A [mm]	I [mm]	B [mm]	J [mm]	C [mm]	H [mm]	Kv
R251SX103	14	60	32	77	15	78	wr.25	10,2
R251SX104	18	71	36	86	18	78	wr.32	18,5
R251SX105	22	83	43	95	23	78	wr.40	36,3
R251SX106	28	102	56	104	28	78	wr.49	73,5

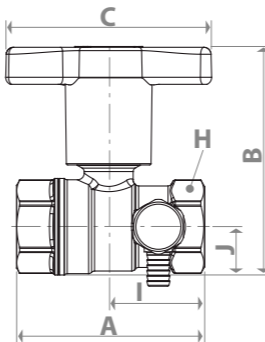

> R253WL



Ball valve, with male-male connections, specific for domestic water.
Standard port.
Temperature range: 5÷120 °C
Max. working pressure at 20 °C with water and not dangerous gas: 4,2 MPa (42 bar) for 3/8", 1/2", 3/4"
3,5 MPa (35 bar) for 1", 1-1/4"

Product code	Connections	Finishing	Handle type	Handle color
R253WX032	G 3/8" M x G 3/8" M	Nickel plated brass	Lever	Green
R253WX033	G 1/2" M x G 1/2" M	Nickel plated brass	Lever	Green
R253WX034	G 3/4" M x G 3/4" M	Nickel plated brass	Lever	Green
R253WX035	G 1" M x G 1" M	Nickel plated brass	Lever	Green
R253WX036	G 1-1/4" M x G 1-1/4" M	Nickel plated brass	Lever	Green

Product code	DN	A [mm]	I [mm]	B [mm]	J [mm]	C [mm]	H [mm]	Kv
R253WX032	10	58	26	49	14	77	wr.19	6,7
R253WX033	14	66	29	51	15	77	wr.22	10,2
R253WX034	18	79	33	60	19	94	wr.29	18,5
R253WX035	22	91	40	69	23	94	wr.36	36,3
R253WX036	28	108	47	78	28	94	wr.44	73,5

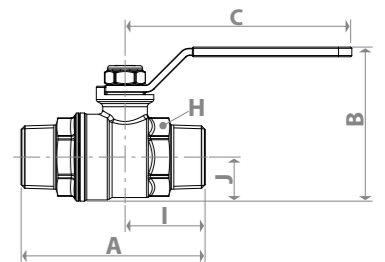

> R254W



Ball valve, with female-male connections, specific for domestic water.
Standard port.
Temperature range: 5÷120 °C
Max. working pressure at 20 °C with water and not dangerous gas: 4,2 MPa (42 bar) for 3/8", 1/2", 3/4"
3,5 MPa (35 bar) for 1", 1-1/4"

Product code	Connections	Finishing	Handle type	Handle color
R254WX022	Rp 3/8" x R 3/8"	Nickel plated brass	T-handle	Green
R254WX023	Rp 1/2" x R 1/2"	Nickel plated brass	T-handle	Green
R254WX024	Rp 3/4" x R 3/4"	Nickel plated brass	T-handle	Green
R254WX025	Rp 1" x R 1"	Nickel plated brass	T-handle	Green
R254WX026	Rp 1-1/4" x R 1-1/4"	Nickel plated brass	T-handle	Green

Product code	DN	A [mm]	I [mm]	B [mm]	J [mm]	C [mm]	H [mm]	Kv
R254WX022	10	55	22	46	14	63	wr.21	6,7
R254WX023	14	64	27	51	15	63	wr.25	10,2
R254WX024	18	76	31	60	18	73	wr.32	18,5
R254WX025	22	89	38	69	23	73	wr.39	36,3
R254WX026	28	100	42	78	28	73	wr.48	73,5

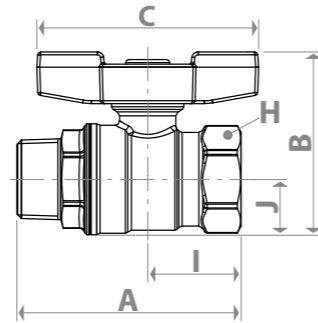

> R259W



Ball valve, with female-tail piece male connections, specific for domestic water.
Standard port.
Temperature range: 5÷120 °C
Max. working pressure at 20 °C with water and not dangerous gas: 4,2 MPa (42 bar) for 1/2", 3/4"
3,5 MPa (35 bar) for 1", 1-1/4"

Product code	Connections	Finishing	Handle type	Handle color
R259WX023	Rp 1/2" x R 1/2"	Nickel plated brass	T-handle	Green
R259WX024	Rp 1/2" x R 3/4"	Nickel plated brass	T-handle	Green
R259WX025	Rp 3/4" x R 3/4"	Nickel plated brass	T-handle	Green
R259WX026	Rp 3/4" x R 1"	Nickel plated brass	T-handle	Green
R259WX027	Rp 1" x R 1"	Nickel plated brass	T-handle	Green
R259WX028	Rp 1" x R 1-1/4"	Nickel plated brass	T-handle	Green
R259WX029	Rp 1-1/4" x R 1-1/4"	Nickel plated brass	T-handle	Green

Product code	DN	A [mm]	I [mm]	B [mm]	J [mm]	C [mm]	H [mm]	H' [mm]	Kv
R259WX023	14	86	27	53	17	63	wr.25	wr.30	10,2
R259WX024	14	87	27	57	21	63	wr.25	wr.38	10,2
R259WX025	18	96	31	63	21	73	wr.32	wr.38	18,5
R259WX026	18	101	31	67	26	73	wr.32	wr.46	18,5
R259WX027	22	110	38	72	26	73	wr.39	wr.46	36,3
R259WX028	22	114	38	76	30	73	wr.39	wr.53	36,3
R259WX029	28	125	42	80	30	73	wr.48	wr.53	73,5

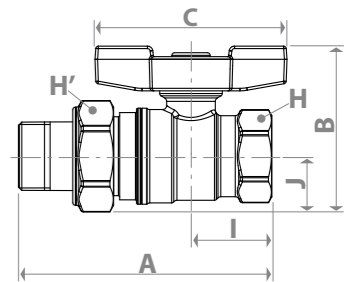

> R254WL



Ball valve, with female-male connections, specific for domestic water.
Standard port.
Temperature range: 5÷120 °C
Max. working pressure at 20 °C with water and not dangerous gas: 4,2 MPa (42 bar) for 3/8", 1/2", 3/4"
3,5 MPa (35 bar) for 1", 1-1/4", 1-1/2", 2"

Product code	Connections	Finishing	Handle type	Handle color
R254WX052	Rp 3/8" x R 3/8"	Nickel plated brass	Lever	Green
R254WX053	Rp 1/2" x R 1/2"	Nickel plated brass	Lever	Green
R254WX054	Rp 3/4" x R 3/4"	Nickel plated brass	Lever	Green
R254WX055	Rp 1" x R 1"	Nickel plated brass	Lever	Green
R254WX056	Rp 1-1/4" x R 1-1/4"	Nickel plated brass	Lever	Green
R254WX057	Rp 1-1/2" x R 1-1/2"	Nickel plated brass	Lever	Green
R254WX058	Rp 2" x R 2"	Nickel plated brass	Lever	Green

Product code	DN	A [mm]	I [mm]	B [mm]	J [mm]	C [mm]	H [mm]	Kv
R254WX052	10	55	22	46	14	77	wr.21	6,7
R254WX053	14	64	27	49	15	77	wr.25	10,2
R254WX054	18	76	31	64	18	94	wr.32	18,5
R254WX055	22	89	38	73	23	94	wr.39	36,3
R254WX056	28	100	42	82	28	94	wr.48	73,5
R254WX057	35	105	46	100	33	136	wr.55	105
R254WX058	45	124	54	115	41	136	wr.67	158

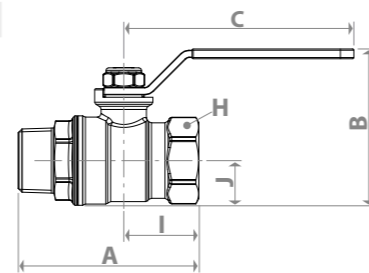

> R850VW



Ball valve, with press connections (for copper pipe complying with EN 1057; for stainless steel pipe complying with EN 10217-7 and EN 10312; for carbon steel pipe complying with EN 10305-3), specific for domestic water.
Full port.
Temperature range: 5÷110 °C
Max. working pressure at 20 °C with water: 2,8 MPa (28 bar)

Product code	Connections	Tongs profile	Finishing	Handle type	Handle color
R850VY137	Ø 42 x Ø 42	V	Brass	Large lever	Green
R850VY138	Ø 54 x Ø 54	V	Brass	Large lever	Green

Product code	DN	A [mm]	I [mm]	B [mm]	J [mm]	C [mm]	Kv
R850VY137	40	158	79	106	36	136	140
R850VY138	50	186	91	122	44	136	211

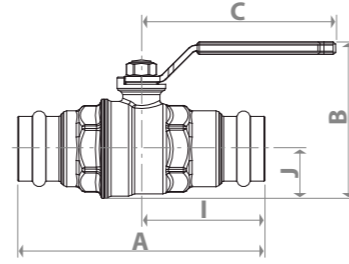

> R851VT



Ball valve, with press connections (for copper pipe complying with EN 1057; for stainless steel pipe complying with EN 10217-7 and EN 10312; for carbon steel pipe complying with EN 10305-3), for pipes with high insulation thickness, specific for domestic water.
Full port.
Temperature range: 5÷110 °C, possibility of 120 °C for short periods of time
Max. working pressure at 20 °C with water: 3,5 MPa (35 bar) for Ø 15, Ø 18, Ø 22
2,8 MPa (28 bar) for Ø 28, Ø 35

Product code	Connections	Tongs profile	Finishing	Handle type	Handle color	Notes
R851VY102	Ø 18 x Ø 18	V - SA - M	Brass	Extended T-handle	Green, red, blue plates	For pipes with high insulation thickness
R851VY103	Ø 15 x Ø 15	V - SA - M	Brass	Extended T-handle	Green, red, blue plates	For pipes with high insulation thickness
R851VY104	Ø 22 x Ø 22	V - SA - M	Brass	Extended T-handle	Green, red, blue plates	For pipes with high insulation thickness
R851VY105	Ø 28 x Ø 28	V - SA - M	Brass	Extended T-handle	Green, red, blue plates	For pipes with high insulation thickness
R851VY106	Ø 35 x Ø 35	V - SA - M	Brass	Extended T-handle	Green, red, blue plates	For pipes with high insulation thickness

Product code	DN	A [mm]	I [mm]	B [mm]	J [mm]	C [mm]	Kv
R851VY102	15	100	50	80	16	78	12,7
R851VY103	15	100	50	81	17	78	12,7
R851VY104	20	116	58	90	20	78	24,6
R851VY105	25	122	61	98	25	78	48,5
R851VY106	32	130	65	108	30	78	98,0

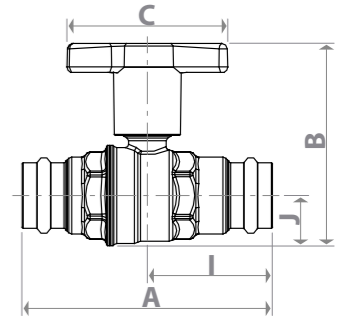

> R850VWS

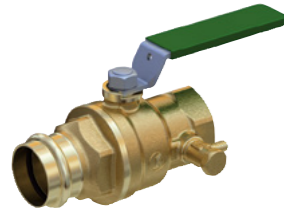

Ball valve, with female threaded-press connections (for copper pipe complying with EN 1057; for stainless steel pipe complying with EN 10217-7 and EN 10312; for carbon steel pipe complying with EN 10305-3), with drain cock with hose connection Ø 9 mm, specific for domestic water.
Full port.
Temperature range: 5÷110 °C
Max. working pressure at 20 °C with water: 2,8 MPa (28 bar)

Product code	Connections	Drain cock size	Tongs profile	Finishing	Handle type	Handle color	Notes
R850VY158	Rp 2" x Ø 54	3/8"	V	Brass	Large lever	Green	With drain cock

Product code	DN	A [mm]	I [mm]	B [mm]	J [mm]	C [mm]	H [mm]	Kv
R850VY158	50	165	69	122	44	136	wr.67	211

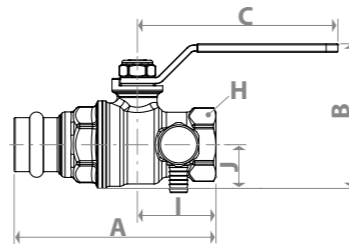

> R851VTS



Ball valve, with female threaded-press connections (for copper pipe complying with EN 1057; for stainless steel pipe complying with EN 10217-7 and EN 10312; for carbon steel pipe complying with EN 10305-3), with drain cock with hose connection Ø 9 mm, for pipes with high insulation thickness, specific for domestic water.
Full port.
Temperature range: 5÷110 °C, possibility of 120 °C for short periods of time
Max. working pressure at 20 °C with water: 3,5 MPa (35 bar) for Ø 15, Ø 18, Ø 22
2,8 MPa (28 bar) for Ø 28

Product code	Connections	Drain cock size	Tongs profile	Finishing	Handle type	Handle color	Notes
R851VY152	Rp 1/2" x Ø 18	1/4"	V - SA - M	Brass	Extended T-handle	Green, red, blue plates	With drain cock, for pipes with high insulation thickness
R851VY153	Rp 1/2" x Ø 15	1/4"	V - SA - M	Brass	Extended T-handle	Green, red, blue plates	With drain cock, for pipes with high insulation thickness
R851VY154	Rp 3/4" x Ø 22	1/4"	V - SA - M	Brass	Extended T-handle	Green, red, blue plates	With drain cock, for pipes with high insulation thickness
R851VY155	Rp 1" x Ø 28	1/4"	V - SA - M	Brass	Extended T-handle	Green, red, blue plates	With drain cock, for pipes with high insulation thickness

Product code	DN	A [mm]	I [mm]	B [mm]	J [mm]	C [mm]	H [mm]	Kv
R851VY152	15	84	34	81	17	78	wr.25	12,7
R851VY153	15	84	34	81	17	78	wr.25	12,7
R851VY154	20	95	37	91	21	78	wr.31	24,6
R851VY155	25	105	44	98	25	78	wr.39	48,5

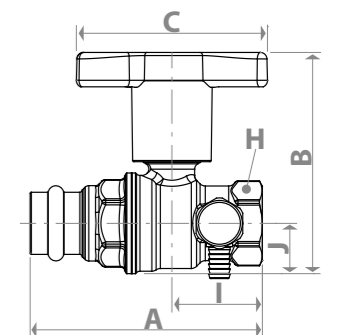

> R853VT

Ball valve, with male threaded-press connections (for copper pipe complying with EN 1057; for stainless steel pipe complying with EN 10217-7 and EN 10312; for carbon steel pipe complying with EN 10305-3), for pipes with high insulation thickness, specific for domestic water.

Full port.

Temperature range: 5÷110 °C, possibility of 120 °C for short periods of time
Max. working pressure at 20 °C with water: 3,5 MPa (35 bar) for Ø 15, Ø 18, Ø 22
2,8 MPa (28 bar) for Ø 28, Ø 35

Product code	Connections	Tongs profile	Finishing	Handle type	Handle color	Notes
R853VY102	G 1/2" M x Ø 18	V - SA - M	Brass	Extended T-handle	Green, red, blue plates	For pipes with high insulation thickness
R853VY103	G 1/2" M x Ø 15	V - SA - M	Brass	Extended T-handle	Green, red, blue plates	For pipes with high insulation thickness
R853VY104	G 3/4" M x Ø 22	V - SA - M	Brass	Extended T-handle	Green, red, blue plates	For pipes with high insulation thickness
R853VY105	G 1" M x Ø 28	V - SA - M	Brass	Extended T-handle	Green, red, blue plates	For pipes with high insulation thickness
R853VY106	G 1-1/4" M x Ø 35	V - SA - M	Brass	Extended T-handle	Green, red, blue plates	For pipes with high insulation thickness

Product code	DN	A [mm]	I [mm]	B [mm]	J [mm]	C [mm]	H [mm]	Kv
R853VY102	15	86	50	81	17	78	wr.22	12,7
R853VY103	15	86	50	81	17	78	wr.22	12,7
R853VY104	20	99	58	90	21	78	wr.29	24,6
R853VY105	25	107	61	99	25	78	wr.36	48,5
R853VY106	32	120	65	109	30	78	wr.44	98,0

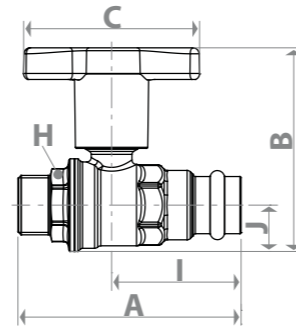
**> R854VT**

Ball valve, with female threaded-press connections (for copper pipe complying with EN 1057; for stainless steel pipe complying with EN 10217-7 and EN 10312; for carbon steel pipe complying with EN 10305-3), for pipes with high insulation thickness, specific for domestic water.

Full port.

Temperature range: 5÷110 °C, possibility of 120 °C for short periods of time
Max. working pressure at 20 °C with water: 3,5 MPa (35 bar) for Ø 15, Ø 18, Ø 22
2,8 MPa (28 bar) for Ø 28, Ø 35

Product code	Connections	Tongs profile	Finishing	Handle type	Handle color	Notes
R854VY102	Rp 1/2" x Ø 18	V - SA - M	Brass	Extended T-handle	Green, red, blue plates	For pipes with high insulation thickness
R854VY103	Rp 1/2" x Ø 15	V - SA - M	Brass	Extended T-handle	Green, red, blue plates	For pipes with high insulation thickness
R854VY104	Rp 3/4" x Ø 22	V - SA - M	Brass	Extended T-handle	Green, red, blue plates	For pipes with high insulation thickness
R854VY105	Rp 1" x Ø 28	V - SA - M	Brass	Extended T-handle	Green, red, blue plates	For pipes with high insulation thickness
R854VY106	Rp 1-1/4" x Ø 35	V - SA - M	Brass	Extended T-handle	Green, red, blue plates	For pipes with high insulation thickness

Product code	DN	A [mm]	I [mm]	B [mm]	J [mm]	C [mm]	H [mm]	Kv
R854VY102	15	80	50	81	17	78	wr.26	12,7
R854VY103	15	80	50	81	17	78	wr.26	12,7
R854VY104	20	92	58	90	21	78	wr.32	24,6
R854VY105	25	102	61	99	25	78	wr.41	48,5
R854VY106	32	112	65	108	30	78	wr.50	98,0

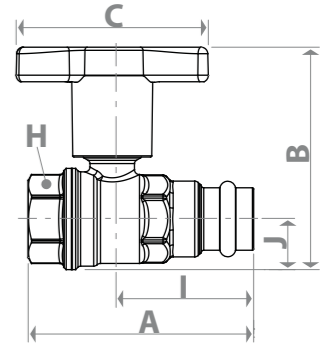
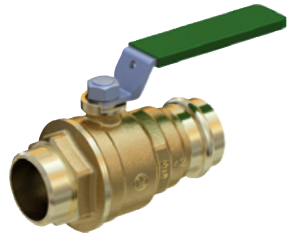
**> R853VWL**

Ball valve, with male threaded-press connections (for copper pipe complying with EN 1057; for stainless steel pipe complying with EN 10217-7 and EN 10312; for carbon steel pipe complying with EN 10305-3), specific for domestic water.

Full port.

Temperature range: 5÷110 °C
Max. working pressure at 20 °C with water: 2,8 MPa (28 bar)

Product code	Connections	Tongs profile	Finishing	Handle type	Handle color
R853VY137	G 1-1/2" M x Ø 42	V	Brass	Large lever	Green
R853VY138	G 2" M x Ø 54	V	Brass	Large lever	Green

Product code	DN	A [mm]	I [mm]	B [mm]	J [mm]	C [mm]	H [mm]	Kv
R853VY137	40	136	76	107	37	137	wr.54	140
R853VY138	50	159	91	122	44	137	wr.67	211

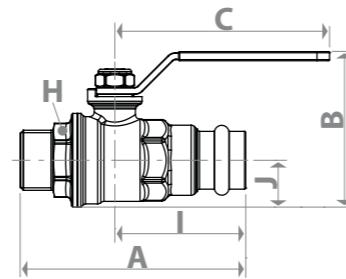
**> R854VWL**

Ball valve, with female threaded-press connections (for copper pipe complying with EN 1057; for stainless steel pipe complying with EN 10217-7 and EN 10312; for carbon steel pipe complying with EN 10305-3), specific for domestic water.

Full port.

Temperature range: 5÷110 °C
Max. working pressure at 20 °C with water: 2,8 MPa (28 bar)

Product code	Connections	Tongs profile	Finishing	Handle type	Handle color
R854VY137	Rp 1-1/2" x Ø 42	V	Brass	Large lever	Green
R854VY138	Rp 2" x Ø 54	V	Brass	Large lever	Green

Product code	DN	A [mm]	I [mm]	B [mm]	J [mm]	C [mm]	H [mm]	Kv
R854VY137	40	131	79	107	37	137	wr.55	140
R854VY138	50	154	91	122	44	137	wr.69	211

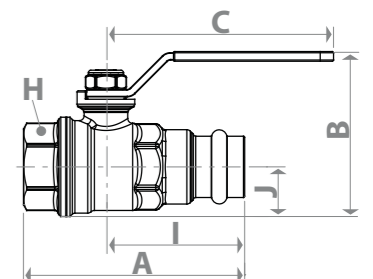

> R859VT

Ball valve, with tail piece male-press connections (for copper pipe complying with EN 1057; for stainless steel pipe complying with EN 10217-7 and EN 10312; for carbon steel pipe complying with EN 10305-3), for pipes with high insulation thickness, specific for domestic water.

Full port.

Temperature range: 5÷110 °C, possibility of 120 °C for short periods of time
 Max. working pressure at 20 °C with water: 3,5 MPa (35 bar) for Ø 15, Ø 18, Ø 22
 2,8 MPa (28 bar) for Ø 28, Ø 35

Product code	Connections	Tongs profile	Finishing	Handle type	Handle color	Notes
R859VY102	R 1/2" x Ø 18	V - SA - M	Brass	Extended T-handle	Green, red, blue plates	For pipes with high insulation thickness
R859VY103	R 1/2" x Ø 15	V - SA - M	Brass	Extended T-handle	Green, red, blue plates	For pipes with high insulation thickness
R859VY104	R 3/4" x Ø 22	V - SA - M	Brass	Extended T-handle	Green, red, blue plates	For pipes with high insulation thickness
R859VY105	R 1" x Ø 28	V - SA - M	Brass	Extended T-handle	Green, red, blue plates	For pipes with high insulation thickness
R859VY106	R 1-1/4" x Ø 35	V - SA - M	Brass	Extended T-handle	Green, red, blue plates	For pipes with high insulation thickness

Product code	DN	A [mm]	I [mm]	B [mm]	J [mm]	C [mm]	H [mm]	Kv
R859VY102	15	112	50	81	17	78	wr.30	12,7
R859VY103	15	112	50	81	17	78	wr.30	12,7
R859VY104	20	127	57	91	21	78	wr.38	24,6
R859VY105	25	135	61	100	26	78	wr.46	48,5
R859VY106	32	150	65	108	30	78	wr.53	98,0

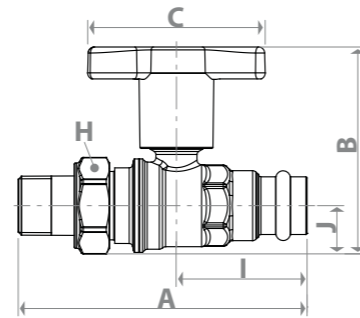

**ASTM / ASME STANDARD AND
 COMPRESSION CONNECTIONS**

NPT, ASME B1.20.1 THREADS

Valves for water for heating/cooling systems, dangerous and not dangerous gas, liquid hydrocarbons

- Valves with threaded connections
- Valves with compression connections

VALVES FOR WATER FOR HEATING/COOLING SYSTEMS, DANGEROUS AND NOT DANGEROUS GAS, LIQUID HYDROCARBONS

> R910



DADO ball valve, with female-female connections.
Full port.

USE WITH WATER AND NOT DANGEROUS GAS

Min. working temperature: -20 °C with 50 % glycol solutions
Max. working temperature with dry saturated steam: 185 °C with 1,05 MPa (10,5 bar)
Max. working pressure at 20 °C with water and not dangerous gas: 4,2 MPa (42 bar) for 1/4", 1/2", 3/4"
3,5 MPa (35 bar) for 1", 1-1/4", 1-1/2", 2"
2,8 MPa (28 bar) for 2-1/2", 3", 4"

USE WITH GAS AND LIQUID HYDROCARBONS

Temperature range: -20+60 °C
Max. working pressure at 20 °C with liquid hydrocarbons*: 1,2 MPa (12 bar)
Max. operating pressure (MOP) with gas: 0,5 MPa (5 bar)

* Please consult Giacomini technical support, to check the compatibility of the product with the specific hydrocarbon.

i For information about product certification (applicability, field of use, terms of approval), please contact Giacomini technical support.

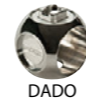

DADO

> R850



Ball valve, with female-female connections.
Full port.

USE WITH WATER AND NOT DANGEROUS GAS

Min. working temperature: -20 °C with 50 % glycol solutions
Max. working temperature with dry saturated steam: 185 °C with 1,05 MPa (10,5 bar)
Max. working pressure at 20 °C with water and not dangerous gas: 3,5 MPa (35 bar) for 1/4", 3/8", 1/2", 3/4"
2,8 MPa (28 bar) for 1", 1-1/4", 1-1/2", 2"

USE WITH GAS AND LIQUID HYDROCARBONS

Temperature range: -20+60 °C
Max. working pressure at 20 °C with liquid hydrocarbons*: 1,2 MPa (12 bar)
Max. operating pressure (MOP) with gas: 0,5 MPa (5 bar)

* Please consult Giacomini technical support, to check the compatibility of the product with the specific hydrocarbon.

i For information about product certification (applicability, field of use, terms of approval), please contact Giacomini technical support.

Product code	Connections	Finishing	Handle type	Handle color	Notes
R910UY001	1/4"NPT-F x 1/4"NPT-F	Brass	Lever	Red	DADO ball
R910UY003	1/2"NPT-F x 1/2"NPT-F	Brass	Large lever	Red	DADO ball
R910UY004	3/4"NPT-F x 3/4"NPT-F	Brass	Large lever	Red	DADO ball
R910UY005	1"NPT-F x 1"NPT-F	Brass	Large lever	Red	DADO ball
R910UY006	1-1/4"NPT-F x 1-1/4"NPT-F	Brass	Large lever	Red	DADO ball
R910UY007	1-1/2"NPT-F x 1-1/2"NPT-F	Brass	Large lever	Red	DADO ball
R910UY008	2"NPT-F x 2"NPT-F	Brass	Large lever	Red	DADO ball
R910UY009	2-1/2"NPT-F x 2-1/2"NPT-F	Brass	Lever	Red	DADO ball
R910UY010	3"NPT-F x 3"NPT-F	Brass	Lever	Red	DADO ball
R910UY011	4"NPT-F x 4"NPT-F	Brass	Lever	Red	DADO ball
R910UX023	1/2"NPT-F x 1/2"NPT-F	Nickel plated brass	Large lever	Yellow	DADO ball
R910UX024	3/4"NPT-F x 3/4"NPT-F	Nickel plated brass	Large lever	Yellow	DADO ball
R910UX025	1"NPT-F x 1"NPT-F	Nickel plated brass	Large lever	Yellow	DADO ball
R910UX026	1-1/4"NPT-F x 1-1/4"NPT-F	Nickel plated brass	Large lever	Yellow	DADO ball
R910UX027	1-1/2"NPT-F x 1-1/2"NPT-F	Nickel plated brass	Large lever	Yellow	DADO ball
R910UX028	2"NPT-F x 2"NPT-F	Nickel plated brass	Large lever	Yellow	DADO ball
R910UX029	2-1/2"NPT-F x 2-1/2"NPT-F	Nickel plated brass	Lever	Yellow	DADO ball
R910UX030	3"NPT-F x 3"NPT-F	Nickel plated brass	Lever	Yellow	DADO ball

Product code	DN	A [mm]	I [mm]	B [mm]	J [mm]	C [mm]	H [mm]	Kv
R910UY001	8	43	21	37	10	43	wr.17	6,9
R910UY003	15	57	28	53	16	77	wr.25	13,3
R910UY004	20	62	31	70	21	95	wr.32	25,8
R910UY005	25	76	38	78	25	95	wr.39	50,9
R910UY006	32	86	43	88	30	95	wr.47	103
R910UY007	40	97	48	109	37	137	wr.54	147
R910UY008	50	111	55	125	46	137	wr.67	222
R910UY009	65	153	76	170	58	187	wr.82	336
R910UY010	80	173	87	189	68	187	wr.96	377
R910UY011	100	217	108	242	88	257	wr.126	645
R910UX023	15	57	28	53	16	77	wr.25	13,3
R910UX024	20	62	31	70	21	95	wr.32	25,8
R910UX025	25	76	38	78	25	95	wr.39	50,9
R910UX026	32	86	43	88	30	95	wr.47	103
R910UX027	40	97	48	109	37	137	wr.54	147
R910UX028	50	111	55	125	46	137	wr.67	222
R910UX029	65	153	76	170	58	187	wr.82	336
R910UX030	80	173	87	189	68	187	wr.96	377

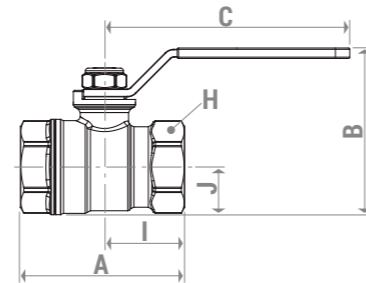

Product code	Connections	Finishing	Handle type	Handle color
R850UY001	1/4"NPT-F x 1/4"NPT-F	Brass	Lever	Red
R850UY002	3/8"NPT-F x 3/8"NPT-F	Brass	Lever	Red
R850UY003	1/2"NPT-F x 1/2"NPT-F	Brass	Lever	Red
R850UY004	3/4"NPT-F x 3/4"NPT-F	Brass	Lever	Red
R850UY005	1"NPT-F x 1"NPT-F	Brass	Lever	Red
R850UY006	1-1/4"NPT-F x 1-1/4"NPT-F	Brass	Lever	Red
R850UY007	1-1/2"NPT-F x 1-1/2"NPT-F	Brass	Lever	Red
R850UY008	2"NPT-F x 2"NPT-F	Brass	Lever	Red
R850UY093	1/2"NPT-F x 1/2"NPT-F	Brass	Lever	Blue
R850UY094	3/4"NPT-F x 3/4"NPT-F	Brass	Lever	Blue
R850UY095	1"NPT-F x 1"NPT-F	Brass	Lever	Blue
R850UY096	1-1/4"NPT-F x 1-1/4"NPT-F	Brass	Lever	Blue
R850UY097	1-1/2"NPT-F x 1-1/2"NPT-F	Brass	Lever	Blue
R850UY098	2"NPT-F x 2"NPT-F	Brass	Lever	Blue

Product code	DN	A [mm]	I [mm]	B [mm]	J [mm]	C [mm]	H [mm]	Kv
R850UY001	8	43	21	36	10	43	wr.17	6,6
R850UY002	10	46	23	45	13	77	wr.20	6,7
R850UY003	15	53	27	51	16	77	wr.25	12,7
R850UY004	20	60	30	67	20	95	wr.31	24,6
R850UY005	25	74	37	76	25	95	wr.38	48,5
R850UY006	32	84	42	85	29	95	wr.47	98,0
R850UY007	40	95	47	104	35	137	wr.54	140
R850UY008	50	109	54	120	43	137	wr.66	211
R850UY093	15	53	27	51	16	77	wr.25	12,7
R850UY094	20	60	30	67	20	95	wr.31	24,6
R850UY095	25	74	37	76	25	95	wr.38	48,5
R850UY096	32	84	42	85	29	95	wr.47	98,0
R850UY097	40	95	47	104	35	137	wr.54	140
R850UY098	50	109	54	120	43	137	wr.66	211

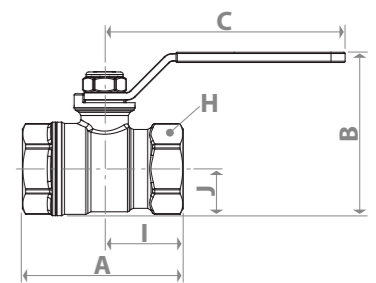

> R250D



Ball valve, with female-female connections.
Standard port.

USE WITH WATER AND NOT DANGEROUS GAS

Min. working temperature: -20 °C with 50 % glycol solutions

Max. working temperature with dry saturated steam: 185 °C with 1,05 MPa (10,5 bar)

Max. working pressure at 20 °C with water and not dangerous gas: 4,2 MPa (42 bar) for 1/4", 3/8", 1/2", 3/4"
3,5 MPa (35 bar) for 1", 1-1/4", 1-1/2", 2"
2,8 MPa (28 bar) for 2-1/2", 3", 4"

USE WITH GAS AND LIQUID HYDROCARBONS

Temperature range: -20÷60 °C

Max. working pressure at 20 °C with liquid hydrocarbons*: 1,2 MPa (12 bar)

Max. operating pressure (MOP) with gas: 0,5 MPa (5 bar)

* Please consult Giacomini technical support, to check the compatibility of the product with the specific hydrocarbon.

i For information about product certification (applicability, field of use, terms of approval), please contact Giacomini technical support.

Product code	Connections	Finishing	Handle type	Handle color
R250UY001	1/4"NPT-F x 1/4"NPT-F	Brass	Lever	Red
R250UY002	3/8"NPT-F x 3/8"NPT-F	Brass	Lever	Red
R250UY003	1/2"NPT-F x 1/2"NPT-F	Brass	Lever	Red
R250UY004	3/4"NPT-F x 3/4"NPT-F	Brass	Lever	Red
R250UY005	1"NPT-F x 1"NPT-F	Brass	Lever	Red
R250UY006	1-1/4"NPT-F x 1-1/4"NPT-F	Brass	Lever	Red
R250UY007	1-1/2"NPT-F x 1-1/2"NPT-F	Brass	Lever	Red
R250UY008	2"NPT-F x 2"NPT-F	Brass	Lever	Red
R250UY009	2-1/2"NPT-F x 2-1/2"NPT-F	Brass	Lever	Red
R250UY010	3"NPT-F x 3"NPT-F	Brass	Lever	Red
R250UY011	4"NPT-F x 4"NPT-F	Brass	Lever	Red

Product code	DN	A [mm]	I [mm]	B [mm]	J [mm]	C [mm]	H [mm]	Kv
R250UY001	8	43	21	36	10	43	wr.17	6,6
R250UY002	10	45	22	46	14	77	wr.21	6,7
R250UY003	14	54	27	49	15	77	wr.25	10,2
R250UY004	18	63	31	64	18	94	wr.32	18,5
R250UY005	22	75	38	73	23	94	wr.39	36,3
R250UY006	28	84	42	82	28	94	wr.48	73,5
R250UY007	35	93	46	100	33	136	wr.55	105
R250UY008	45	107	54	115	41	136	wr.67	158
R250UY009	58	146	73	154	52	173	wr.82	240
R250UY010	68	160	80	169	60	173	wr.98	269
R250UY011	90	207	104	207	77	187	wr.122	461

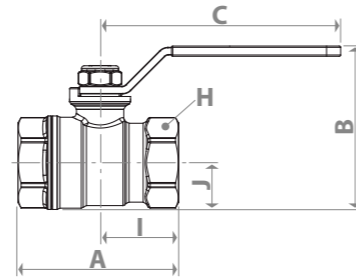

> R258CC



Ball valve, with compression connections for copper pipes.
Standard port.

USE WITH WATER AND NOT DANGEROUS GAS

Min. working temperature: -20 °C with 50 % glycol solutions

Max. working temperature with dry saturated steam: 185 °C with 1,05 MPa (10,5 bar)

Max. working pressure at 20 °C with water and not dangerous gas: 4,2 MPa (42 bar) for 1/2", 3/4"
3,5 MPa (35 bar) for 1"

USE WITH GAS AND LIQUID HYDROCARBONS

Temperature range: -20÷60 °C

Max. working pressure at 20 °C with liquid hydrocarbons*: 1,2 MPa (12 bar)

Max. operating pressure (MOP) with gas: 0,5 MPa (5 bar)

* Please consult Giacomini technical support, to check the compatibility of the product with the specific hydrocarbon.

i For information about product certification (applicability, field of use, terms of approval), please contact Giacomini technical support.

Product code	Connections	Finishing	Handle type	Handle color
R258CX052	1/2" x 1/2"	Chrome plated brass	Lever	Red
R258CX055	3/4" x 3/4"	Chrome plated brass	Lever	Red
R258CX056	1" x 1"	Chrome plated brass	Lever	Red
R258CX062	1/2" x 1/2"	Chrome plated brass	Lever	Yellow
R258CX065	3/4" x 3/4"	Chrome plated brass	Lever	Yellow
R258CX066	1" x 1"	Chrome plated brass	Lever	Yellow

Product code	DN	A [mm]	I [mm]	B [mm]	J [mm]	C [mm]	H [mm]	Kv
R258CX052	14	72	32	49	15	77	wr.24	10,2
R258CX055	18	88	40	64	18	94	wr.32	18,5
R258CX056	22	97	45	73	23	94	wr.39	36,3
R258CX062	14	72	32	49	15	77	wr.24	10,2
R258CX065	18	88	40	64	18	94	wr.32	18,5
R258CX066	22	97	45	73	23	94	wr.39	36,3

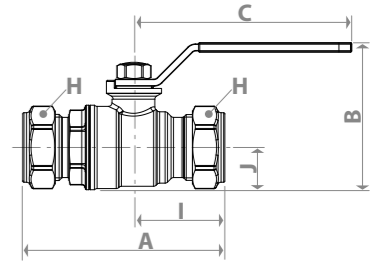

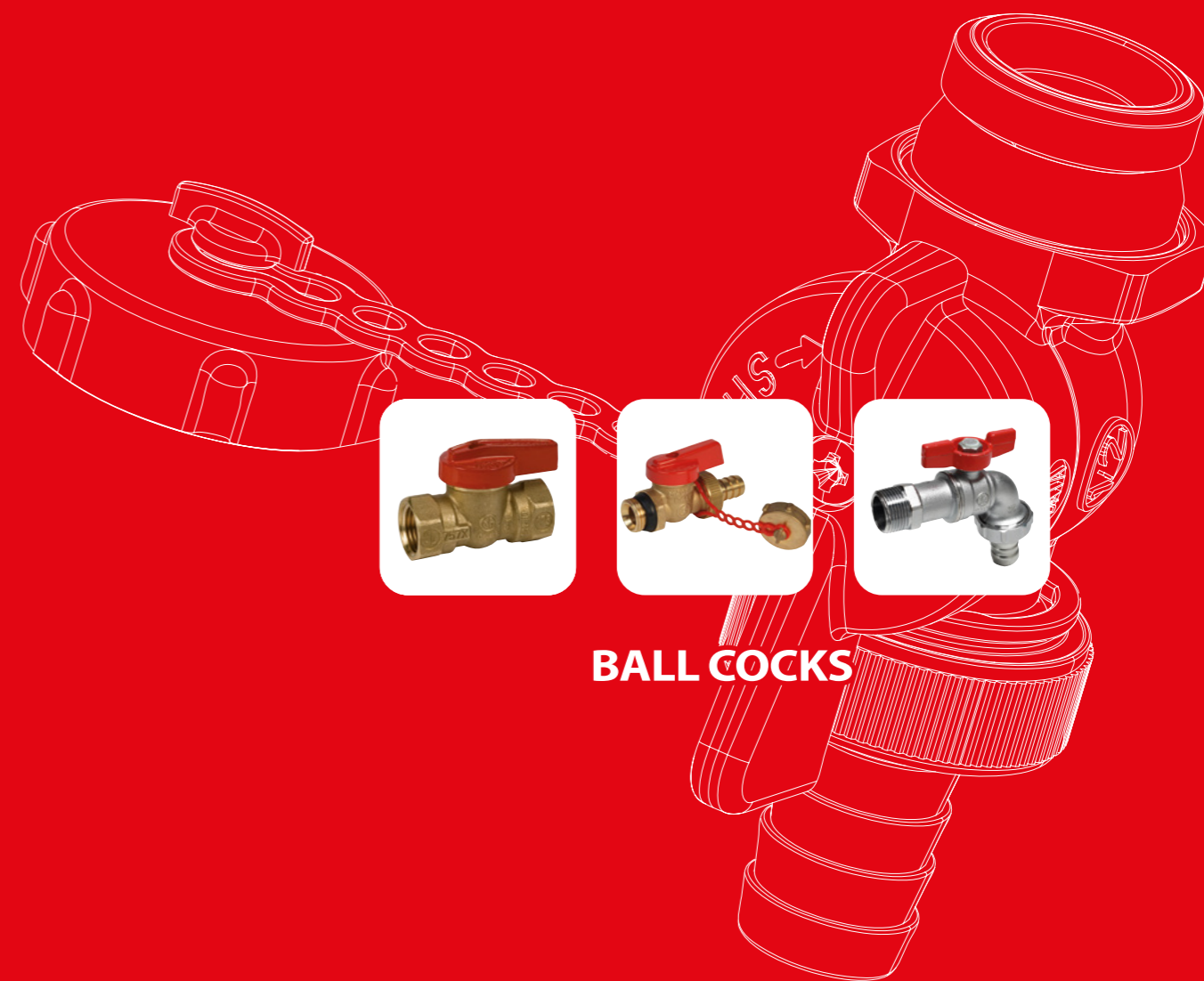
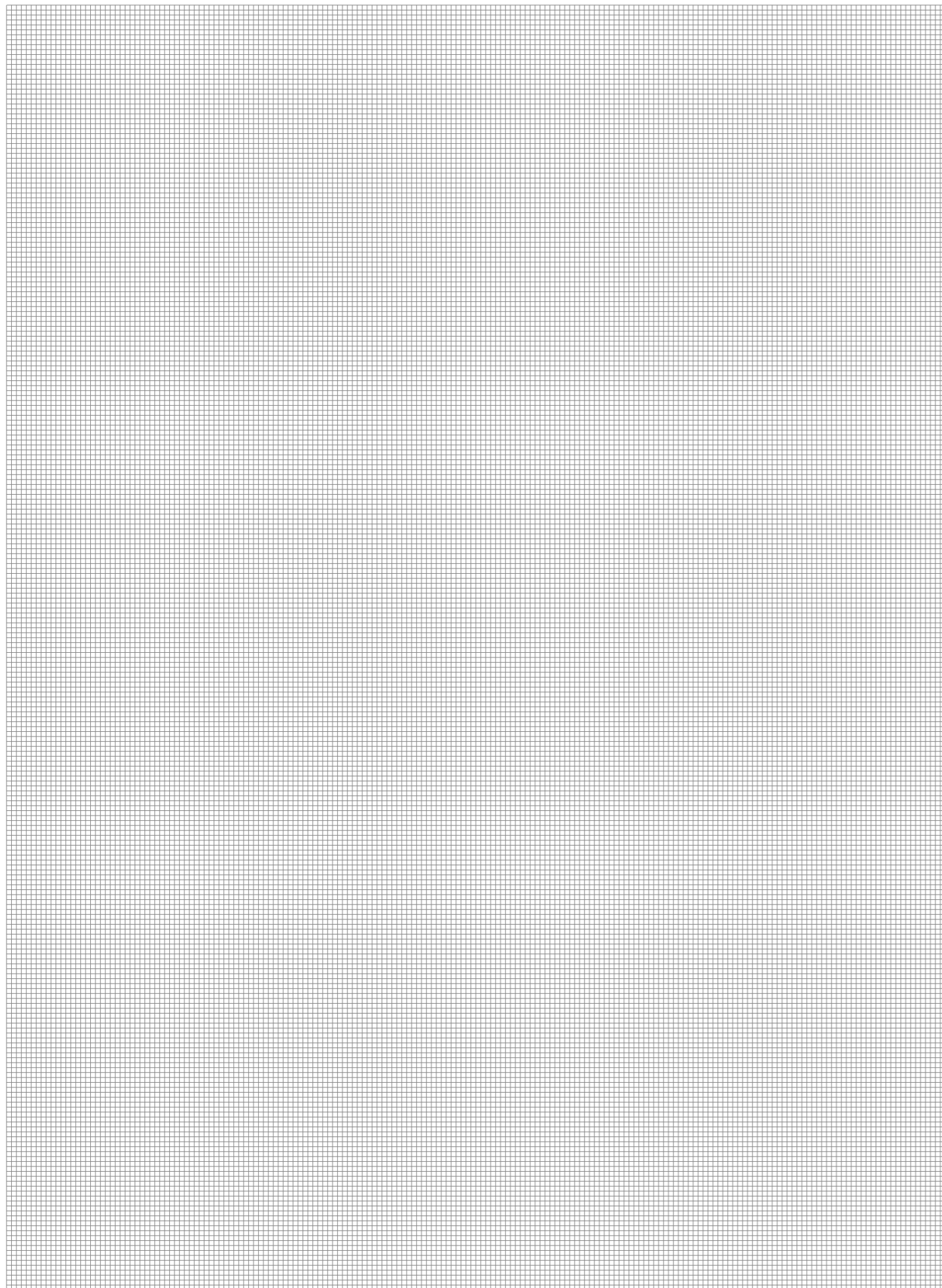

BALL COCKS

Cocks for water for heating/cooling systems

Under-sink and washing machine cocks

Hose Bibs

COCKS FOR WATER FOR HEATING/COOLING SYSTEMS

> R248M



Ball cock, with male-male threaded connections.
Standard port.
Min. working temperature: -20 °C with 50 % glycol solutions
Max. working temperature: 90 °C
Max. working pressure at 20 °C with water: 1,6 MPa (16 bar)

Product code	Connections	Finishing	Handle type	Handle color	Notes
R248X023	R 1/2" x G 3/4" M flat seat	Chrome plated brass	T-handle, one lug	Red	With cap
R248Y023	R 1/2" x G 3/4" M flat seat	Brass	T-handle, one lug	Red	With cap

Product code	DN	A [mm]	B [mm]	C [mm]	D [mm]	E [mm]	F [mm]	G [mm]	H [mm]	Kv
R248X023	14	1/2"	3/4"	65	29	51	44	wr.22	140	10,2
R248Y023	14	1/2"	3/4"	65	29	51	44	wr.22	140	10,2

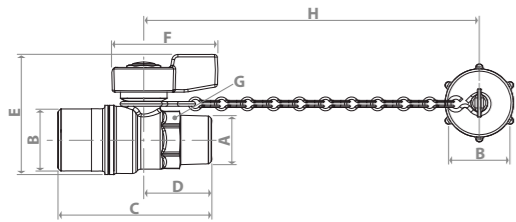

> R248F



Ball cock, with female-male threaded connections.
Standard port.
Min. working temperature: -20 °C with 50 % glycol solutions
Max. working temperature: 90 °C
Max. working pressure at 20 °C with water: 1,6 MPa (16 bar)

Product code	Connections	Finishing	Handle type	Handle color	Notes
R248X024	G 1/2" F x G 3/4" M flat seat	Chrome plated brass	T-handle, one lug	Red	With cap
R248Y024	G 1/2" F x G 3/4" M flat seat	Brass	T-handle, one lug	Red	With cap

Product code	DN	A [mm]	B [mm]	C [mm]	D [mm]	E [mm]	F [mm]	G [mm]	H [mm]	Kv
R248X024	14	1/2"	3/4"	63	27	51	44	wr.25	140	10,2
R248Y024	14	1/2"	3/4"	63	27	51	44	wr.25	140	10,2

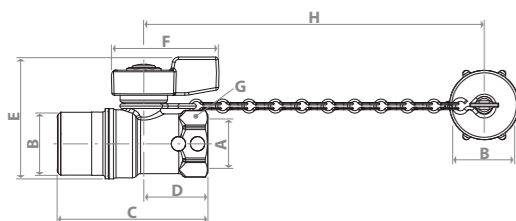

> R602



Ball cock, with female-female threaded connections.
Standard port.
Min. working temperature: -20 °C with 50 % glycol solutions
Max. working temperature: 90 °C
Max. working pressure at 20 °C with water and not dangerous gas: 1,0 MPa (10 bar)

Product code	Connections	Finishing	Handle type	Handle color
R602Y003	G 1/2" F x G 1/2" F	Brass	Short lever	Red

Product code	DN	A [mm]	B [mm]	C [mm]	D [mm]	E [mm]	F [mm]	Kv
R602Y003	10	59	29,5	47	33	wr.25	35	6,7

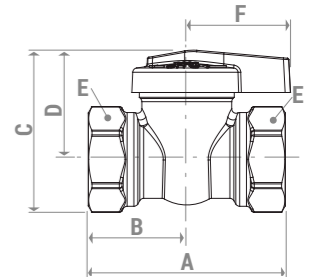

> R608



Ball cock, with male threaded connection-hose connection.
For opening and closing operations use a screwdriver or a 5 mm Allen wrenwr.
Standard port.
Min. working temperature: -20 °C with 50 % glycol solutions
Max. working temperature: 90 °C
Max. working pressure at 20 °C with water and not dangerous gas: 1,0 MPa (10 bar)

Product code	Connections	Finishing	Handle type	Notes
R608Y012	R 3/8" x Hose connection Ø 15 mm	Brass	Screwdriver bonnet	With hose connection, nut and cap
R608Y013	R 1/2" x Hose connection Ø 15 mm	Brass	Screwdriver bonnet	With hose connection, nut and cap
R608Y014	R 3/4" x Hose connection Ø 18 mm	Brass	Screwdriver bonnet	With hose connection, nut and cap

Product code	DN	A [mm]	B [mm]	C [mm]	D [mm]	E [mm]	Kv
R608Y012	10	75	29	33	22	1/2" F (G, ISO 228)	6,7
R608Y013	10	78	30	36	22	3/4" F (G, ISO 228)	6,7
R608Y014	15	89	36	40	25	3/4" F (G, ISO 228)	12,7

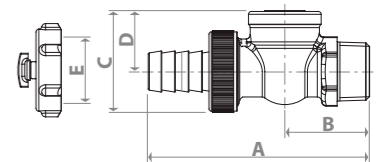

> R608D



Ball cock, with self-sealing male threaded connection-hose connection.
Standard port.
Min. working temperature: -20 °C with 50 % glycol solutions
Max. working temperature: 90 °C
Max. working pressure at 20 °C with water and not dangerous gas: 1,0 MPa (10 bar)

Product code	Connections	Finishing	Handle type	Handle color	Notes
R608DY053	G 1/2" M x Hose connection Ø 15 mm	Brass	Short lever	Red	With hose connection, nut and cap

Product code	DN	A [mm]	B [mm]	C [mm]	D [mm]	E [mm]	F [mm]	Kv
R608DY053	10	78	30	49	35	G 3/4" F	35	6,7

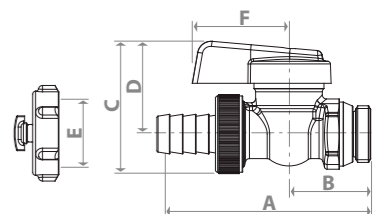

> R609



Ball cock, with female-male threaded connections.
For opening and closing operations use a screwdriver or a 5 mm Allen wrenwr.
Standard port.
Min. working temperature: -20 °C with 50 % glycol solutions
Max. working temperature: 90 °C
Max. working pressure at 20 °C with water and not dangerous gas: 1,0 MPa (10 bar)

Product code	Connections	Finishing	Handle type
R609Y012	G 3/8"F x R 3/8"	Brass	Screwdriver bonnet
R609Y013	G 1/2"F x R 1/2"	Brass	Screwdriver bonnet
R609Y014	G 3/4"F x R 3/4"	Brass	Screwdriver bonnet

Product code	DN	A [mm]	B [mm]	C [mm]	D [mm]	E [mm]	F [mm]	Kv
R609Y012	10	54	29	34	22	wr.22	-	6,7
R609Y013	10	57	30	36	22	wr.26	-	6,7
R609Y014	15	67	36	43	25	wr.32	-	12,7

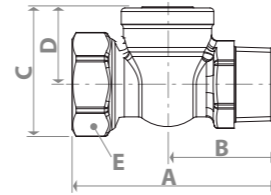

> R611



Ball cock, with female-female threaded connections.
For opening and closing operations use a screwdriver or a 5 mm Allen wrenwr.
Standard port.
Min. working temperature: -20 °C with 50 % glycol solutions
Max. working temperature: 90 °C
Max. working pressure at 20 °C with water and not dangerous gas: 1,0 MPa (10 bar)

Product code	Connections	Finishing	Handle type
R611Y012	G 3/8"F x G 3/8"F	Brass	Screwdriver bonnet
R611Y013	G 1/2"F x G 1/2"F	Brass	Screwdriver bonnet
R611Y014	G 3/4"F x G 3/4"F	Brass	Screwdriver bonnet

Product code	DN	A [mm]	B [mm]	C [mm]	D [mm]	E [mm]	Kv
R611Y012	10	49	24,5	33	22	wr.22	6,7
R611Y013	10	53	26,5	36	22	wr.26	6,7
R611Y014	15	61	30,5	43	25	wr.32	12,7

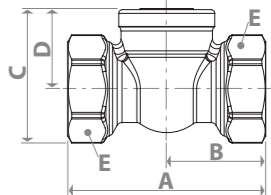

> R610



Ball cock, with male-male threaded connections.
For opening and closing operations use a screwdriver or a 5 mm Allen wrenwr.
Standard port.
Min. working temperature: -20 °C with 50 % glycol solutions
Max. working temperature: 90 °C
Max. working pressure at 20 °C with water and not dangerous gas: 1,0 MPa (10 bar)

Product code	Connections	Finishing	Handle type
R610Y003	G 1/2"M x G 1/2"M	Brass	Screwdriver bonnet

Product code	DN	A [mm]	B [mm]	C [mm]	D [mm]	Kv
R610Y003	10	60	30	34	22	6,7

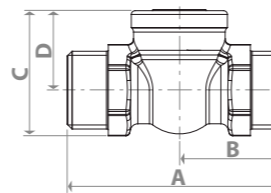

> R612



Ball cock, with male threaded connection-base for adaptor.
For opening and closing operations use a screwdriver or a 5 mm Allen wrenwr.
Standard port.
Min. working temperature: -20 °C with 50 % glycol solutions
Max. working temperature: 90 °C
Max. working pressure at 20 °C with water and not dangerous gas: 1,0 MPa (10 bar)

Product code	Connections	Finishing	Handle type
R612Y003	R 1/2" x B.16	Brass	Screwdriver bonnet

Product code	DN	A [mm]	B [mm]	C [mm]	D [mm]	Kv
R612Y003	10	57	30	34	22	6,7

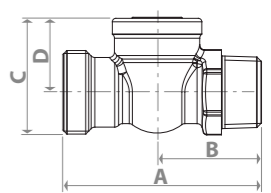

UNDER-SINK AND WASHING MACHINE COCKS

> R613



Under-sink ball cock, with male-male threaded connections.
Standard port.
Min. working temperature: 5 °C
Max. working temperature: 70 °C (possibility of 90 °C for short periods of time)
Max. working pressure at 20 °C with water: 1,0 MPa (10 bar)

Product code	Connections	Finishing	Handle type	Handle color	Notes
R613X003	G 1/2"M x G 1/2"M	Chrome plated brass	Plastic handle	Chrome plated	With chrome plated cover plate

Product code	DN	A [mm]	B [mm]	C [mm]	D [mm]	E [mm]	F [mm]	Kv
R613X003	6	G 1/2"M	1/2"M	Ø 55	47	30	26	0,95

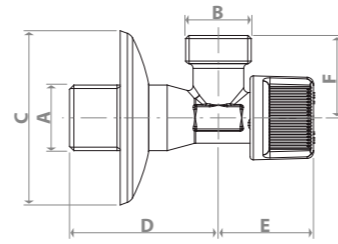

> R614



Washing machine ball cock, with male-male threaded connections.
Standard port.
Min. working temperature: 5 °C
Max. working temperature: 70 °C (possibility of 90 °C for short periods of time)
Max. working pressure at 20 °C with water: 1,0 MPa (10 bar)

Product code	Connections	Finishing	Handle type	Handle color	Notes
R614X004	G 1/2"M x G 3/4"M	Chrome plated brass	Plastic handle	Chrome plated	With chrome plated cover plate

Product code	DN	A [mm]	B [mm]	C [mm]	D [mm]	E [mm]	F [mm]	Kv
R614X004	8	G 1/2"M	3/4"M	Ø 55	60	29	28	1,7

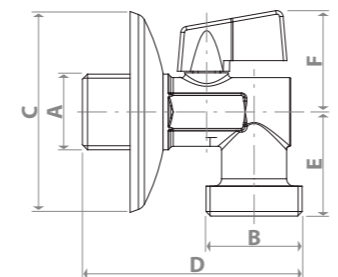

HOSE BIBS

> R619



Hose Bib, with male threaded connection-hose connection.
Standard port.
Min. working temperature: 5 °C
Max. working temperature: 90 °C
Max. working pressure at 20 °C with water: 1,0 MPa (10 bar)

Product code	Connections	Finishing	Handle type	Handle color
R619IX103	R 1/2" x Hose connection Ø 15 mm	Chrome plated brass	Short lever	Red

Product code	DN	A [mm]	B [mm]	C [mm]	D [mm]	E [mm]	F [mm]	G [mm]	Kv
R619IX103	10	R 1/2"	Ø 15	62	25	51	31	37	6,7

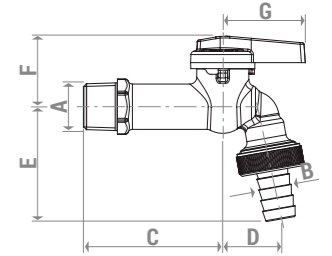

> R620



Hose Bib, with male threaded connection-hose connection.
Standard port.
Min. working temperature: 5 °C
Max. working temperature: 90 °C
Max. working pressure at 20 °C with water: 1,0 MPa (10 bar)

Product code	Connections	Finishing	Handle type	Handle color
R620X003	R 1/2" x Hose connection Ø 15 mm	Chrome plated brass	T-handle	Red
R620X014	R 3/4" x Hose connection Ø 20 mm	Chrome plated brass	T-handle	Red
R620X015	R 1" x Hose connection Ø 26 mm	Chrome plated brass	T-handle	Red

Product code	DN	A [mm]	B [mm]	C [mm]	D [mm]	E [mm]	F [mm]	G [mm]	Kv
R620X003	10	R 1/2"	Ø 15	52	30	52	29	64	6,7
R620X014	15	R 3/4"	Ø 20	58	37	63	38	62	12,7
R620X015	18	R 1"	Ø 26	74	44	74	42	72	18,5

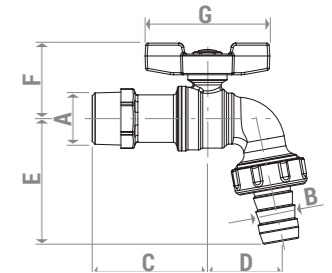

> R621



Hose Bib, with male threaded connection-hose connection.
Standard port.
Min. working temperature: 5 °C
Max. working temperature: 90 °C
Max. working pressure at 20 °C with water: 1,0 MPa (10 bar)

Product code	Connections	Finishing	Handle type	Handle color
R621X003	R 1/2" x Hose connection Ø 15 mm	Chrome plated brass	Lever	Red
R621X014	R 3/4" x Hose connection Ø 20 mm	Chrome plated brass	Lever	Red
R621X015	R 1" x Hose connection Ø 26 mm	Chrome plated brass	Lever	Red

Product code	DN	A [mm]	B [mm]	C [mm]	D [mm]	E [mm]	F [mm]	G [mm]	Kv
R621X003	10	R 1/2"	Ø 15	52	30	52	29	76	6,7
R621X014	15	R 3/4"	Ø 20	58	37	63	38	76	12,7
R621X015	18	R 1"	Ø 26	74	44	74	42	94	18,5

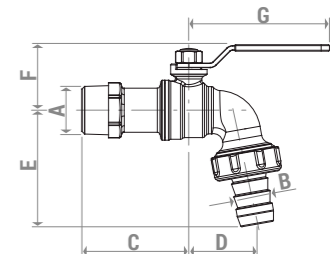

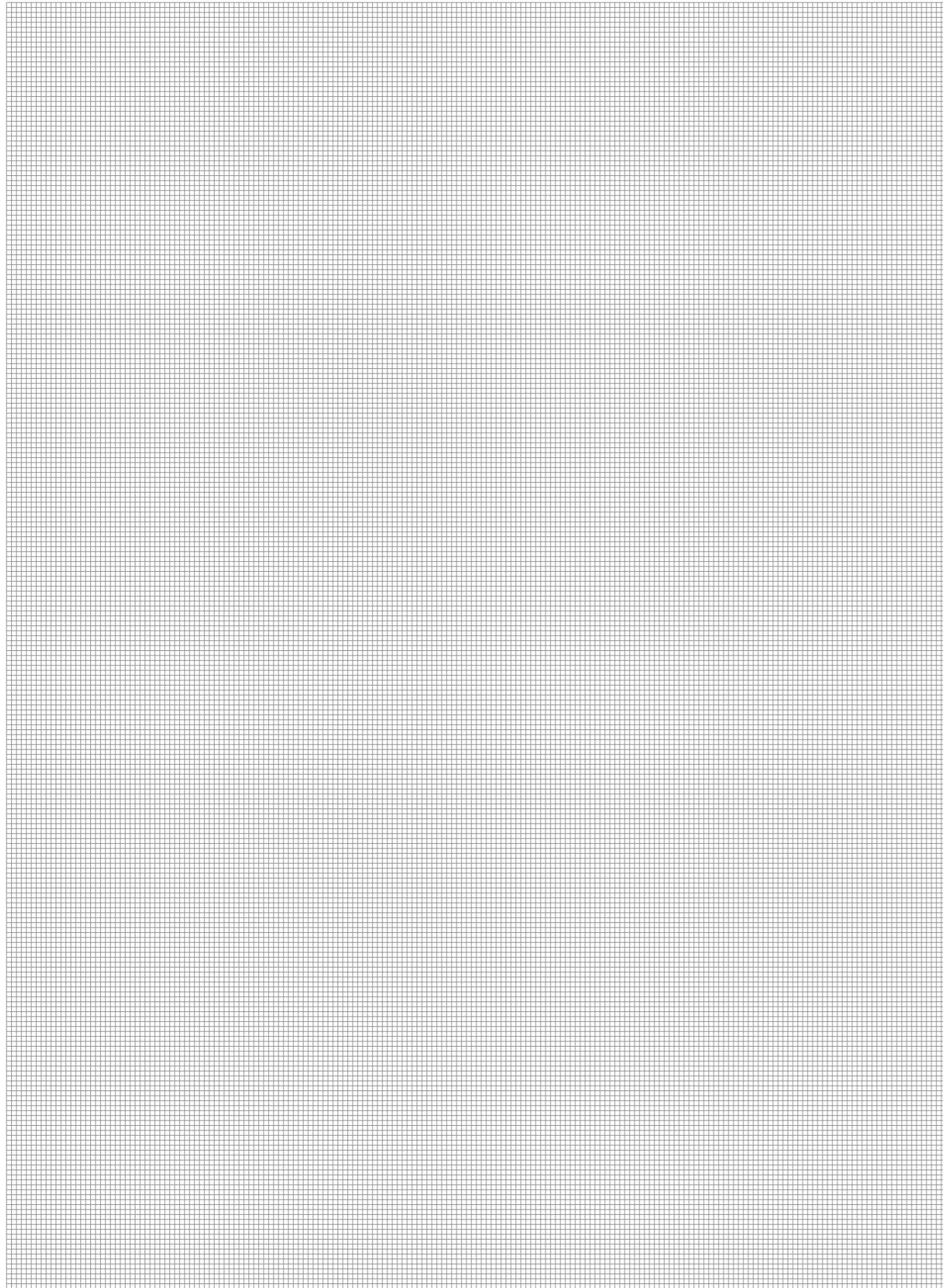

ACCESSORIES

> **R749T**



Cylinder extension for ball valves

Product code	Size	Finishing	Height [mm]
R749TX101	For all the ball valves of 3/8", 1/2"	Chrome plated brass	50
R749TX102	For all the ball valves of 3/4", 1", 1 1/4"	Chrome plated brass	61
R749TX103	For all the ball valves of 1 1/2", 2"	Chrome plated brass	81
R749TX004	For ball valves R850, R250D of 2 1/2", 3"	Chrome plated brass	93
R749TX005	For valves R910 of 2 1/2", 3", 4" and valves R850, R250D of 4"	Chrome plated brass	107
R749TY101	For all the ball valves of 3/8", 1/2"	Brass	50
R749TY102	For all the ball valves of 3/4", 1", 1 1/4"	Brass	61
R749TY103	For all the ball valves of 1 1/2", 2"	Brass	81
R749TY004	For ball valves R850, R250D of 2 1/2", 3"	Brass	93
R749TY005	For valves R910 of 2 1/2", 3", 4" and valves R850, R250D of 4"	Brass	107

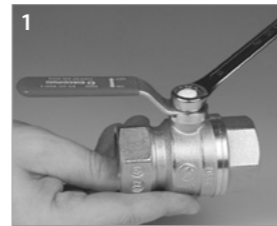

1 Loosen the nut with the proper wrench



2 Remove the lever and insert the new PTFE stuffing box ring (included in the package) without removing the preassembled one



3 Install the cylindrical extension placing it on the ball valve rod and paying attention to the opening direction

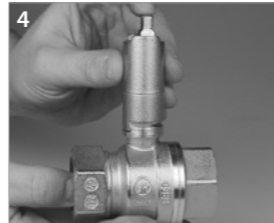

4 Screw the extension central pin on the ball valve rod and tighten completely using the ball valve lever



5 Insert the brass washer (included in the package)

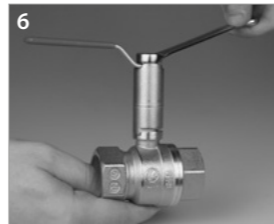

6 Install the lever and tighten the nut with the proper wrench

> **R749F**



Extended T-handle, for ball valves, with red, blue and green plates.
Temperature range: -20÷110 °C

Product code	Size	Material	Height [mm]
R749FY001	For all the ball valves of 3/8", 1/2"	Plastic	45
R749FY002	For all the ball valves of 3/4", 1", 1 1/4"	Plastic	45
R749FY003	For all the ball valves of 1 1/2", 2"	Plastic	65



1 Remove the nut with the proper wrench



2 Remove the lever



3 Fit the extended handle



4 Tighten the nut completely using the proper socket wrench



5 Fit the cover plate

> **R747**



Locking device for ball valves with lever handle

1 Not suitable for valves with large lever

Product code	Size
R747Y001	3/8" - 1/2"
R747Y002	3/4", 1", 1 1/4"
R747Y003	1 1/2" - 2"

> **R747N**



Locking device for ball valves with lever handle

Product code	Size
R747NY004	2 1/2" - 3"
R747NY005	4"

> **R37**



Fittings for the connection of the meters.
Temperature range: 5÷110 °C
Max. working pressure: 10 bar

Product code	Size	Finishing
R37X003	R 1/2" x G 3/4"F Nut	Chrome plated brass
R37X004	R 1/2" x G 3/4"F Nut	Chrome plated brass
R37Y003	R 1/2" x G 3/4"F Nut	Brass
R37Y004	R 1/2" x G 3/4"F Nut	Brass

> **P18L**



Brass nut, female threaded, for R285, R285L ball valves

Product code	Size
P18LY007	For R285, R285L of 1 1/2"
P18LY009	For R285, R285L of 2"

> **R540F**



Contact thermometer for R749F T-handles.
Scale 0÷120 °C, Ø 40 mm.

Product code	Color
R540FY002	Red
R540FY022	Blue

> **R288**



Plastic check valve for R285, R285L, R285F ball valves.
Max. working temperature: 100 °C
Max. working pressure: 16 bar

Product code	Size
R288Y005	1" - For R285Y001, R285Y002, R285LY001, R285FY001
R288Y006	1 1/4" - For R285Y003, R285LY003, R285FY003

⚠ Safety Warning. Installation, commissioning and periodical maintenance of the product must be carried out by qualified operators in compliance with national regulations and/or local standards. A qualified installer must take all required measures, including use of Individual Protection Devices, for his and others' safety. An improper installation may damage people, animals or objects towards which Giacomini S.p.A. may not be held liable.

♻ Package Disposal. Carton boxes: paper recycling. Plastic bags and bubble wrap: plastic recycling.

ℹ Additional information. For more information, go to giacomini.com or contact our technical assistance service. This document provides only general indications. Giacomini S.p.A. may change at any time, without notice and for technical or commercial reasons, the items included herewith. The information included in this technical sheet do not exempt the user from strictly complying with the rules and good practice standards in force.

♻ Product Disposal. Do not dispose of product as municipal waste at the end of its life cycle. Dispose of product at a special recycling platform managed by local authorities or at retailers providing this type of service.