

R854



Energy  
Management

Datasheet  
0639EN 02/2025

# Ball valve for water for heating systems, full port

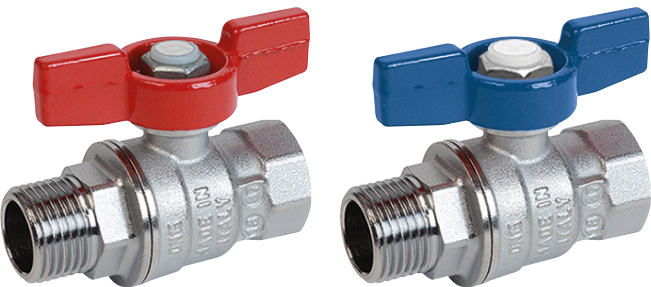

Ball valve, with female-male threaded connections.  
Full port.

## Versions and product codes

PRODUCT CODE	CONNECTIONS	FINISHING	HANDLE TYPE	HANDLE COLOR
R854X023	G 1/2"F x G 1/2"M	Chrome plated brass	T-handle	Red
R854X024	G 3/4"F x 3/4"M	Chrome plated brass	T-handle	Red
R854X025	G 1"F x G 1"M	Chrome plated brass	T-handle	Red
R854X026	G 1-1/4"F x G 1-1/4"M	Chrome plated brass	T-handle	Red
R854X043	G 1/2"F x G 1/2"M	Chrome plated brass	T-handle	Blue
R854X044	G 3/4"F x 3/4"M	Chrome plated brass	T-handle	Blue
R854X045	G 1"F x G 1"M	Chrome plated brass	T-handle	Blue

## Technical data

### Main features and materials

- Suitable for water for heating/cooling systems, not dangerous gas and liquid hydrocarbons\*
- Full port
- Valve made of UNI EN 12165 CW617N chrome plated brass
- Stem with double O-Ring
- Nut with anti-corrosion coating, with guarantee seal and hologram
- Aluminium T-handle, red or blue painted

\* Please consult Giacomini technical support, to check the compatibility of the product with the specific hydrocarbon.

### Field of applications

- Min. working temperature: -20 °C with 50 % glycol solutions
- Max. working temperature with dry saturated steam: 185 °C with 1,05 MPa (10,5 bar)
- Max. working pressure at 20 °C with water and not dangerous gas: 3,5 MPa (35 bar) for 1/2", 3/4" 2,8 MPa (28 bar) for 1", 1-1/4"
- Temperature range with liquid hydrocarbons\*: -20÷60 °C
- Max. working pressure at 20 °C with liquid hydrocarbons\*: 1,2 MPa (12 bar)

## Dimensions and Kv

PRODUCT CODE	DN	A [mm]	I [mm]	B [mm]	J [mm]	C [mm]	H [mm]	Kv
R854X023	15	64	27	54	16	63	wr.25	12,7
R854X024	20	72	30	64	20	73	wr.31	24,6
R854X025	25	83	37	72	24	73	wr.38	48,5
R854X026	32	97	42	82	29	73	wr.47	98
R854X043	15	64	27	54	16	63	wr.25	12,7
R854X044	20	72	30	64	20	73	wr.31	24,6
R854X045	25	83	37	72	24	73	wr.38	48,5

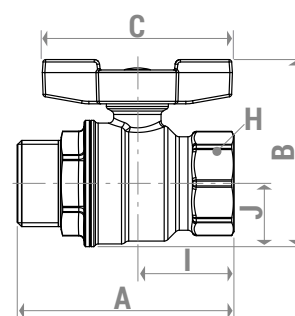

## Product specifications

### R854

Ball valve, with female-male threaded connections. Suitable for water for heating/cooling systems, not dangerous gas and liquid hydrocarbons. Valve made of UNI EN 12165 CW617N chrome plated brass. Full port. Aluminium T-handle, red or blue painted. Stem with double O-Ring. Nut with anti-corrosion coating, with guarantee seal and hologram. Min. working temperature: -20 °C with 50 % glycol solutions. Max. working temperature with dry saturated steam: 185 °C with 1,05 MPa (10,5 bar). Max. working pressure at 20 °C with water and not dangerous gas: 3,5 MPa (35 bar) for 1/2", 3/4"; 2,8 MPa (28 bar) for 1", 1-1/4". Temperature range with liquid hydrocarbons: -20÷60 °C. Max. working pressure at 20 °C with liquid hydrocarbons: 1,2 MPa (12 bar).

**⚠ Safety Warning.** Installation, commissioning and periodical maintenance of the product must be carried out by qualified operators in compliance with national regulations and/or local standards. A qualified installer must take all required measures, including use of Individual Protection Devices, for his and others' safety. An improper installation may damage people, animals or objects towards which Giacomini S.p.A. may not be held liable.

**♻ Package Disposal.** Carton boxes: paper recycling. Plastic bags and bubble wrap: plastic recycling.

**ℹ Additional information.** For more information, go to [giacomini.com](http://giacomini.com) or contact our technical assistance service. This document provides only general indications. Giacomini S.p.A. may change at any time, without notice and for technical or commercial reasons, the items included herewith. The information included in this technical sheet do not exempt the user from strictly complying with the rules and good practice standards in force.

**♻ Product Disposal.** Do not dispose of product as municipal waste at the end of its life cycle. Dispose of product at a special recycling platform managed by local authorities or at retailers providing this type of service.