

R851



Energy
Management

Ball valve for water for heating systems, full port

Datasheet
0632EN  01/2024



Ball valve, with female-female threaded connections.
Full port.

Versions and product codes

PRODUCT CODE	CONNECTIONS	FINISHING	HANDLE TYPE	HANDLE COLOR
R851X021	G 1/4"F x G 1/4"F	Chrome plated brass	T-handle	Red
R851X022	G 3/8"F x G 3/8"F	Chrome plated brass	T-handle	Red
R851X023	G 1/2"F x G 1/2"F	Chrome plated brass	T-handle	Red
R851X024	G 3/4"F x G 3/4"F	Chrome plated brass	T-handle	Red
R851X025	G 1"F x G 1"F	Chrome plated brass	T-handle	Red
R851X026	G 1-1/4"F x G 1-1/4"F	Chrome plated brass	T-handle	Red

Technical data

Main features and materials

- Suitable for water for heating/cooling systems, not dangerous gas and liquid hydrocarbons*
- Full port
- Valve made of UNI EN 12165 CW617N chrome plated brass
- Stem with double O-Ring
- Nut with anti-corrosion coating, with guarantee seal and hologram
- Aluminium T-handle, red painted

* Please consult Giacomini technical support, to check the compatibility of the product with the specific hydrocarbon.

Field of applications

- Min. working temperature: -20 °C with 50 % glycol solutions
- Max. working temperature with dry saturated steam: 185 °C with 1,05 MPa (10,5 bar)
- Max. working pressure at 20 °C with water and not dangerous gas:
3,5 MPa (35 bar) for 1/4", 3/8", 1/2", 3/4"
2,8 MPa (28 bar) for 1", 1-1/4"
- Temperature range with liquid hydrocarbons*: -20÷60 °C
- Max. working pressure at 20 °C with liquid hydrocarbons*: 1,2 MPa (12 bar)

Dimensions and Kv

PRODUCT CODE	DN	A [mm]	I [mm]	B [mm]	J [mm]	C [mm]	H [mm]	Kv
R851X021	8	43	21	35	10	40	wr.17	6,6
R851X022	10	46	23	48	13	63	wr.20	6,7
R851X023	15	53	27	54	16	63	wr.25	12,7
R851X024	20	60	30	63	20	73	wr.31	24,6
R851X025	25	74	37	72	25	73	wr.38	48,5
R851X026	32	84	42	82	29	73	wr.47	98

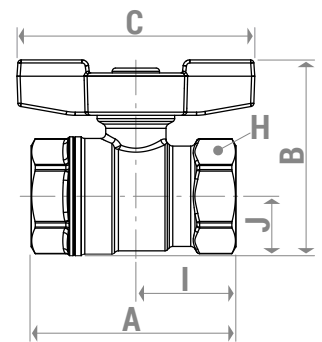

Product specifications

R851

Ball valve, with female-female threaded connections. Suitable for water for heating/cooling systems, not dangerous gas and liquid hydrocarbons. Valve made of UNI EN 12165 CW617N chrome plated brass. Full port. Aluminium T-handle, red painted. Stem with double O-Ring. Nut with anti-corrosion coating, with guarantee seal and hologram. Min. working temperature: -20 °C with 50 % glycol solutions. Max. working temperature with dry saturated steam: 185 °C with 1,05 MPa (10,5 bar). Max. working pressure at 20 °C with water and not dangerous gas: 3,5 MPa (35 bar) for 1/4", 3/8", 1/2", 3/4"; 2,8 MPa (28 bar) for 1", 1-1/4". Temperature range with liquid hydrocarbons: -20÷60 °C. Max. working pressure at 20 °C with liquid hydrocarbons: 1,2 MPa (12 bar).

⚠ Safety Warning. Installation, commissioning and periodical maintenance of the product must be carried out by qualified operators in compliance with national regulations and/or local standards. A qualified installer must take all required measures, including use of Individual Protection Devices, for his and others' safety. An improper installation may damage people, animals or objects towards which Giacomini S.p.A. may not be held liable.

♻ Package Disposal. Carton boxes: paper recycling. Plastic bags and bubble wrap: plastic recycling.

ℹ Additional information. For more information, go to giacomini.com or contact our technical assistance service. This document provides only general indications. Giacomini S.p.A. may change at any time, without notice and for technical or commercial reasons, the items included herewith. The information included in this technical sheet do not exempt the user from strictly complying with the rules and good practice standards in force.

♻ Product Disposal. Do not dispose of product as municipal waste at the end of its life cycle. Dispose of product at a special recycling platform managed by local authorities or at retailers providing this type of service.