

# R705, R706

## Manual valves for radiators



Energy  
Management

Datasheet  
0514EN 07/2025



R705



R706

Radiator valves with manual handwheel, made of chrome plated brass, with self-sealing tail piece.

### ➤ Versions and codes

PRODUCT CODE	CONNECTIONS	TYPE
R705X013	G 1/2"M x G 1/2"F	Angle
R706X013	G 1/2"M x G 1/2"F	Straight

### ➤ Technical data

#### Main features

- Temperature range: 5÷110 °C
- Max. working pressure: 16 bar

#### Materials

- Body: chrome plated brass EN 12165 CW617N
- Handwheel: ABS
- Tail piece self-sealing: EPDM

### Loss of pressure

#### R705

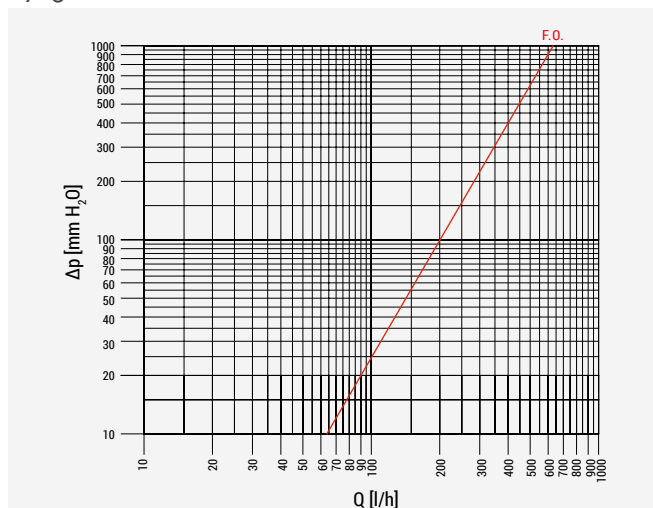

OPENING TURNS

Kv

F.O.

2,00

#### R706

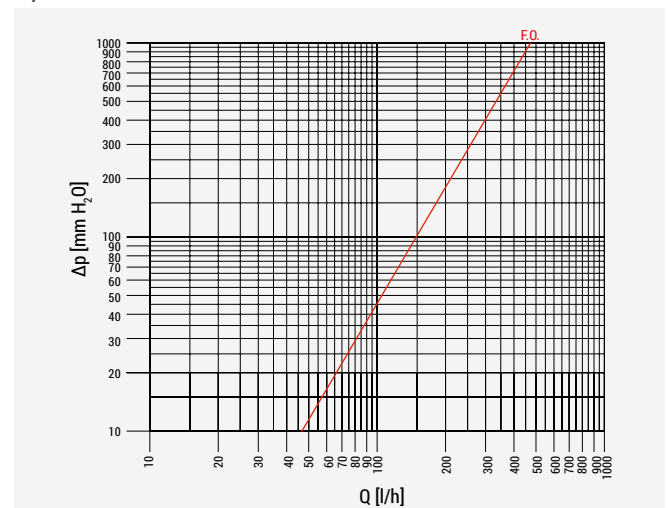

OPENING TURNS

Kv

F.O.

1,50

## ► Dimensions

### R705

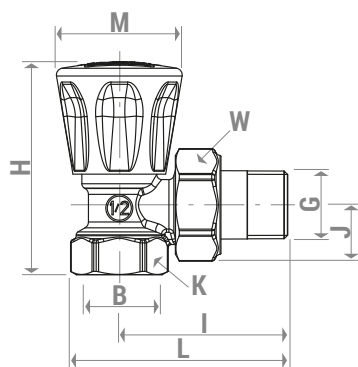

PRODUCT CODE	G x B	I [mm]	H [mm]	J [mm]	L [mm]	M [mm]	K [mm]	W [mm]
R705X013	G 1/2" M x G 1/2" F	51	63	21	70	37	26	30

### R706

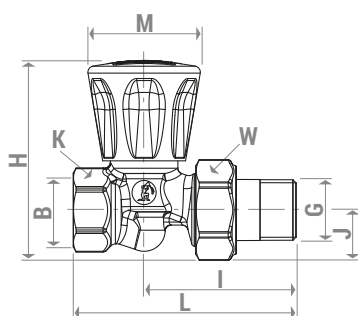

PRODUCT CODE	G x B	I [mm]	H [mm]	J [mm]	L [mm]	M [mm]	K [mm]	W [mm]
R706X013	G 1/2" M x G 1/2" F	51	66	17	75	37	25	30

## ► Product specification

### R705

Radiator angle valve with manual handwheel, threaded connections for iron pipe and selfsealing tail piece. Temperature range 5÷110 °C. Max. working pressure 16 bar. Body: chrome plated brass EN 12165 CW617N. Handwheel: ABS. Tail pieces with EPDM self-sealing gasket.

### R706

Radiator straight valve with manual handwheel, threaded connections for iron pipe and selfsealing tail piece. Temperature range 5÷110 °C. Max. working pressure 16 bar. Body: chrome plated brass EN 12165 CW617N. Handwheel: ABS. Tail pieces with EPDM self-sealing gasket.

**⚠ Safety Warning.** Installation, commissioning and periodical maintenance of the product must be carried out by qualified operators in compliance with national regulations and/or local standards. A qualified installer must take all required measures, including use of Individual Protection Devices, for his and others' safety. An improper installation may damage people, animals or objects towards which Giacomini S.p.A. may not be held liable.

**♻ Package Disposal.** Carton boxes: paper recycling. Plastic bags and bubble wrap: plastic recycling.

**ℹ Additional information.** For more information, go to [giacomini.com](http://giacomini.com) or contact our technical assistance service. This document provides only general indications. Giacomini S.p.A. may change at any time, without notice and for technical or commercial reasons, the items included herewith. The information included in this technical sheet do not exempt the user from strictly complying with the rules and good practice standards in force.

**♻ Product Disposal.** Do not dispose of product as municipal waste at the end of its life cycle. Dispose of product at a special recycling platform managed by local authorities or at retailers providing this type of service.