

# R609, R610, R611, R612



Energy  
Management

## Ball cocks for water for heating systems, standard port

Datasheet  
0929EN 05/2024



R609



R610



R611



R612

Ball cock with threaded female-male connection (R609), male-male connection (R610), female-female connection (R611), male connection-base for adaptor (R612). Standard port.

### ➤ Versions and product codes

SERIES	PRODUCT CODE	CONNECTIONS	FINISHING	HANDLE TYPE
R609	R609Y012	R 3/8" x G 3/8"F	Brass	Screwdriver bonnet
	R609Y013	R 1/2" x G 1/2"F	Brass	Screwdriver bonnet
	R609Y014	R 3/4" x G 3/4"F	Brass	Screwdriver bonnet
R610	R610Y003	G 1/2"M x G 1/2"M	Brass	Screwdriver bonnet
R611	R611Y012	G 3/8"F x G 3/8"F	Brass	Screwdriver bonnet
	R611Y013	G 1/2"F x G 1/2"F	Brass	Screwdriver bonnet
	R611Y014	G 3/4"F x G 3/4"F	Brass	Screwdriver bonnet
R612	R612Y003	R 1/2" x B.16	Brass	Screwdriver bonnet

## Technical data

### Main features and materials

- Suitable for water for heating/cooling systems and not dangerous gas
- Standard port
- Cocks made of UNI EN 12165 CW617N brass
- Stem with double O-Ring
- Brass screwdriver bonnet

**NOTE.** For opening and closing operations use a screwdriver or a 5 mm Allen wrenwr.

### Fields of applications

- Min. working temperature: -20 °C with 50 % glycol solutions
- Max. working temperature: 90 °C
- Max. working pressure at 20 °C with water and not dangerous gas: 1,0 MPa (10 bar)

## Dimensions

### R609

PRODUCT CODE	DN	A [mm]	B [mm]	C [mm]	D [mm]	E [mm]	Kv
R609Y012	10	54	29	34	22	wr.22	6,7
R609Y013	10	57	30	36	22	wr.26	6,7
R609Y014	15	67	36	43	25	wr.32	12,7

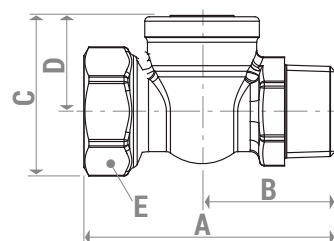

### R610

PRODUCT CODE	DN	A [mm]	B [mm]	C [mm]	D [mm]	Kv
R610Y003	10	60	30	34	22	6,7

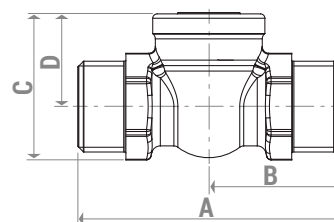

### R611

PRODUCT CODE	DN	A [mm]	B [mm]	C [mm]	D [mm]	E [mm]	Kv
R611Y012	10	50	25	33	22	wr.22	6,7
R611Y013	10	54	27	36	22	wr.26	6,7
R611Y014	15	62	31	43	25	wr.32	12,7

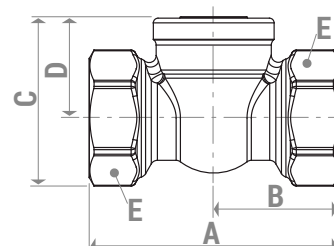

### R612

PRODUCT CODE	DN	A [mm]	B [mm]	C [mm]	D [mm]	Kv
R612Y003	10	57	30	34	22	6,7

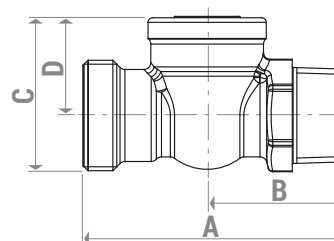

## Product specifications

### **R609**

Ball cock with female-male connections. Suitable for water for heating/cooling systems and not dangerous gas. In brass UNI EN 12165 CW617N. Standard port. Brass screwdriver bonnet. Stem with double O-Ring. Min. working temperature: -20 °C with 50 % glycol solutions. Max. working temperature: 90 °C. Max. working pressure at 20 °C with water and not dangerous gas: 1,0 MPa (10 bar).

### **R610**

Ball cock with male-male connections. Suitable for water for heating/cooling systems and not dangerous gas. In brass UNI EN 12165 CW617N. Standard port. Brass screwdriver bonnet. Stem with double O-Ring. Min. working temperature: -20 °C with 50 % glycol solutions. Max. working temperature: 90 °C. Max. working pressure at 20 °C with water and not dangerous gas: 1,0 MPa (10 bar).

### **R611**

Ball cock with female-female connections. Suitable for water for heating/cooling systems and not dangerous gas. In brass UNI EN 12165 CW617N. Standard port. Brass screwdriver bonnet. Stem with double O-Ring. Min. working temperature: -20 °C with 50 % glycol solutions. Max. working temperature: 90 °C. Max. working pressure at 20 °C with water and not dangerous gas: 1,0 MPa (10 bar).

### **R612**

Ball cock with female connection-base for adaptor. Suitable for water for heating/cooling systems and not dangerous gas. In brass UNI EN 12165 CW617N. Standard port. Brass screwdriver bonnet. Stem with double O-Ring. Min. working temperature: -20 °C with 50 % glycol solutions. Max. working temperature: 90 °C. Max. working pressure at 20 °C with water and not dangerous gas: 1,0 MPa (10 bar).

 **Safety Warning.** Installation, commissioning and periodical maintenance of the product must be carried out by qualified operators in compliance with national regulations and/or local standards. A qualified installer must take all required measures, including use of Individual Protection Devices, for his and others' safety. An improper installation may damage people, animals or objects towards which Giacomini S.p.A. may not be held liable.

 **Package Disposal.** Carton boxes: paper recycling. Plastic bags and bubble wrap: plastic recycling.

 **Additional information.** For more information, go to [giacomini.com](http://giacomini.com) or contact our technical assistance service. This document provides only general indications. Giacomini S.p.A. may change at any time, without notice and for technical or commercial reasons, the items included herewith. The information included in this technical sheet do not exempt the user from strictly complying with the rules and good practice standards in force.

 **Product Disposal.** Do not dispose of product as municipal waste at the end of its life cycle. Dispose of product at a special recycling platform managed by local authorities or at retailers providing this type of service.