

R609, R610, R611, R612



Energy
Management

Ball cocks for water for heating systems, standard port

Datasheet
0929EN  01/2024

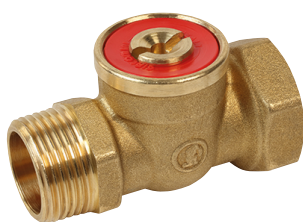

R609

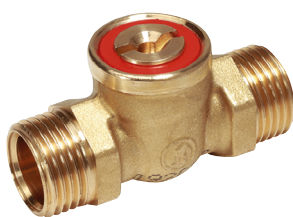

R610



R611



R612

Ball cock with threaded female-male connection (R609), male-male connection (R610), female-female connection (R611), male connection-base for adaptor (R612). Standard port.

Versions and product codes

| SERIES | PRODUCT CODE | CONNECTIONS | FINISHING | HANDLE TYPE |
|--------|--------------|-------------------|-----------|--------------------|
| R609 | R609Y012 | R 3/8" x G 3/8"F | Brass | Screwdriver bonnet |
| | R609Y013 | R 1/2" x G 1/2"F | Brass | Screwdriver bonnet |
| | R609Y014 | R 3/4" x G 3/4"F | Brass | Screwdriver bonnet |
| R610 | R610Y003 | G 1/2"M x G 1/2"M | Brass | Screwdriver bonnet |
| R611 | R611Y012 | G 3/8"F x G 3/8"F | Brass | Screwdriver bonnet |
| | R611Y013 | G 1/2"F x G 1/2"F | Brass | Screwdriver bonnet |
| | R611Y014 | G 3/4"F x G 3/4"F | Brass | Screwdriver bonnet |
| R612 | R612Y003 | R 1/2" x B.16 | Brass | Screwdriver bonnet |

Technical data

Main features and materials

- Suitable for water for heating/cooling systems and not dangerous gas
- Standard port
- Cocks made of UNI EN 12165 CW617N brass
- Stem with double O-Ring
- Brass screwdriver bonnet

NOTE. For opening and closing operations use a screwdriver or a 5 mm Allen wrenwr.

Fields of applications

- Min. working temperature: -20 °C with 50 % glycol solutions
- Max. working temperature: 90 °C
- Max. working pressure at 20 °C with water and not dangerous gas: 1,0 MPa (10 bar)

Dimensions

R609

| PRODUCT CODE | DN | A [mm] | B [mm] | C [mm] | D [mm] | E [mm] | G [mm] | Kv |
|--------------|----|--------|--------|--------|--------|--------|--------|-----|
| R609Y012 | 10 | 54 | 29 | 34 | 22 | wr.22 | 6,7 | 6,7 |
| R609Y013 | 10 | 57 | 30 | 36 | 22 | wr.26 | 6,7 | 6,7 |
| R609Y014 | 15 | 67 | 36 | 43 | 25 | wr.32 | 12,7 | 6,7 |

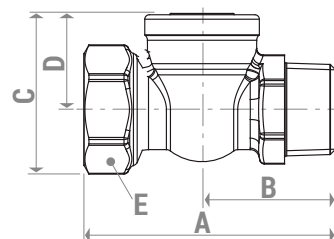

R610

| PRODUCT CODE | DN | A [mm] | B [mm] | C [mm] | D [mm] | G [mm] | Kv |
|--------------|----|--------|--------|--------|--------|--------|-----|
| R610Y003 | 10 | 60 | 30 | 34 | 22 | 6,7 | 6,7 |

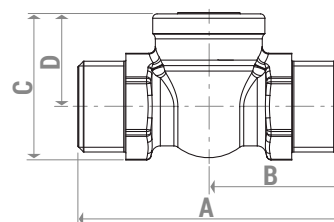

R611

| PRODUCT CODE | DN | A [mm] | B [mm] | C [mm] | D [mm] | E [mm] | G [mm] | Kv |
|--------------|----|--------|--------|--------|--------|--------|--------|-----|
| R611Y012 | 10 | 49 | 24,5 | 33 | 22 | wr.22 | 6,7 | 6,7 |
| R611Y013 | 10 | 53 | 26,5 | 36 | 22 | wr.26 | 6,7 | 6,7 |
| R611Y014 | 15 | 61 | 30,5 | 43 | 25 | wr.32 | 12,7 | 6,7 |

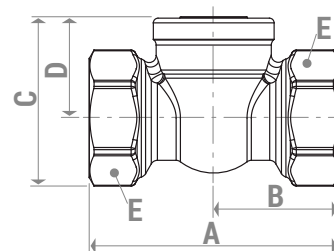

R612

| PRODUCT CODE | DN | A [mm] | B [mm] | C [mm] | D [mm] | G [mm] | Kv |
|--------------|----|--------|--------|--------|--------|--------|-----|
| R612Y003 | 10 | 57 | 30 | 34 | 22 | 6,7 | 6,7 |

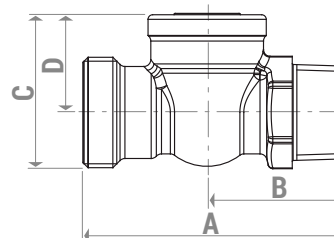

➤ Product specifications

R609

Ball cock with female-male connections. Suitable for water for heating/cooling systems and not dangerous gas. In brass UNI EN 12165 CW617N. Standard port. Brass screwdriver bonnet. Stem with double O-Ring. Min. working temperature: -20 °C with 50 % glycol solutions. Max. working temperature: 90 °C. Max. working pressure at 20 °C with water and not dangerous gas: 1,0 MPa (10 bar).

R610

Ball cock with male-male connections. Suitable for water for heating/cooling systems and not dangerous gas. In brass UNI EN 12165 CW617N. Standard port. Brass screwdriver bonnet. Stem with double O-Ring. Min. working temperature: -20 °C with 50 % glycol solutions. Max. working temperature: 90 °C. Max. working pressure at 20 °C with water and not dangerous gas: 1,0 MPa (10 bar).

R611

Ball cock with female-female connections. Suitable for water for heating/cooling systems and not dangerous gas. In brass UNI EN 12165 CW617N. Standard port. Brass screwdriver bonnet. Stem with double O-Ring. Min. working temperature: -20 °C with 50 % glycol solutions. Max. working temperature: 90 °C. Max. working pressure at 20 °C with water and not dangerous gas: 1,0 MPa (10 bar).

R612

Ball cock with female connection-base for adaptor. Suitable for water for heating/cooling systems and not dangerous gas. In brass UNI EN 12165 CW617N. Standard port. Brass screwdriver bonnet. Stem with double O-Ring. Min. working temperature: -20 °C with 50 % glycol solutions. Max. working temperature: 90 °C. Max. working pressure at 20 °C with water and not dangerous gas: 1,0 MPa (10 bar).

⚠ Safety Warning. Installation, commissioning and periodical maintenance of the product must be carried out by qualified operators in compliance with national regulations and/or local standards. A qualified installer must take all required measures, including use of Individual Protection Devices, for his and others' safety. An improper installation may damage people, animals or objects towards which Giacomini S.p.A. may not be held liable.

♻ Package Disposal. Carton boxes: paper recycling. Plastic bags and bubble wrap: plastic recycling.

ℹ Additional information. For more information, go to giacomini.com or contact our technical assistance service. This document provides only general indications. Giacomini S.p.A. may change at any time, without notice and for technical or commercial reasons, the items included herewith. The information included in this technical sheet do not exempt the user from strictly complying with the rules and good practice standards in force.

♻ Product Disposal. Do not dispose of product as municipal waste at the end of its life cycle. Dispose of product at a special recycling platform managed by local authorities or at retailers providing this type of service.