

R258DL



Energy
Management

Datasheet
1145EN 03/2024

Ball valve for water for heating systems, standard port



Ball valve, with sweat connections for copper pipes.
Standard port.

⚠ WARNING. The valve is suitable for connecting with metal pipes according to the process of soldering. This procedure does not damage the internal seals.

➤ Versions and product codes

PRODUCT CODE	CONNECTIONS	FINISHING	HANDLE TYPE	HANDLE COLOR
R258Y002	Ø 15 x Ø 15	Brass	Lever	Red
R258Y004	Ø 18 x Ø 18	Brass	Lever	Red
R258Y005	Ø 22 x Ø 22	Brass	Lever	Red
R258Y006	Ø 28 x Ø 28	Brass	Lever	Red
R258Y007	Ø 35 x Ø 35	Brass	Lever	Red

Technical data

Main features and materials

- Suitable for water for heating/cooling systems, not dangerous gas and liquid hydrocarbons*
- Standard port
- Valve made of UNI EN 12165 CW617N brass
- Stem with double O-Ring
- Nut with anti-corrosion coating, with guarantee seal and hologram
- Steel lever handle with anti-corrosion treatment and red PVC coating

* Please consult Giacomini technical support, to check the compatibility of the product with the specific hydrocarbon.

Field of applications

- Min. working temperature: -20 °C with 50 % glycol solutions
- Max. working temperature with dry saturated steam: 185 °C with 1,05 MPa (10,5 bar)
- Max. working pressure at 20 °C with water and not dangerous gas: 4,2 MPa (42 bar) for Ø 15, Ø 18, Ø 22
3,5 MPa (35 bar) for Ø 28, Ø 35
- Temperature range with liquid hydrocarbons*: -20÷60 °C
- Max. working pressure at 20 °C with liquid hydrocarbons*: 1,2 MPa (12 bar)

Dimensions and Kv

PRODUCT CODE	DN	A [mm]	I [mm]	B [mm]	J [mm]	C [mm]	D [mm]	Kv
R258Y002	14	56	28	49	15	77	13	10,2
R258Y004	15	65	32	51	16	77	14	12,7
R258Y005	18	79	40	64	18	94	19	18,5
R258Y006	22	96	48	73	23	94	23	36,3
R258Y007	28	107	53	82	28	94	24	73,5

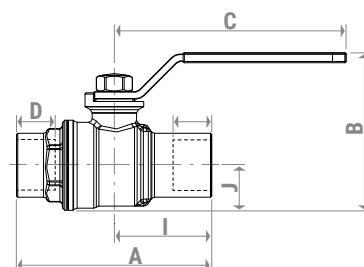

Product specifications

R258DL

Ball valve, with Sweat connections for copper pipes. Suitable for water for heating/cooling systems, not dangerous gas and liquid hydrocarbons. Valve made of UNI EN 12165 CW617N brass. Full port. Steel lever handle with anti-corrosion treatment and red PVC coating. Stem with double O-Ring. Nut with anti-corrosion coating, with guarantee seal and hologram. Min. working temperature: -20 °C with 50 % glycol solutions. Max. working temperature with dry saturated steam: 185 °C with 1,05 MPa (10,5 bar). Max. working pressure at 20 °C with water and not dangerous gas: 4,2 MPa (42 bar) for Ø 15, Ø 18, Ø 22; 3,5 MPa (35 bar) for Ø 28, Ø 35. Temperature range with liquid hydrocarbons: -20÷60 °C. Max. working pressure at 20 °C with liquid hydrocarbons: 1,2 MPa (12 bar).

⚠ Safety Warning. Installation, commissioning and periodical maintenance of the product must be carried out by qualified operators in compliance with national regulations and/or local standards. A qualified installer must take all required measures, including use of Individual Protection Devices, for his and others' safety. An improper installation may damage people, animals or objects towards which Giacomini S.p.A. may not be held liable.

♻ Package Disposal. Carton boxes: paper recycling. Plastic bags and bubble wrap: plastic recycling.

ℹ Additional information. For more information, go to giacomini.com or contact our technical assistance service. This document provides only general indications. Giacomini S.p.A. may change at any time, without notice and for technical or commercial reasons, the items included herewith. The information included in this technical sheet do not exempt the user from strictly complying with the rules and good practice standards in force.

♻ Product Disposal. Do not dispose of product as municipal waste at the end of its life cycle. Dispose of product at a special recycling platform managed by local authorities or at retailers providing this type of service.



GIACOMINI
WATER E-MOTION



Giacomini S.p.A.
Via per Alzo 39, 28017 San Maurizio d'Opaglio (NO) Italia
consulenza.prodotti@giacomini.com
☎ +39 0322 923372 - giacomini.com