

ACTUATOR FOR ZONE VALVES

0747EN January 2015

**ACTUATOR K270Y101 AND K270Y102
FOR ZONE VALVES R276, R277, R278, R279
AND DIVERTING VALVES R279D**



GIACOMINI
WATER E-MOTION



**K270Y101
K270Y102**

Description

The K270Y101/K270Y102 actuator is used to control the zone valves R276, R277, R278, R279 or the diverting valves R279D in heating and cooling systems.

Versions and product codes

| Product code | Power supply | For use with zone valves and diverting valves |
|--------------|---------------|---|
| K270Y101 | 230 V - 50 Hz | R276, R277, R278, R279 R279D |
| K270Y102 | 24 V - 50 Hz | |

Technical data

- Type of command: ON/OFF
- Rotation angle: 90°
- Opening time: 40 s
- Maximum torque: 10 Nm
- Electricity absorption: 5,5 W
- Auxiliary microswitch for end stop (contact flow rate): 6 (1) A
- Protection class: II
- Insulation class: IP54
- Ambient operating temperature range: -5÷55 °C
- Ambient humidity range: 95 %
- Storage temperature range: -20÷70 °C

Operation

Operation with zone valves R276, R277

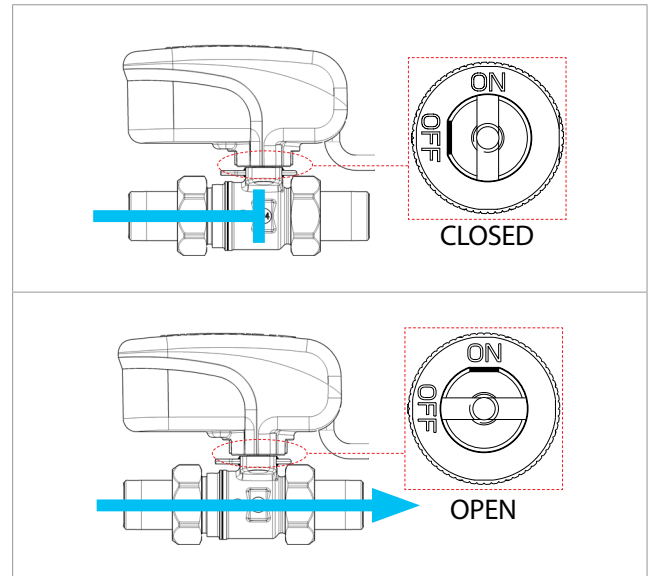

Operation with zone valves R278, R279

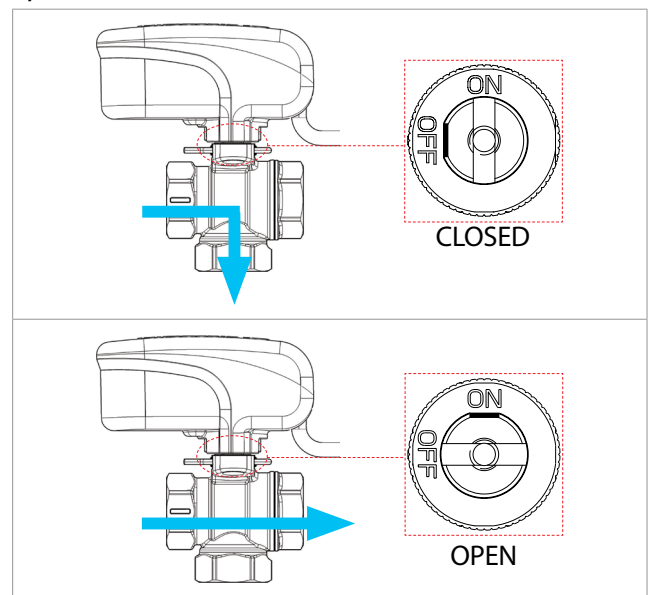

Operation with diverting valves R279D

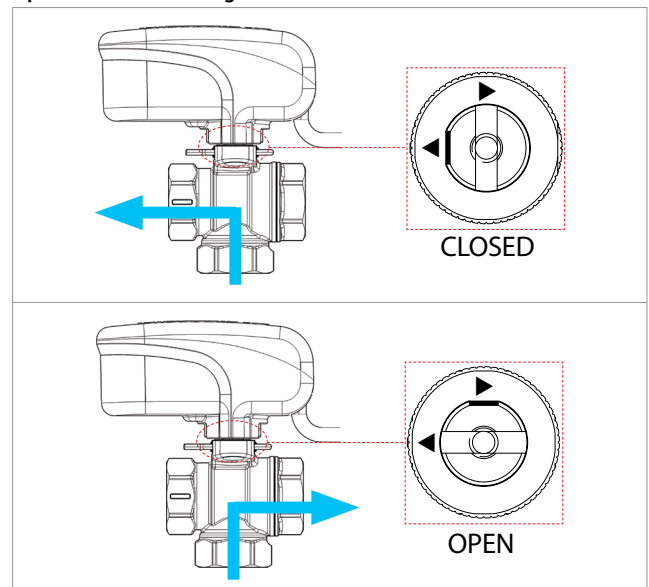

ACTUATOR FOR ZONE VALVES

0747EN January 2015

ACTUATOR K270Y101 AND K270Y102 FOR ZONE VALVES R276, R277, R278, R279 AND DIVERTING VALVES R279D



GIACOMINI
WATER E-MOTION



Installation

The K270 actuator must be assembled horizontally or vertically, with the cover facing upwards. It must be installed in a dry, protected place that can easily be accessed for any necessary maintenance work.

Do not cover with insulating materials.

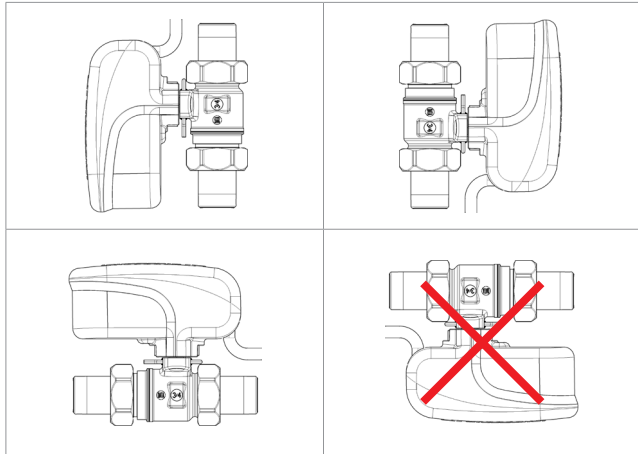

Dimensions

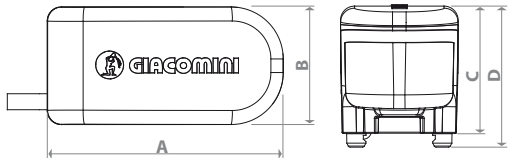
|  | | | | |
|--|--------|--------|--------|--------|
| Codes | A [mm] | B [mm] | C [mm] | D [mm] |
| K270Y101 | 118 | 59 | 64 | 71 |
| K270Y102 | | | | |

Reference Standards

- EC mark
- Directive EMC 2014/30/EC
- Low Voltage Directive 2014/35/EC

Product specifications

K270Y101

Rotary actuator for controlling the zone valves R276, R277, R278, R279 or the diverting valves R279D in heating and cooling systems. Power supply 230 V - 50 Hz. Type of command: ON/OFF. Opening time: 40 s. Maximum torque: 10 Nm. Electricity absorption: 5,5 W. Auxiliary microswitch for end stop (contact flow rate): 6 (1) A. Protection class: II. Insulation class: IP54. Ambient operating temperature range: -5÷55 °C. Ambient humidity range: 95%. Storage temperature range: -20÷70 °C. EC mark. Complying with Directive EMC 2014/30/EC and Low Voltage Directive 2014/35/EC.

K270Y102

Rotary actuator for controlling the zone valves R276, R277, R278, R279 or the diverting valves R279D in heating and cooling systems. Power supply 24 V - 50 Hz. Type of command: ON/OFF. Opening time: 40 s. Maximum torque: 10 Nm. Electricity absorption: 5,5 W. Auxiliary microswitch for end stop (contact flow rate): 6 (1) A. Protection class: II. Insulation class: IP54. Ambient operating temperature range: -5÷55 °C. Ambient humidity range: 95%. Storage temperature range: -20÷70 °C. EC mark. Complying with Directive EMC 2014/30/EC and Low Voltage Directive 2014/35/EC.

Electric connections



Warning.

Make sure the power supply voltage is disconnected while the connections are being carried out.



Warning.

Make and check the electrical connections before powering the system. Short circuits or incorrectly connected cables could cause permanent damage to the electrical components of the actuator.

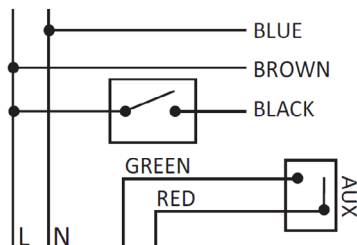

Legend

| | |
|-----------|-------------------|
| Blue | Neutral |
| Brown | Phase |
| Black | Command |
| Green/Red | Auxiliary contact |

Description of the commands

| Action | Input | Auxiliary contact |
|---------|----------------------|-------------------|
| Closure | Blue / Brown | Open |
| Opening | Blue / Brown / Black | Closed |

Additional information

For additional information please check the website www.giacomini.com or contact the technical service: ☎ +39 0322 923372 ☎ +39 0322 923255 ✉ consulenza.prodotti@giacomini.com
This pamphlet is merely for information purposes. Giacomini S.p.A. retains the right to make modifications for technical or commercial reasons, without prior notice, to the items described in this pamphlet. The information described in this technical pamphlet does not exempt the user from following carefully the existing regulations and norms on good workmanship.
Giacomini S.p.A. Via per Alzo, 39 - 28017 San Maurizio d'Opaglio (NO) Italy