

A730



Fire
Protection

Ball valve for fire protection applications with water, full port

Datasheet
1173EN 07/2025



Ball valve, with female-female threaded connections.
Full Port.
In compliance with UL 258:2025 and FM Class 1140 for fire protection applications with water.
Made of DZR brass (dezincification resistant).

➤ Versions and codes

PRODUCT CODE	CONNECTIONS	FINISHING	HANDLE TYPE	HANDLE COLOR
A730X023	G 1/2"F x G 1/2"F	Nickel plated brass	Large lever	Red
A730X024	G 3/4"F x G 3/4"F	Nickel plated brass	Large lever	Red
A730X025	G 1"F x G 1"F	Nickel plated brass	Large lever	Red
A730X026	G 1-1/4"F x G 1-1/4"F	Nickel plated brass	Large lever	Red
A730X027	G 1-1/2"F x G 1-1/2"F	Nickel plated brass	Large lever	Red
A730X028	G 2"F x G 2"F	Nickel plated brass	Large lever	Red
A730UY003	1/2"NPT-F x 1/2"NPT-F	Brass	Large lever	Red
A730UY004	3/4"NPT-F x 3/4"NPT-F	Brass	Large lever	Red
A730UY005	1"NPT-F x 1"NPT-F	Brass	Large lever	Red
A730UY006	1-1/4"NPT-F x 1-1/4"NPT-F	Brass	Large lever	Red
A730UY007	1-1/2"NPT-F x 1-1/2"NPT-F	Brass	Large lever	Red
A730UY008	2"NPT-F x 2"NPT-F	Brass	Large lever	Red

Technical data

Main features and materials

- Suitable for fire protection applications with water
- Full port
- Valve made of DZR UNI EN 12165 CW602N nickel plated or brass finishing
- Ball made of DZR UNI EN 12165 CW602N chrome plated brass
- Stem with double O-Ring
- Nut with anti-corrosion coating, with guarantee seal and hologram
- Steel lever handle with anti-corrosion treatment and red PVC coating

Approvals

- UL 258:2025
- FM Class 1140

Field of applications

- Min. working temperature: 4 °C (areas exposed to low temperature shall be protected against freezing - NFPA13)
- Max. working pressure at 20 °C with water:
42 bar for 1/2", 3/4", 1"
21 bar for 1-1/4", 1-1/2"
12 bar for 2"

Dimensions and Kv

PRODUCT CODE	DN	A [mm]	I [mm]	B [mm]	J [mm]	C [mm]	H [mm]	Kv
A730X023	15	57	28	53	16	77	wr.25	13,3
A730X024	20	62	31	70	21	95	wr.32	25,8
A730X025	25	76	38	78	25	95	wr.39	50,9
A730X026	32	86	43	88	30	95	wr.47	103
A730X027	40	97	48	109	37	137	wr.54	147
A730X028	50	111	55	125	46	137	wr.67	222
A730UY003	15	57	28	53	16	77	wr.25	13,3
A730UY004	20	62	31	70	21	95	wr.32	25,8
A730UY005	25	76	38	78	25	95	wr.39	50,9
A730UY006	32	86	43	88	30	95	wr.47	103
A730UY007	40	97	48	109	37	137	wr.54	147
A730UY008	50	111	55	125	46	137	wr.67	222

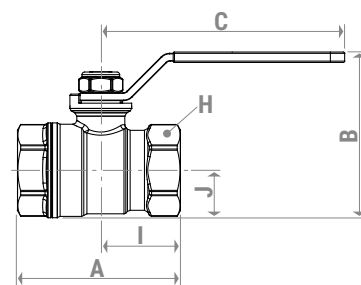

➤ Product specifications

A730

Ball valve, with female-female threaded connections (ISO 228 or NPT). In compliance with UL 258:2025 and FM Class 1140, suitable for fire protection applications with water. Made of DZR UNI EN 12165 CW602N nickel plated or brass finishing. Ball made of DZR UNI EN 12165 CW602N chrome plated brass. Full port. Steel lever handle with anti-corrosion treatment and red PVC coating. Stem with double O-Ring. Nut with anti-corrosion coating, with guarantee seal and hologram. Min. working temperature: 4 °C (areas exposed to low temperature shall be protected against freezing - NFPA13). Max. working pressure at 20 °C with water: 42 bar for 1/2", 3/4", 1"; 21 bar for 1-1/4", 1-1/2"; 12 bar for 2".

⚠ Safety Warning. Installation, commissioning and periodical maintenance of the product must be carried out by qualified operators in compliance with national regulations and/or local standards. A qualified installer must take all required measures, including use of Individual Protection Devices, for his and others' safety. An improper installation may damage people, animals or objects towards which Giacomini S.p.A. may not be held liable.

♻ Package Disposal. Carton boxes: paper recycling. Plastic bags and bubble wrap: plastic recycling.

ℹ Additional information. For more information, go to giacomini.com or contact our technical assistance service. This document provides only general indications. Giacomini S.p.A. may change at any time, without notice and for technical or commercial reasons, the items included herewith. The information included in this technical sheet do not exempt the user from strictly complying with the rules and good practice standards in force.

♻ Product Disposal. Do not dispose of product as municipal waste at the end of its life cycle. Dispose of product at a special recycling platform managed by local authorities or at retailers providing this type of service.